

NOTICE!!

These documents have been scanned!

Do not place un-scanned documents beneath this notice!

Do not remove this notice from this file!

GPO Jacket No. 560-102
Print Order 61540
Rise Business Services, LLC
Job=AZ15 5/23/2019



Box Number= AZ15087



Claim Begin-End: AMC386581-AMC386581

1 Initial Receipt



AZ15087-15

AMC385403-AMC386592

United States Department of the Interior
Bureau of Land Management
 BUSINESS & SUPPORT SVCS DIV
 ONE N CENTRAL AVE SUITE 800
 PHOENIX, AZ 85004 -4427
 Phone: (602) 417-9200

Receipt

No: 1590094

Transaction #: 1642329	
Date of Transaction: 10/23/2007	
CUSTOMER:	FRANKLIN BURNS 5828 N SCOTTDALE RD SCOTTSDALE, AZ 85253

ENTERED INTO COMPUTER
11/01/07 *egg*

LINE #	QTY	DESCRIPTION	REMARKS	UNIT PRICE	TOTAL
1	1.00	LOCATABLE MINERALS / MINING CLAIMS- NEW, UNADJUD, ONE OR MORE AUTH NOS / NEW MINING CLAIM LOCATION FEE \$30 (1993) CASES: AMC386581/\$30.00		- n/a -	30.00
2	1.00	LOCATABLE MINERALS / MINING CLAIMS- NEW, UNADJUD, ONE OR MORE AUTH NOS / NEW MINING CLM MAINT FEE \$125 (1993) CASES: AMC386581/\$125.00		- n/a -	125.00
3	1.00	LOCATABLE MINERALS / MINING CLAIMS- NEW, UNADJUD, ONE OR MORE AUTH NOS / NEW MINING CLAIM PROCESSING FEE \$15 (1930) CASES: AMC386581/\$15.00		- n/a -	15.00
TOTAL:					\$170.00

PAYMENT INFORMATION			
NOTE: Items will appear on credit card statement as "Bureau of Land Management".			
1	AMOUNT:	\$170.00	POSTMARKED: N/A
	TYPE:	CREDIT CARD	RECEIVED: 10/23/2007
	NAME:	BURNS, FRANKLIN 5828 N SCOTTDALE RD SCOTTSDALE AZ 85253	
	CARD NO:	XXXXXXXXXXXX2910	AUTH CODE: 536393
	NAME ON CARD:	FRANKLIN L BURNS	
	EXPIRES:	04/30/2009	
	SIGNATURE:		

REMARKS

This receipt was generated by the automated BLM Collections and Billing System and is a paper representation of a portion of the official electronic record contained therein.

NOTICE!!

These documents have been scanned!

Do not place un-scanned documents beneath this notice!

Do not remove this notice from this file!

GPO Jacket No. 560-102
Print Order 61540
Rise Business Services, LLC
Job=AZ15 5/23/2019



Box Number= AZ15087



Claim Begin-End: AMC386581-AMC386581

2 Correspondence



AZ15087-15

AMC385403-AMC386592

**NO
DOCUMENTS
FOUND**

NO DOCUMENTS FOUND
NO DOCUMENTS FOUND

NOTICE!!

These documents have been scanned!

Do not place un-scanned documents beneath this notice!

Do not remove this notice from this file!

GPO Jacket No. 560-102
Print Order 61540
Rise Business Services, LLC
Job=AZ15 5/23/2019



Box Number= AZ15087



Claim Begin-End: AMC386581-AMC386581

3 Transfers



AZ15087-15

AMC385403-AMC386592

**NO
DOCUMENTS
FOUND**

NO DOCUMENTS FOUND
NO DOCUMENTS FOUND

NOTICE!!

These documents have been scanned!

Do not place un-scanned documents beneath this notice!

Do not remove this notice from this file!

GPO Jacket No. 560-102
Print Order 61540
Rise Business Services, LLC
Job=AZ15 5/23/2019



Box Number= AZ15087



Claim Begin-End: AMC386581-AMC386581

4 Annual Filings



AZ15087-15

AMC385403-AMC386592

UNITED STATES
DEPARTMENT OF THE INTERIOR
BUREAU OF LAND MANAGEMENT

MAINTENANCE FEE WAIVER CERTIFICATION

113

318630

386581

FORM APPROVED
OMB NO. 1004-0114
Expires: January 31, 2020

SEE INSTRUCTIONS ON PAGE 2

1. This small miner waiver is filed for the assessment year beginning on September 1, 2019 and ending on September 1, 2020.
2. The undersigned and all related parties owned ten or fewer mining claims, mill, or tunnel sites located and maintained on Federal lands in the United States of America on September 1, 2019.
3. The undersigned have performed the assessment work required by law for each mining claim listed prior to filing this waiver and understand that by filing this form, the undersigned must file an affidavit of assessment work with the Bureau of Land Management (BLM) by the December 30th following the filing of this waiver.
4. The undersigned understand that if the assessment work obligation has not yet come due under 30 U.S.C. 28 (for those claims in their first assessment year only), a notice of intent to hold reciting this condition must be recorded by the December 30th following the filing of this waiver.
5. The undersigned understand that mill and tunnel sites may also be listed on this waiver and be waived from payment of the maintenance fee, and that a notice of intent to hold for these sites is required to be filed with the BLM by the December 30th following the filing of this waiver.
6. The undersigned understand and acknowledge that pursuant to 43 U.S.C. 1212 and 18 U.S.C. 1001, the filing or recording of a false, fictitious, or fraudulent document with the BLM may result in a fine of up to \$250,000, a prison term not to exceed five years, or both.
7. The mining claims, mill or tunnel sites for which this waiver from payment of the maintenance fees is requested are:

CLAIM OR SITE NAME	BLM RECORDATION SERIAL NUMBER
1. BLAND MINE # 22 ✓	AMC # 318631
2. DEBORAH SUE MINE	AMC # 386581
3.	
4.	
5.	
6.	
7.	
8.	
9.	
10.	

The owner(s) (claimants) of the above mining claims and sites are:

FRANKLIN BURNS

(Owner's Name - Please Print)

21626 N. 23rd AVE. # 304A

(Owner's Mailing Address)

Franklin Burns
(Owner's Signature)

PHX
(City)

AZ
(State)

85027
(Zip Code)

(Owner's Name - Please Print)

(Owner's Signature)

(Owner's Mailing Address)

(City)

(State)

(Zip Code)

(Owner's Name - Please Print)

(Owner's Signature)

(Owner's Mailing Address)

PHOENIX, ARIZONA

(City)

(State)

(Zip Code)

(Owner's Name - Please Print)

(Owner's Signature)

(Owner's Mailing Address)

2019 AUG - 8 P 1:03

RECEIVED
STATE OFFICE

(City)

(State)

(Zip Code)

(Continued on page 2)

ENTERED
SEP 09 2019

New

(Owner's Name - Please Print)	(Owner's Signature)		
(Owner's Mailing Address)	(City)	(State)	(Zip Code)
(Owner's Name - Please Print)	(Owner's Signature)		
(Owner's Mailing Address)	(City)	(State)	(Zip Code)
(Owner's Name - Please Print)	(Owner's Signature)		
(Owner's Mailing Address)	(City)	(State)	(Zip Code)
(Owner's Name - Please Print)	(Owner's Signature)		
(Owner's Mailing Address)	(City)	(State)	(Zip Code)

18 U.S.C. 1001 and 43 U.S.C. 1212 make it a crime for any person knowingly and willfully to make to any department or agency of the United States any false, fictitious or fraudulent statements or representations as to any matter within its jurisdiction.

INSTRUCTIONS

1. This certification is made under the provisions of 43 U.S.C. § 1744 and 30 U.S.C. §28-28k and the regulations thereunder (43 CFR Part 3830).
2. The claimant(s) must fill in the dates in paragraph 1 for the beginning and ending of the assessment year for which this waiver is sought.
3. The claimant(s) must fill in the date in paragraph 2 for the beginning of the assessment year for which this waiver is sought.
4. All claim and site names and BLM serial numbers must be listed for the mining claims, mill sites, and tunnel sites for which the waiver is sought.
5. All owners of the mining claims, mill sites, and tunnel sites and their addresses must be given.
6. This waiver form must be signed by all the claimants or their designated agent, in original form. If an agent is designated, a notarized designation of agent, signed by all of the claimants with proper address given, must be submitted with this waiver.
7. This form must be filed no later than September 1st for the upcoming assessment year in the BLM State Office where the mining claims or sites are recorded, or the waiver cannot be granted by the BLM. (Example: To obtain a waiver for the assessment year 2012, which begins on September 1, 2011, you must qualify for and file for a waiver no later than September 1, 2011, in the proper BLM State Office.)
8. For all mining claims which require assessment work, you must record an affidavit of labor on or before the December 30th immediately following the filing of this waiver. For all other mining claims or sites waived, you must record a notice of intent to hold on or before the December 30th immediately following the filing of this waiver.
9. Mill and tunnel sites may also be listed on this waiver and be waived from payment of the maintenance fee. A notice of intent to hold for these sites is required to be filed by the December 30th following the filing of this waiver.

PHOENIX, ARIZONA

FOR OFFICIAL USE ONLY

2019 AUG - 8 P 1:04

RECEIVED STATE OFFICE

UNITED STATES
DEPARTMENT OF THE INTERIOR
BUREAU OF LAND MANAGEMENT

FORM APPROVED
OMB NO.: 1004-0114
Expires: January 31, 2020

AFFIDAVIT OF ANNUAL ASSESSMENT WORK

318630

386581

WHEN RECORDED, MAIL DOCUMENT TO:

NAME: FRANK BURNS

ADDRESS: 21626 N. 23rd AVE. # 304A

CITY, STATE, ZIP: PHOENIX, AZ 85027

FOR COUNTY RECORDER'S USE

No. of Claims _____

x \$10/claim

Total due BLM \$ _____

TO ALL WHOM IT MAY CONCERN:

1. The undersigned certifies that at least \$100 per claim was expended for development, labor and improvements, or equivalent value added, as the annual assessment work for the assessment year ending September 1, 2018 for the following contiguous unpatented mining claim(s), located in the County of YAVAPAI, in the State of ARIZONA.

BLM Serial No.	Name of Claim	Tp Rg Sec Mer				County Recordation Book and Page No.	Co. Recording Date
		Example: 13N 5E 14 MDM					
318631	BLAND MINE # 22	10N	2E	29	MDM		

RECEIVED
 ARIZONA STATE OFFICE
 2018 JUL 31 P 1:27
 PHOENIX, ARIZONA

(Continued on page 2)

ENTERED
 AUG 01 2018
 BY: Ram

2. Type of labor and improvements (specify what was done and give the total value for that labor and improvement to show at least \$100 for each claim). If a geological, geochemical, or geophysical survey was performed, as per 30 U.S.C. 28-1, reference the title of the report of survey, give cost and date of the survey and report, and indicate it was filed with the County Recorder:

Description of Work Performed	Value of Work Performed	Date Work Was Performed
ROAD WORK BY HAND, REPAIR FENCING & WARNING SIGNAGE	\$100.00	2018
SORT & CRUSH HAULED ORE	\$250.00	2018
CONTINUE INSTALL OF STEEL COVER OVER MINE SHAFT	\$1,000.00	2018

3. Name and mailing address of each person who performed the labor and improvements:

Name (please print)
FRANKLIN BURNS

Current Mailing Address (please print)
21626 N. 23rd AVE. # 304A, PHX, ARIZONA 8

4. Name and mailing address of each person who holds and claims the subject mining claim(s) for the valuable minerals contained therein. Be sure to indicate if there is a change of address:

Name (please print)
FRANKLIN BURNS

Current Mailing Address (please print)
21626 N. 23rd AVE. # 304A, PHX, AZ 85027

RECEIVED
 JUL 31 PM 1:27
 PHOENIX, ARIZONA

5. The undersigned testifies that on the date of JULY 31st, 2018, all monuments required by law were erected upon the subject claim(s), and all notices required by law were posted on the subject claim(s) or copies thereof were in place, and at said date, each corner monument bore or contained

markings sufficient to appropriately designate the corner of the claim to which it pertains and the name of the claim(s).

I hereby certify under penalty of perjury under the laws of the State of ARIZONA that the foregoing statements are true and correct:

[Signature] Date: 7/31/18
(Signature of person responsible for above statement)

Title 18 U.S.C. 1001 and 43 U.S.C. 1212 make it a crime for any person knowingly and willfully to make to any department or agency of the United States any false, fictitious or fraudulent statements or representations as to any matter within its jurisdiction.

Notary Block

SUBSCRIBED AND SWORN TO before me, this 31st day of July 2018

By: Franklin L Burns
(Signature of Affiant)

Title: Notary Public - Maricopa County, Arizona

My Commission Expires: January 22, 2022



INSTRUCTIONS

1. This is an optional form that may be used to satisfy the requirements for the Bureau of Land Management (BLM) under the provisions of 43 U.S.C. §1744 and 30 U.S.C. §28-28d and the regulations thereunder (43 CFR part 3835). Since local and State laws may vary, you should contact your local and State agencies where the claims are located to ensure all applicable laws and requirements are satisfied.
2. The claimant(s) must fill in the date in paragraph 1 for the applicable assessment year and the county and state where the claims are located.
3. All claim names, BLM serial numbers, legal descriptions, and original county recording information must be listed for the claims pertaining to this assessment notice.
4. The claimant(s) must complete paragraph 2 listing all labor or improvements which was performed on or did benefit the subject mining claims. The value and date of the labor or improvements must also be listed. The total amount of labor or improvements can be listed, but the total expenditure must equal at least \$100 for each claim.
5. The names and current mailing addresses of the person(s) performing the labor shall be listed in paragraph 3.
6. The name and current mailing address of each owner (claimant) of the claims shall be listed in paragraph 4. The mailing address shall be the owner's address and not the address of an agent or anyone representing the claimant. Be sure to note if there has been a change of address.
7. Paragraph 5 shall be completed to show the date it was verified that all monuments required by law were properly erected, all notices were posted, and that corners were appropriately designated for all claims listed.
8. An exact legible reproduction or duplicate (other than microfilm or other electronic media) of this affidavit or another type of affidavit of assessment work that you file or will file in the county where each claim is located, must be filed with the BLM on or before December 30 of the calendar year in which the assessment year ends. For mill or tunnel sites, a separate notice of intent to hold must be filed with the BLM on or before December 30. Requirements for filing a notice of intent to hold can be found at 43 CFR 3835.33.
9. A processing fee of \$10 for each claim listed must be remitted to the BLM along with this or any other affidavit of assessment work.

UNITED STATES
DEPARTMENT OF THE INTERIOR
BUREAU OF LAND MANAGEMENT

FORM APPROVED
OMB NO.: 1004-0114
Expires: January 31, 2020

AFFIDAVIT OF ANNUAL ASSESSMENT WORK

WHEN RECORDED, MAIL DOCUMENT TO:

NAME: FRANK BURNS

ADDRESS: 21626 N. 23rd AVE. # 304A

CITY, STATE, ZIP: PHOENIX, AZ 85027

FOR COUNTY RECORDER'S USE

No. of Claims _____

x \$10/claim

Total due BLM \$ _____

TO ALL WHOM IT MAY CONCERN:

1. The undersigned certifies that at least \$100 per claim was expended for development, labor and improvements, or equivalent value added, as the annual assessment work for the assessment year ending September 1, 2018 for the following contiguous unpatented mining claim(s), located in the County of YAVAPAI, in the State of ARIZONA.

BLM Serial No.	Name of Claim	Tp	Rg	Sec	Mer	County Recordation Book and Page No.	Co. Recording Date
		Example: 13N 5E 14 MDM					
386581	DEBORAH SUE MINE	10N	2E	33	MDM		

RECEIVED
 STATE OFFICE
 2018 JUL 31 P 1:27
 PHOENIX, ARIZONA

2. Type of labor and improvements (specify what was done and give the total value for that labor and improvement to show at least \$100 for each claim). If a geological, geochemical, or geophysical survey was performed, as per 30 U.S.C. 28-1, reference the title of the report of survey, give cost and date of the survey and report, and indicate it was filed with the County Recorder:

Description of Work Performed	Value of Work Performed	Date Work Was Performed
ROAD WORK BY HAND, REPAIR FENCING & WARNING SIGNAGE	\$100.00	2018
SORT & HAUL ORE TO BLAND MINE # 22	\$250.00	2018

3. Name and mailing address of each person who performed the labor and improvements:

Name (please print)
FRANKLIN BURNS

Current Mailing Address (please print)
21626 N. 23rd AVE. # 304A, PHX, AZ 85027

4. Name and mailing address of each person who holds and claims the subject mining claim(s) for the valuable minerals contained therein. Be sure to indicate if there is a change of address:

Name (please print)
FRANKLIN BURNS

Current Mailing Address (please print)
21626 N. 23rd AVE. # 304A, PHX, AZ 85027

RECEIVED
 STATE OFFICE
 2018 JUL 31 P 1:27
 PHOENIX, ARIZONA

5. The undersigned testifies that on the date of JULY 31st, 2018, all monuments required by law were erected upon the subject claim(s), and all notices required by law were posted on the subject claim(s) or copies thereof were in place, and at said date, each corner monument bore or contained

markings sufficient to appropriately designate the corner of the claim to which it pertains and the name of the claim(s).

I hereby certify under penalty of perjury under the laws of the State of ARIZONA that the foregoing statements are true and correct:

(Signature of person responsible for above statement)

Date:

7/31/18

Title 18 U.S.C. 1001 and 43 U.S.C. 1212 make it a crime for any person knowingly and willfully to make to any department or agency of the United States any false, fictitious or fraudulent statements or representations as to any matter within its jurisdiction.

Notary Block

SUBSCRIBED AND SWORN TO before me, this 21st day of July 2018

By: FRANCIS L. BURNS
(Signature of Affiant)

Title: Notary Public - Maricopa County

My Commission Expires: January 22, 2023



INSTRUCTIONS

1. This is an optional form that may be used to satisfy the requirements for the Bureau of Land Management (BLM) under the provisions of 43 U.S.C. §1744 and 30 U.S.C. §28-28d and the regulations thereunder (43 CFR part 3835). Since local and State laws may vary, you should contact your local and State agencies where the claims are located to ensure all applicable laws and requirements are satisfied.
2. The claimant(s) must fill in the date in paragraph 1 for the applicable assessment year and the county and state where the claims are located.
3. All claim names, BLM serial numbers, legal descriptions, and original county recording information must be listed for the claims pertaining to this assessment notice.
4. The claimant(s) must complete paragraph 2 listing all labor or improvements which was performed on or did benefit the subject mining claims. The value and date of the labor or improvements must also be listed. The total amount of labor or improvements can be listed, but the total expenditure must equal at least \$100 for each claim.
5. The names and current mailing addresses of the person(s) performing the labor shall be listed in paragraph 3.
6. The name and current mailing address of each owner (claimant) of the claims shall be listed in paragraph 4. The mailing address shall be the owner's address and not the address of an agent or anyone representing the claimant. Be sure to note if there has been a change of address.
7. Paragraph 5 shall be completed to show the date it was verified that all monuments required by law were properly erected, all notices were posted, and that corners were appropriately designated for all claims listed.
8. An exact legible reproduction or duplicate (other than microfilm or other electronic media) of this affidavit or another type of affidavit of assessment work that you file or will file in the county where each claim is located, must be filed with the BLM on or before December 30 of the calendar year in which the assessment year ends. For mill or tunnel sites, a separate notice of intent to hold must be filed with the BLM on or before December 30. Requirements for filing a notice of intent to hold can be found at 43 CFR 3835.33.
9. A processing fee of \$10 for each claim listed must be remitted to the BLM along with this or any other affidavit of assessment work.

LR2000 Production

Customer Name Update Screen

Case Recordation
View
Mining Claims
View/Update
Mass Owner
Mass Action
Status
View
LLD / Land
View LLD
Customer Name
New
View/Update
Transaction Rpts
Mass Upd Report
MC CBS Export
CBS Import Rpt
MC PayPortal Rpt
Data Scan
Case Scan
Administration
My Permissions
Decode Tables
Links
LR2000 Reports
CMR Reports
Lands Data Standards
Minerals Data Standards
LR2000 Sharepoint
LR2000 User Support
GLO Records
NTC Knwldge Rsrce Ctr

System ID: MC

Name: BURNS FRANKLIN

Proprietor #: 2117754

Category: P - PRIVATE

Address: 5828 N SCOTTSDALE RD

City: SCOTTSDALE

State: AZ **Lookup**

Zip: 852535916

UNDELIVERABLE

No Annual Reminders

Email: DESERTFEVER@MSN.COM

Phone: 602-503-1605

PREVIOUS ADDRESS

NEW ADD UPDATED

8/1/18 RAM

Save Save/Override DataFlux

Delete **Renumber**

Switch Screen

Function Keys	
Alt <-	Back
Alt ->	Forward
Alt-F2	Switch
Alt-F4	Close
Backspace	Back



United States Department of the Interior
Bureau of Land Management
 DIV OF LANDS, MINRLS & ENERGY
 ONE N CENTRAL AVE
 PHOENIX, AZ 85004 -4427
 Phone: 602-417-9200

Receipt

No:

4223543

Transaction #: 4338774	
Date of Transaction: 07/31/2018	
CUSTOMER:	
FRANK BURNS 21626 N 23RD AVE #304A PHOENIX, AZ 85027-2543 US	

LINE #	QTY	DESCRIPTION	REMARKS	UNIT PRICE	TOTAL
1	1.00	LOCATABLE MINERALS / MINING CLAIMS-NOT NEW-UNADJUD, ONE AUTH NO. ONLY / MINING CLAIM MONEY RECEIVED CASES: AMC318631/\$20.00	POL/2 2018 WAVER	- n/a -	20.00
TOTAL:					\$20.00

PAYMENT INFORMATION				
NOTE: Items will appear on credit card statement as "Bureau of Land Mgmt CO".				
1	AMOUNT:	20.00	POSTMARKED:	N/A
	TYPE:	CREDIT CARD	RECEIVED:	07/31/2018
	NAME:	BURNS, FRANK 21626 N 23RD AVE #304A PHOENIX AZ 85027-2543 US		
	CARD NO:	XXXXXXXXXXXX6077	AUTH CODE:	079674
	NAME ON CARD:	FRANKLIN BURNS		
	SIGNATURE:			

REMARKS

This receipt was generated by the automated BLM Collections and Billing System and is a paper representation of a portion of the official electronic record contained therein.

130 PER

AMC 318630
386581

MAINTENANCE FEE WAIVER CERTIFICATION

FORM APPROVED
OMB NO. 1004-0114
Expires: January 31, 2020

SEE INSTRUCTIONS ON PAGE 2

- This small miner waiver is filed for the assessment year beginning on September 1, 2018 and ending on September 1, 2019.
- The undersigned and all related parties owned ten or fewer mining claims, mill, or tunnel sites located and maintained on Federal lands in the United States of America on September 1, 2018.
- The undersigned have performed the assessment work required by law for each mining claim listed prior to filing this waiver and understand that by filing this form, the undersigned must file an affidavit of assessment work with the Bureau of Land Management (BLM) by the December 30th following the filing of this waiver.
- The undersigned understand that if the assessment work obligation has not yet come due under 30 U.S.C. 28 (for those claims in their first assessment year only), a notice of intent to hold reciting this condition must be recorded by the December 30th following the filing of this waiver.
- The undersigned understand that mill and tunnel sites may also be listed on this waiver and be waived from payment of the maintenance fee, and that a notice of intent to hold for these sites is required to be filed with the BLM by the December 30th following the filing of this waiver.
- The undersigned understand and acknowledge that pursuant to 43 U.S.C. 1212 and 18 U.S.C. 1001, the filing or recording of a false, fictitious, or fraudulent document with the BLM may result in a fine of up to \$250,000, a prison term not to exceed five years, or both.
- The mining claims, mill or tunnel sites for which this waiver from payment of the maintenance fees is requested are:

CLAIM OR SITE NAME	BLM RECORDATION SERIAL NUMBER
1. BLAND MINE # 22	AMC # 318631
2. DEBORAH SUE MINE	AMC # 386581
3.	
4.	
5.	
6.	
7.	
8.	
9.	
10.	

The owner(s) (claimants) of the above mining claims and sites are:

FRANKLIN BURNS

(Owner's Name - Please Print)

21626 N. 23rd AVE. # 304A

(Owner's Mailing Address)

(Owner's Signature)

PHOENIX

AZ

85027

(City)

(State)

(Zip Code)

(Owner's Name - Please Print)

(Owner's Mailing Address)

(Owner's Signature)

(City)

(State)

(Zip Code)

(Owner's Name - Please Print)

(Owner's Mailing Address)

(Owner's Signature)

(City)

(State)

(Zip Code)

(Owner's Name - Please Print)

(Owner's Mailing Address)

(Owner's Signature)

(City)

(State)

(Zip Code)

(Continued on page 2)

483
ENTERED
SEP 04 2018
BY:

PHOENIX, ARIZONA
2018 JUL 31 P 1:23
RECEIVED
BLM AZ STATE OFFICE

NW
RM

(Owner's Name - Please Print)

(Owner's Signature)

(Owner's Mailing Address)

(City)

(State)

(Zip Code)

(Owner's Name - Please Print)

(Owner's Signature)

(Owner's Mailing Address)

(City)

(State)

(Zip Code)

(Owner's Name - Please Print)

(Owner's Signature)

(Owner's Mailing Address)

(City)

(State)

(Zip Code)

(Owner's Name - Please Print)

(Owner's Signature)

(Owner's Mailing Address)

(City)

(State)

(Zip Code)

18 U.S.C. 1001 and 43 U.S.C. 1212 make it a crime for any person knowingly and willfully to make to any department or agency of the United States any false, fictitious or fraudulent statements or representations as to any matter within its jurisdiction.

INSTRUCTIONS

1. This certification is made under the provisions of 43 U.S.C. § 1744 and 30 U.S.C. §28-28k and the regulations thereunder (43 CFR Part 3830).
2. The claimant(s) must fill in the dates in paragraph 1 for the beginning and ending of the assessment year for which this waiver is sought.
3. The claimant(s) must fill in the date in paragraph 2 for the beginning of the assessment year for which this waiver is sought.
4. All claim and site names and BLM serial numbers must be listed for the mining claims, mill sites, and tunnel sites for which the waiver is sought.
5. All owners of the mining claims, mill sites, and tunnel sites and their addresses must be given.
6. This waiver form must be signed by all the claimants or their designated agent, in original form. If an agent is designated, a notarized designation of agent, signed by all of the claimants with proper address given, must be submitted with this waiver.
7. This form must be filed no later than September 1st for the upcoming assessment year in the BLM State Office where the mining claims or sites are recorded, or the waiver cannot be granted by the BLM. (Example: To obtain a waiver for the assessment year 2012, which begins on September 1, 2011, you must qualify for and file for a waiver no later than September 1, 2011, in the proper BLM State Office.)
8. For all mining claims which require assessment work, you must record an affidavit of labor on or before the December 30th immediately following the filing of this waiver. For all other mining claims or sites waived, you must record a notice of intent to hold on or before the December 30th immediately following the filing of this waiver.
9. Mill and tunnel sites may also be listed on this waiver and be waived from payment of the maintenance fee. A notice of intent to hold for these sites is required to be filed by the December 30th following the filing of this waiver.

FOR OFFICIAL USE ONLY

UNITED STATES
DEPARTMENT OF THE INTERIOR
BUREAU OF LAND MANAGEMENT

MAINTENANCE FEE WAIVER CERTIFICATION

274

Amc 318630

FORM APPROVED
OMB NO. 1004-0114

Expires: January 31, 2020

Amc 386581

SEE INSTRUCTIONS ON PAGE 2

- This small miner waiver is filed for the assessment year beginning on September 1, 2017 and ending on September 1, 2018.
- The undersigned and all related parties owned ten or fewer mining claims, mill, or tunnel sites located and maintained on Federal lands in the United States of America on September 1, 2017.
- The undersigned have performed the assessment work required by law for each mining claim listed prior to filing this waiver and understand that by filing this form, the undersigned must file an affidavit of assessment work with the Bureau of Land Management (BLM) by the December 30th following the filing of this waiver.
- The undersigned understand that if the assessment work obligation has not yet come due under 30 U.S.C. 28 (for those claims in their first assessment year only), a notice of intent to hold reciting this condition must be recorded by the December 30th following the filing of this waiver.
- The undersigned understand that mill and tunnel sites may also be listed on this waiver and be waived from payment of the maintenance fee, and that a notice of intent to hold for these sites is required to be filed with the BLM by the December 30th following the filing of this waiver.
- The undersigned understand and acknowledge that pursuant to 43 U.S.C. 1212 and 18 U.S.C. 1001, the filing or recording of a false, fictitious, or fraudulent document with the BLM may result in a fine of up to \$250,000, a prison term not to exceed five years, or both.
- The mining claims, mill or tunnel sites for which this waiver from payment of the maintenance fees is requested are:

CLAIM OR SITE NAME	BLM RECORDATION SERIAL NUMBER
1. BLAND MINE # 22	✓ Amc # 318631
2. DEBORAH SUE MINE	Amc # 386581
3.	
4.	
5.	
6.	
7.	
8.	
9.	
10.	

The owner(s) (claimants) of the above mining claims and sites are:

FRANKLIN BURNS ✓
(Owner's Name - Please Print)

5828 N. SCOTTSDALE RD
(Owner's Mailing Address)

[Signature]
(Owner's Signature)

SCOTTSDALE AZ 85253
(City) (State) (Zip Code)

ENTERED
AC 483
SEP 15 2017

(Owner's Name - Please Print)

(Owner's Mailing Address)

(Owner's Signature)

(City) (State) (Zip Code)

(Owner's Name - Please Print)

(Owner's Mailing Address)

(Owner's Signature)

(City) (State) (Zip Code)

NW/2CT
(Owner's Name - Please Print)

(Owner's Mailing Address)

(Owner's Signature)

(City) (State) (Zip Code)

PHOENIX ARIZONA
2017 AUG 21 11:52
RECEIVED
BLM STATE OFFICE

(Owner's Name - Please Print)	(Owner's Signature)
(Owner's Mailing Address)	(City) (State) (Zip Code)
(Owner's Name - Please Print)	(Owner's Signature)
(Owner's Mailing Address)	(City) (State) (Zip Code)
(Owner's Name - Please Print)	(Owner's Signature)
(Owner's Mailing Address)	(City) (State) (Zip Code)
(Owner's Name - Please Print)	(Owner's Signature)
(Owner's Mailing Address)	(City) (State) (Zip Code)

18 U.S.C. 1001 and 43 U.S.C. 1212 make it a crime for any person knowingly and willfully to make to any department or agency of the United States any false, fictitious or fraudulent statements or representations as to any matter within its jurisdiction.

INSTRUCTIONS

1. This certification is made under the provisions of 43 U.S.C. § 1744 and 30 U.S.C. §28-28k and the regulations thereunder (43 CFR Part 3830).
2. The claimant(s) must fill in the dates in paragraph 1 for the beginning and ending of the assessment year for which this waiver is sought.
3. The claimant(s) must fill in the date in paragraph 2 for the beginning of the assessment year for which this waiver is sought.
4. All claim and site names and BLM serial numbers must be listed for the mining claims, mill sites, and tunnel sites for which the waiver is sought.
5. All owners of the mining claims, mill sites, and tunnel sites and their addresses must be given.
6. This waiver form must be signed by all the claimants or their designated agent, in original form. If an agent is designated, a notarized designation of agent, signed by all of the claimants with proper address given, must be submitted with this waiver.
7. This form must be filed no later than September 1st for the upcoming assessment year in the BLM State Office where the mining claims or sites are recorded, or the waiver cannot be granted by the BLM. (Example: To obtain a waiver for the assessment year 2012, which begins on September 1, 2011, you must qualify for and file for a waiver no later than September 1, 2011, in the proper BLM State Office.)
8. For all mining claims which require assessment work, you must record an affidavit of labor on or before the December 30th immediately following the filing of this waiver. For all other mining claims or sites waived, you must record a notice of intent to hold on or before the December 30th immediately following the filing of this waiver.
9. Mill and tunnel sites may also be listed on this waiver and be waived from payment of the maintenance fee. A notice of intent to hold for these sites is required to be filed by the December 30th following the filing of this waiver.

PHOENIX, ARIZONA
 2017 AUG 21 A 11:52
 BLM AZ STATE OFFICE
 RECEIVED

FOR OFFICIAL USE ONLY

UNITED STATES DEPARTMENT OF THE INTERIOR
BUREAU OF LAND MANAGEMENT

MC NATIONWIDE CLAIMANT LISTING
September 21, 2017

	AZ	National
Cust	CLAIMANT	Total
BURNS FRANKLIN 5828 N SCOTTSDALE RD SCOTTSDALE, AZ 85253-5916	2	2

When Recorded Return Document to:
FRANK BURNS
5828 N. SCOTTSDALE RD
SCOTTSDALE, AZ 85253

318630

386581

Check here if this is a change of address.

Telephone: (602) 503 1605

E-mail address: desertfever@msn.com

AFFIDAVIT OF PERFORMANCE OF ANNUAL WORK

1. State of Arizona, County of YAVAPAI ss:

2. I (Name) FRANKLIN BURNS

3. Reside at (Address) 5828 N. SCOTTSDALE RD.

City SCOTTSDALE County MARICOPA

State AZ Zip 85253 being duly sworn, depose and say that I am a citizen of the United States, more than eighteen years of age, and that all of the facts set forth in this affidavit, subject to the provisions and penalties of 18 U.S.C. 1001 pertaining to the filing of false, fictitious, or fraudulent statements with the United States, are true and correct according to the best of my knowledge, information and belief.

4. Owner's name and address (if not shown in Items 1-3 above) _____

5. That I am personally acquainted with the mining claim(s). The work and improvements were made by and at the expense of the owner(s) of said claim(s). Said contiguous group of claims, listed on this document, are situated in the

(optional) Mining District; YAVAPAI County, Arizona.

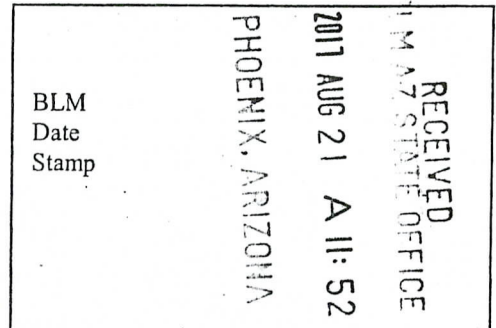

Line No.	AMC NUMBER	CLAIM/SITE NAME	COUNTY RECORDER DATA (if available)	TWP	RNG	SEC
1	318631	BLAND MINE #22		10N	2E	29
2						
3						
4						
5						
6						

Form: MCF108
 Revised July 2014
 Page 1 of 2

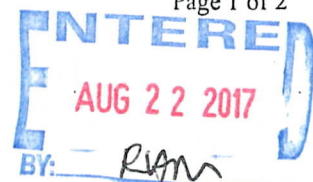

RECEIVED
BLM AZ STATE OFFICE
2017 AUG 21 A 11:52
PHOENIX, ARIZONA

BLM
Date
Stamp

7						
8						
9						
10						

6. That between the dates starting at 12 o'clock noon on September 1, 20 16 and ending at 12 o'clock noon on September 1, 20 17 at least \$ \$100⁰⁰ dollars worth of work and improvements were done and performed upon said claim(s) or upon one or more of a contiguous group of claims for the benefit of all, wholly or partly outside of a contiguous group of claims for the benefit of all, not including the location work.

7. That the following persons were employed to perform the work and improvements described herein: FRANKLIN BURNS

8. That the work and improvements performed were: ROAD WORK BY HAND, REPAIRED FENCING & SIGNS, SORT & HAUC ORE, CONTINUE INSTALLATION of steel cover over MINESHAFIT

9. Dated: 8/21/17 Signature: [Signature]

SUBSCRIBED AND SWORN TO before me, a Notary Public, this 21st day of August 20 17

By: Franklin Burns

Notary Public [Signature]
My Commission Expires 3/27/2020

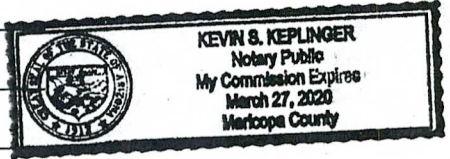

Bureau of Land Management
Arizona State Office
www.blm.gov/az

No. of Claims: 2 x \$10 = 20
 Check No.: CC Injt. [Signature]
 Receipt No.: 307440657
 For BLM Use Only

When Recorded Return Document to:

FRANK BURNS
5828 N. SCOTTSDALE RD
SCOTTSDALE AZ 85253

Check here if this is a change of address.

Telephone: (602) 503-1605

E-mail address: desertfever@msn.com

AFFIDAVIT OF PERFORMANCE OF ANNUAL WORK

- 1. State of Arizona, County of YAVAPAI ss:
- 2. I (Name) FRANKLIN BURNS
- 3. Reside at (Address) 5828 N. SCOTTSDALE RD.

RECEIVED
 BLM AZ STATE OFFICE
 2017 AUG 21 A 11: 52
 PHOENIX, ARIZONA
 BLM
 Date
 Stamp

City SCOTTSDALE County MARICOPA

State AZ Zip 85253 being duly sworn, depose and say that I am a citizen of the United States, more than eighteen years of age, and that all of the facts set forth in this affidavit, subject to the provisions and penalties of 18 U.S.C. 1001 pertaining to the filing of false, fictitious, or fraudulent statements with the United States, are true and correct according to the best of my knowledge, information and belief.

4. Owner's name and address (If not shown in Items 1-3 above). _____

5. That I am personally acquainted with the mining claim(s). The work and improvements were made by and at the expense of the owner(s) of said claim(s). Said contiguous group of claims, listed on this document, are situated in the

_____ (optional) Mining District; YAVAPAI County, Arizona.

Line No.	AMC NUMBER	CLAIM/SITE NAME	COUNTY RECORDER DATA (If available)	TWP	RNG	SEC
1	386581	DEBORAH SUE MINE		10N	2E	33
2						
3						
4						
5						
6						

RECEIVED
BLM AZ STATE OFFICE
2017 AUG 21 A 11:52
PHOENIX, ARIZONA

BLM
Date
Stamp

7						
8						
9						
10						

6. That between the dates starting at 12 o'clock noon on September 1, 20 16 and ending at 12 o'clock noon on September 1, 20 17 at least \$ 8100.00 dollars worth of work and improvements were done and performed upon said claim(s) or upon one or more of a contiguous group of claims for the benefit of all, wholly or partly outside of a contiguous group of claims for the benefit of all, not including the location work.

7. That the following persons were employed to perform the work and improvements described herein: _____
FRANKLIN BURNS

8. That the work and improvements performed were: _____
ROAD WORK BY HANDS, REPAIR WARNING SIGNS
SORT & HAUL ORE, TRANSPORT TO BAND MINE # 22

9. Dated: 8/21/17 Signature: [Signature]

SUBSCRIBED AND SWORN TO before me, a Notary Public, this 21st day of August 20 17

By: Franklin Burns

Notary Public [Signature]
My Commission Expires 3/27/2020

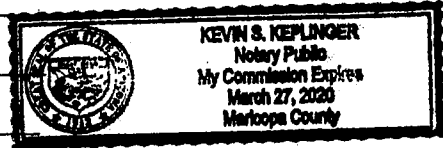

Bureau of Land Management
Arizona State Office
www.blm.gov/az

No. of Claims: _____ x \$10 = _____
Check No.: _____ Init. _____
Receipt No.: _____
For BLM Use Only

United States Department of the Interior
Bureau of Land Management
 DIV OF LANDS, MINRLS & ENERGY
 ONE N CENTRAL AVE
 PHOENIX, AZ 85004 -4427
 Phone: 602-417-9200

Receipt

No: 3946657

Transaction #: 4056366	
Date of Transaction: 08/21/2017	
CUSTOMER:	
FRANK BURNS 5828 N SCOTTSDALE RD SCOTTSDALE, AZ 85253-5916 US	

LINE #	QTY	DESCRIPTION	REMARKS	UNIT PRICE	TOTAL
1	1.00	LOCATABLE MINERALS / MINING CLAIMS- NOT NEW-UNADJUD, ONE AUTH NO. ONLY / MINING CLAIM MONEY RECEIVED CASES: AMC318631/\$20.00	POL 2017/2 WAV	- n/a -	20.00
TOTAL:					\$20.00

PAYMENT INFORMATION			
NOTE: Items will appear on credit card statement as "Bureau of Land Mgmt CO".			
1	AMOUNT:	20.00	POSTMARKED: N/A
	TYPE:	CREDIT CARD	RECEIVED: 08/21/2017
	NAME:	BURNS, FRANK 5828 N SCOTTSDALE RD SCOTTSDALE AZ 85253-5916 US	
	CARD NO:	XXXXXXXXXXXX6077	AUTH CODE: 564258
	NAME ON CARD:	FRANKLIN L BURNS	
	EXPIRES:	07/2019	
	SIGNATURE:		

REMARKS

This receipt was generated by the automated BLM Collections and Billing System and is a paper representation of a portion of the official electronic record contained therein.

UNITED STATES
DEPARTMENT OF THE INTERIOR
BUREAU OF LAND MANAGEMENT

127

318630
386581

MAINTENANCE FEE WAIVER CERTIFICATION

FORM APPROVED
OMB NO. 1004-0114
Expires: October 31, 2016

SEE INSTRUCTIONS ON PAGE 2

- This small miner waiver is filed for the assessment year beginning on September 1, 2016 and ending on September 1, 2017
- The undersigned and all related parties owned ten or fewer mining claims, mill, or tunnel sites located and maintained on Federal lands in the United States of America on September 1, 2016
- The undersigned have performed the assessment work required by law for each mining claim listed prior to filing this waiver and understand that by filing this form, the undersigned must file an affidavit of assessment work with the Bureau of Land Management (BLM) by the December 30th following the filing of this waiver.
- The undersigned understand that if the assessment work obligation has not yet come due under 30 U.S.C. 28 (for those claims in their first assessment year only), a notice of intent to hold reciting this condition must be recorded by the December 30th following the filing of this waiver.
- The undersigned understand that mill and tunnel sites may also be listed on this waiver and be waived from payment of the maintenance fee, and that a notice of intent to hold for these sites is required to be filed with the BLM by the December 30th following the filing of this waiver.
- The undersigned understand and acknowledge that pursuant to 43 U.S.C. 1212 and 18 U.S.C. 1001, the filing or recording of a false, fictitious, or fraudulent document with the BLM may result in a fine of up to \$250,000, a prison term not to exceed five years, or both.
- The mining claims, mill or tunnel sites for which this waiver from payment of the maintenance fees is requested are:

CLAIM OR SITE NAME	BLM RECORDATION SERIAL NUMBER
1. <u>BLAND MINE #22</u> ✓	<u>AMC# 318631</u>
2. <u>DEBORAH SUE MINE</u>	<u>AMC# 386581</u>
3.	
4.	
5.	
6.	
7.	
8.	
9.	
10.	

The owner(s) (claimants) of the above mining claims and sites are:

FRANKLIN BURNS
(Owner's Name - Please Print)

5828 N. SCOTTSDALE RD
(Owner's Mailing Address)

[Signature]
(Owner's Signature)

SCOTTSDALE AZ 85253
(City) (State) (Zip Code)

(Owner's Name - Please Print)

(Owner's Mailing Address)

(Owner's Signature)

(City) (State) (Zip Code)

(Owner's Name - Please Print)

(Owner's Mailing Address)

(Owner's Signature)

(City) (State) (Zip Code)

(Owner's Name - Please Print)

(Owner's Mailing Address)

(Owner's Signature)

(City) (State) (Zip Code)

(Continued on page 2)

ENTERED
AUG 31 2016
DS

NL
8-31
RS

2016 JUL 27 4:11:41
PHOENIX ARIZONA
RECEIVED
BLM AZ STATE OFFICE

(Owner's Name - Please Print)	(Owner's Signature)
(Owner's Mailing Address)	(City) (State) (Zip Code)
(Owner's Name - Please Print)	(Owner's Signature)
(Owner's Mailing Address)	(City) (State) (Zip Code)
(Owner's Name - Please Print)	(Owner's Signature)
(Owner's Mailing Address)	(City) (State) (Zip Code)
(Owner's Name - Please Print)	(Owner's Signature)
(Owner's Mailing Address)	(City) (State) (Zip Code)

18 U.S.C. 1001 and 43 U.S.C. 1212 make it a crime for any person knowingly and willfully to make to any department or agency of the United States any false, fictitious or fraudulent statements or representations as to any matter within its jurisdiction.

INSTRUCTIONS

1. This certification is made under the provisions of 43 U.S.C. § 1744 and 30 U.S.C. §28-28k and the regulations thereunder (43 CFR Part 3830).
2. The claimant(s) must fill in the dates in paragraph 1 for the beginning and ending of the assessment year for which this waiver is sought.
3. The claimant(s) must fill in the date in paragraph 2 for the beginning of the assessment year for which this waiver is sought.
4. All claim and site names and BLM serial numbers must be listed for the mining claims, mill sites, and tunnel sites for which the waiver is sought.
5. All owners of the mining claims, mill sites, and tunnel sites and their addresses must be given.
6. This waiver form must be signed by all the claimants or their designated agent, in original form. If an agent is designated, a notarized designation of agent, signed by all of the claimants with proper address given, must be submitted with this waiver.
7. This form must be filed no later than September 1st for the upcoming assessment year in the BLM State Office where the mining claims or sites are recorded, or the waiver cannot be granted by the BLM. (Example: To obtain a waiver for the assessment year 2012, which begins on September 1, 2011, you must qualify for and file for a waiver no later than September 1, 2011, in the proper BLM State Office.)
8. For all mining claims which require assessment work, you must record an affidavit of labor on or before the December 30th immediately following the filing of this waiver. For all other mining claims or sites waived, you must record a notice of intent to hold on or before the December 30th immediately following the filing of this waiver.
9. Mill and tunnel sites may also be listed on this waiver and be waived from payment of the maintenance fee. A notice of intent to hold for these sites is required to be filed by the December 30th following the filing of this waiver.

RECEIVED
 JUL 27 11:41 AM '11
 PHOENIX, ARIZONA

RECEIVED
 BLM AZ STATE OFFICE
 2011 JUL 27 A 11:41
 PHOENIX, ARIZONA

FOR OFFICIAL USE ONLY

AFFIDAVIT OF ANNUAL ASSESSMENT WORK

386581
318630

WHEN RECORDED, MAIL DOCUMENT TO:

NAME: FRANK BURNS
ADDRESS: 5828 N. SCOTTSDALE RD.
CITY, STATE, ZIP: SCOTTSDALE, ARIZONA 85253

FOR COUNTY RECORDER'S USE

No. of Claims 2
x \$10/claim
Total due BLM \$ 20

TO ALL WHOM IT MAY CONCERN:

1. The undersigned certifies that at least \$100 per claim was expended for development, labor and improvements, or equivalent value added, as the annual assessment work for the assessment year ending September 1, 2016 for the following contiguous unpatented mining claim(s), located in the County of YAVAPAI, in the State of ARIZONA.

BLM Serial No.	Name of Claim	Tp Rg Sec Mer				County Recordation Book and Page No.	Date
		Example: 13N 5E 14 MDM					
386581	DEBORAH SUE MINE	10N	2E	33			

RECEIVED
BLM AZ STATE OFFICE
2016 JUL 27 AM 11:41
PHOENIX, ARIZONA

3015401

(Continued on page 2)

ENTERED
JUL 28 2016
BY: RAM

2. Type of labor and improvements (specify what was done and give the total value for that labor and improvement to show at least \$100 for each claim). If a geological, geochemical, or geophysical survey was performed, as per 30 U.S.C. 28-1, reference the title of the report of survey, give cost and date of the survey and report, and indicate it was filed with the County Recorder:

Description of Work Performed	Value of Work Performed	Date Work Was Performed
ROAD WORK by HAND, REPAIR WARNING SIGNAGE	\$100.00	JAN-MARCH 2016
SORT & HAUL ORE to BLAND MINE # 22	\$250.00	APR-JUN 2016

3. Name and mailing address of each person who performed the labor and improvements:

Name (please print)

FRANKLIN BURNS

Current Mailing Address (please print)

5828 N. SCOTTSDALE RD., SCOTTSDALE, ARIZONA 85523

4. Name and mailing address of each person who holds and claims the subject mining claim(s) for the valuable minerals contained therein. Be sure to indicate if there is a change of address:

Name (please print)

FRANKLIN BURNS

Current Mailing Address (please print)

5828 N. SCOTTSDALE RD., SCOTTSDALE, ARIZONA 85523

RECEIVED
 CLM AZ STATE OFFICE
 016 JUL 27 A 11:41
 PHOENIX, ARIZONA

5. The undersigned testifies that on the date of JULY 25TH, 2016, all monuments required by law were erected upon the subject claim(s), and all notices required by law were posted on the subject claim(s) or copies thereof were in place, and at said date, each corner monument bore or contained

markings sufficient to appropriately designate the corner of the claim to which it pertains and the name of the claim(s).

I hereby certify under penalty of perjury under the laws of the State of ARIZONA that the foregoing statements are true and correct:

[Signature] Date: 7/26/16
(Signature of person responsible for above statement)

Title 18 U.S.C. 1001 and 43 U.S.C. 1212 make it a crime for any person knowingly and willfully to make to any department or agency of the United States any false, fictitious or fraudulent statements or representations as to any matter within its jurisdiction.

Notary Block

SUBSCRIBED AND SWORN TO before me, this 26TH day of July 2016

By: [Signature]
(Signature of Affiant)

Title: Notary

My Commission Expires: June 23, 2020

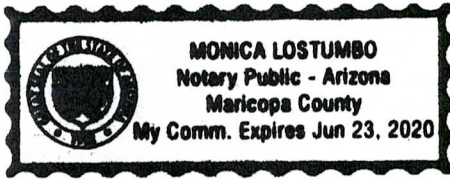

INSTRUCTIONS

1. This is an optional form that may be used to satisfy the requirements for the Bureau of Land Management (BLM) under the provisions of 43 U.S.C. §1744 and 30 U.S.C. §28-28d and the regulations thereunder (43 CFR part 3835). Since local and State laws may vary, you should contact your local and State agencies where the claims are located to ensure all applicable laws and requirements are satisfied.
2. The claimant(s) must fill in the date in paragraph 1 for the applicable assessment year and the county and state where the claims are located.
3. All claim names, BLM serial numbers, legal descriptions, and original county recording information must be listed for the claims pertaining to this assessment notice.
4. The claimant(s) must complete paragraph 2 listing all labor or improvements which was performed on or did benefit the subject mining claims. The value and date of the labor or improvements must also be listed. The total amount of labor or improvements can be listed, but the total expenditure must equal at least \$100 for each claim.
5. The names and current mailing addresses of the person(s) performing the labor shall be listed in paragraph 3.
6. The name and current mailing address of each owner (claimant) of the claims shall be listed in paragraph 4. The mailing address shall be the owner's address and not the address of an agent or anyone representing the claimant. Be sure to note if there has been a change of address.
7. Paragraph 5 shall be completed to show the date it was verified that all monuments required by law were properly erected, all notices were posted, and that corners were appropriately designated for all claims listed.
8. An exact legible reproduction or duplicate (other than microfilm or other electronic media) of this affidavit or another type of affidavit of assessment work that you file or will file in the county where each claim is located, must be filed with the BLM on or before December 30 of the calendar year in which the assessment year ends. For mill or tunnel sites, a separate notice of intent to hold must be filed with the BLM on or before December 30. Requirements for filing a notice of intent to hold can be found at 43 CFR 3835.33.
9. A processing fee of \$10 for each claim listed must be remitted to the BLM along with this or any other affidavit of assessment work.

RECEIVED
BLM AZ STATE OFFICE
2016 JUL 27 A 11:42
PHOENIX, ARIZONA

UNITED STATES
DEPARTMENT OF THE INTERIOR
BUREAU OF LAND MANAGEMENT

FORM APPROVED
OMB NO.: 1004-0114
Expires: October 31, 2016

AFFIDAVIT OF ANNUAL ASSESSMENT WORK

318630

WHEN RECORDED, MAIL DOCUMENT TO:

NAME: FRANK BURNS _____

ADDRESS: 5828 N. SCOTTSDALE RD. _____

CITY, STATE, ZIP: SCOTTSDALE, ARIZONA 85253 _____

FOR COUNTY RECORDER'S USE

No. of Claims _____
x \$10/claim
Total due BLM \$ _____

TO ALL WHOM IT MAY CONCERN:

1. The undersigned certifies that at least \$100 per claim was expended for development, labor and improvements, or equivalent value added, as the annual assessment work for the assessment year ending September 1, 2016 for the following contiguous unpatented mining claim(s), located in the County of YAVAPAI, in the State of ARIZONA.

BLM Serial No.	Name of Claim	Tp Rg Sec Mer				County Recordation Book and Page No.	Date
		Example: 13N 5E 14 MDM					
318631	BLAND MINE # 22	10N	2E	29			

RECEIVED
 BLM AZ STATE OFFICE
 2016 JUL 27 A 11:42
 PHOENIX, ARIZONA

2. Type of labor and improvements (specify what was done and give the total value for that labor and improvement to show at least \$100 for each claim). If a geological, geochemical, or geophysical survey was performed, as per 30 U.S.C. 28-1, reference the title of the report of survey, give cost and date of the survey and report, and indicate it was filed with the County Recorder:

Description of Work Performed	Value of Work Performed	Date Work Was Performed
ROAD WORK by HAND, REPAIR FENCING & WARNING SIGNAGE	\$250.00	JAN-MARCH 2016
SORT & CRUSH HAULED ORE	\$250.00	APR-JUN 2016
CONTINUE INSTALLATION OF STEEL COVER over MINESHAFT	\$1,000.00	AUG-DEC 2016

3. Name and mailing address of each person who performed the labor and improvements:

Name (please print)

FRANKLIN BURNS

Current Mailing Address (please print)

5828 N. SCOTTSDALE RD., SCOTTSDALE, ARIZONA 85523

4. Name and mailing address of each person who holds and claims the subject mining claim(s) for the valuable minerals contained therein. Be sure to indicate if there is a change of address:

Name (please print)

FRANKLIN BURNS

Current Mailing Address (please print)

5828 N. SCOTTSDALE RD., SCOTTSDALE, ARIZONA 85523

RECEIVED
 BLM AZ STATE OFFICE
 2016 JUL 27 A 11:42
 PHOENIX, ARIZONA

5. The undersigned testifies that on the date of JULY 25TH, 20¹⁶, all monuments required by law were erected upon the subject claim(s), and all notices required by law were posted on the subject claim(s) or copies thereof were in place, and at said date, each corner monument bore or contained

markings sufficient to appropriately designate the corner of the claim to which it pertains and the name of the claim(s).

I hereby certify under penalty of perjury under the laws of the State of ARIZONA that the foregoing statements are true and correct:

[Signature]

Date: 7/26/16

(Signature of person responsible for above statement)

Title 18 U.S.C. 1001 and 43 U.S.C. 1212 make it a crime for any person knowingly and willfully to make to any department or agency of the United States any false, fictitious or fraudulent statements or representations as to any matter within its jurisdiction.

Notary Block

SUBSCRIBED AND SWORN TO before me, this 26th day of July 2016

By: [Signature]
(Signature of Affiant)

Title: Notary

My Commission Expires: June 23, 2020



INSTRUCTIONS

1. This is an optional form that may be used to satisfy the requirements for the Bureau of Land Management (BLM) under the provisions of 43 U.S.C. §1744 and 30 U.S.C. §28-28d and the regulations thereunder (43 CFR part 3835). Since local and State laws may vary, you should contact your local and State agencies where the claims are located to ensure all applicable laws and requirements are satisfied.
2. The claimant(s) must fill in the date in paragraph 1 for the applicable assessment year and the county and state where the claims are located.
3. All claim names, BLM serial numbers, legal descriptions, and original county recording information must be listed for the claims pertaining to this assessment notice.
4. The claimant(s) must complete paragraph 2 listing all labor or improvements which was performed on or did benefit the subject mining claims. The value and date of the labor or improvements must also be listed. The total amount of labor or improvements can be listed, but the total expenditure must equal at least \$100 for each claim.
5. The names and current mailing addresses of the person(s) performing the labor shall be listed in paragraph 3.
6. The name and current mailing address of each owner (claimant) of the claims shall be listed in paragraph 4. The mailing address shall be the owner's address and not the address of an agent or anyone representing the claimant. Be sure to note if there has been a change of address.
7. Paragraph 5 shall be completed to show the date it was verified that all monuments required by law were properly erected, all notices were posted, and that corners were appropriately designated for all claims listed.
8. An exact legible reproduction or duplicate (other than microfilm or other electronic media) of this affidavit or another type of affidavit of assessment work that you file or will file in the county where each claim is located, must be filed with the BLM on or before December 30 of the calendar year in which the assessment year ends. For mill or tunnel sites, a separate notice of intent to hold must be filed with the BLM on or before December 30. Requirements for filing a notice of intent to hold can be found at 43 CFR 3835.33.
9. A processing fee of \$10 for each claim listed must be remitted to the BLM along with this or any other affidavit of assessment work.

2016 JUL 27 A 11:42

RECEIVED BLM AZ STATE OFFICE

**United States Department of the Interior
Bureau of Land Management**
DIV OF LANDS, MINRLS & ENERGY
ONE N CENTRAL AVE
PHOENIX, AZ 85004 -4427
Phone: 602-417-9200

Receipt

No: 3615401

Transaction #: 3718988	
Date of Transaction: 07/27/2016	
CUSTOMER:	
FRANK BURNS 5828 N SCOTTSDALE RD SCOTTSDALE, AZ 85253-5916 US	

LINE #	QTY	DESCRIPTION	REMARKS	UNIT PRICE	TOTAL
1	1.00	LOCATABLE MINERALS / MINING CLAIMS- NOT NEW-UNADJUD, ONE AUTH NO. ONLY / MINING CLAIM MONEY RECEIVED CASES: AMC318631/\$20.00	POL 2016/2 WAV	- n/a -	20.00
TOTAL:					\$20.00

PAYMENT INFORMATION			
NOTE: Items will appear on credit card statement as "Bureau of Land Mgmt CO".			
1	AMOUNT:	20.00	POSTMARKED: N/A
	TYPE:	CREDIT CARD	RECEIVED: 07/27/2016
	NAME:	BURNS, FRANK 5828 N SCOTTSDALE RD SCOTTSDALE AZ 85253-5916 US	
	CARD NO:	XXXXXXXXXXXX3869	AUTH CODE: 383022
	NAME ON CARD:	FRANKLIN LEE BURNS	
	EXPIRES:	12/2018	
	SIGNATURE:		

REMARKS

This receipt was generated by the automated BLM Collections and Billing System and is a paper representation of a portion of the official electronic record contained therein.

UNITED STATES
DEPARTMENT OF THE INTERIOR
BUREAU OF LAND MANAGEMENT

98

AG

318630

386581

FORM APPROVED
OMB NO. 1004-0114
Expires: October 31, 2016

MAINTENANCE FEE WAIVER CERTIFICATION

SEE INSTRUCTIONS ON PAGE 2

1. This small miner waiver is filed for the assessment year beginning on September 1, 2015 and ending on September 1, 2016
2. The undersigned and all related parties owned ten or fewer mining claims, mill, or tunnel sites located and maintained on Federal lands in the United States of America on September 1, 2015.
3. The undersigned have performed the assessment work required by law for each mining claim listed prior to filing this waiver and understand that by filing this form, the undersigned must file an affidavit of assessment work with the Bureau of Land Management (BLM) by the December 30th following the filing of this waiver.
4. The undersigned understand that if the assessment work obligation has not yet come due under 30 U.S.C. 28 (for those claims in their first assessment year only), a notice of intent to hold reciting this condition must be recorded by the December 30th following the filing of this waiver.
5. The undersigned understand that mill and tunnel sites may also be listed on this waiver and be waived from payment of the maintenance fee, and that a notice of intent to hold for these sites is required to be filed with the BLM by the December 30th following the filing of this waiver.
6. The undersigned understand and acknowledge that pursuant to 43 U.S.C. 1212 and 18 U.S.C. 1001, the filing or recording of a false, fictitious, or fraudulent document with the BLM may result in a fine of up to \$250,000, a prison term not to exceed five years, or both.
7. The mining claims, mill or tunnel sites for which this waiver from payment of the maintenance fees is requested are:

CLAIM OR SITE NAME	BLM RECORDATION SERIAL NUMBER
1. <u>BLAND MINE #22</u>	<u>AMC # 318631</u>
2. <u>DEBORAH SUE MINE</u>	<u>AMC # 386581</u>
3.	
4.	
5.	
6.	
7.	
8.	
9.	
10.	

The owner(s) (claimants) of the above mining claims and sites are:

FRANKLIN BURNS
(Owner's Name - Please Print)

5828 N. SCOTTSDALE RD
(Owner's Mailing Address)

[Signature]
(Owner's Signature)

SCOTTSDALE AZ 85253
(City) (State) (Zip Code)

(Owner's Name - Please Print)

(Owner's Mailing Address)

(Owner's Signature)

(City) (State) (Zip Code)

(Owner's Name - Please Print)

(Owner's Mailing Address)

(Owner's Signature)

(City) (State) (Zip Code)

(Owner's Name - Please Print)

(Owner's Mailing Address)

(Owner's Signature)

(City) (State) (Zip Code)

(Continued on page 2)

PHOENIX, ARIZONA

2015 JUL 21 4:11:41

RECEIVED
BLM AZ STATE OFFICE

RE

NW-R2 9/3

(Owner's Name - Please Print)

(Owner's Signature)

(Owner's Mailing Address)

(City) (State) (Zip Code)

(Owner's Name - Please Print)

(Owner's Signature)

(Owner's Mailing Address)

(City) (State) (Zip Code)

(Owner's Name - Please Print)

(Owner's Signature)

(Owner's Mailing Address)

(City) (State) (Zip Code)

(Owner's Name - Please Print)

(Owner's Signature)

(Owner's Mailing Address)

(City) (State) (Zip Code)

18 U.S.C. 1001 and 43 U.S.C. 1212 make it a crime for any person knowingly and willfully to make to any department or agency of the United States any false, fictitious or fraudulent statements or representations as to any matter within its jurisdiction.

INSTRUCTIONS

1. This certification is made under the provisions of 43 U.S.C. § 1744 and 30 U.S.C. §28-28k and the regulations thereunder (43 CFR Part 3830).
2. The claimant(s) must fill in the dates in paragraph 1 for the beginning and ending of the assessment year for which this waiver is sought.
3. The claimant(s) must fill in the date in paragraph 2 for the beginning of the assessment year for which this waiver is sought.
4. All claim and site names and BLM serial numbers must be listed for the mining claims, mill sites, and tunnel sites for which the waiver is sought.
5. All owners of the mining claims, mill sites, and tunnel sites and their addresses must be given.
6. This waiver form must be signed by all the claimants or their designated agent, in original form. If an agent is designated, a notarized designation of agent, signed by all of the claimants with proper address given, must be submitted with this waiver.
7. This form must be filed no later than September 1st for the upcoming assessment year in the BLM State Office where the mining claims or sites are recorded, or the waiver cannot be granted by the BLM. (Example: To obtain a waiver for the assessment year 2012, which begins on September 1, 2011, you must qualify for and file for a waiver no later than September 1, 2011, in the proper BLM State Office.)
8. For all mining claims which require assessment work, you must record an affidavit of labor on or before the December 30th immediately following the filing of this waiver. For all other mining claims or sites waived, you must record a notice of intent to hold on or before the December 30th immediately following the filing of this waiver.
9. Mill and tunnel sites may also be listed on this waiver and be waived from payment of the maintenance fee. A notice of intent to hold for these sites is required to be filed by the December 30th following the filing of this waiver.

PHOENIX, ARIZONA

RECEIVED

BLM AZ STATE OFFICE

AUG 21 11:41 AM

FOR OFFICIAL USE ONLY

AFFIDAVIT OF ANNUAL ASSESSMENT WORK

318630

WHEN RECORDED, MAIL DOCUMENT TO:

NAME: FRANK BURNS

ADDRESS: 5828 N. SCOTTSDALE RD

CITY, STATE, ZIP: SCOTTSDALE, AZ 85253

FOR COUNTY RECORDER'S USE

No. of Claims 1
x \$10/claim 10.00
Total due BLM \$ 10.00

3347311

TO ALL WHOM IT MAY CONCERN:

1. The undersigned certifies that at least \$100 per claim was expended for development, labor and improvements, or equivalent value added, as the annual assessment work for the assessment year ending September 1, 2015 for the following contiguous unpatented mining claim(s), located in the County of YAVAPAI (with initials), in the State of ARIZONA.

BLM Serial No.	Name of Claim	Tp Rg Sec Mer				County Recordation Book and Page No.	Date
		Example: 13N 5E 14 MDM					
318631	BLAND MINE #22	10N	2E	29			

RECEIVED
PHOENIX, ARIZONA
2015 JUL 21 A 11:42

ENTERED
JUL 22 2015
BY: RH

RECEIVED
BLM AZ STATE OFFICE

2. Type of labor and improvements (specify what was done and give the total value for that labor and improvement to show at least \$100 for each claim). If a geological, geochemical, or geophysical survey was performed, as per 30 U.S.C. 28-1, reference the title of the report of survey, give cost and date of the survey and report, and indicate it was filed with the County Recorder:

Description of Work Performed	Value of Work Performed	Date Work Was Performed
ROAD WORK, REPAIR FENCE, SIGNAGE	250. ⁰⁰	JAN/FEB 2014
HAUL ORE, CRUSH ORE	250. ⁰⁰	MAR-JUN 2014
INSTALLATION OF STEEL COVER OVER SHAFT	500. ⁰⁰	JUL-OCT 2014

3. Name and mailing address of each person who performed the labor and improvements:

Name (please print)

FRANKLIN BURNS

Current Mailing Address (please print)

5828 N. SCOTTSDALE RD, SCOTTSDALE AZ 85253

4. Name and mailing address of each person who holds and claims the subject mining claim(s) for the valuable minerals contained therein. Be sure to indicate if there is a change of address:

Name (please print)

FRANKLIN BURNS

Current Mailing Address (please print)

5828 N. SCOTTSDALE RD, SCOTTSDALE AZ 85253

RECEIVED
IN AZ STATE OFFICE
2015 JUL 21 A 11:42
PHOENIX, ARIZONA

5. The undersigned testifies that on the date of July 21st, 2015, all monuments required by law were erected upon the subject claim(s), and all notices required by law were posted on the subject claim(s) or copies thereof were in place, and at said date, each corner monument bore or contained

markings sufficient to appropriately designate the corner of the claim to which it pertains and the name of the claim(s).

I hereby certify under penalty of perjury under the laws of the State of ARIZONA that the foregoing statements are true and correct:

[Signature] Date: 7/21/15
(Signature of person responsible for above statement)

Title 18 U.S.C. 1001 and 43 U.S.C. 1212 make it a crime for any person knowingly and willfully to make to any department or agency of the United States any false, fictitious or fraudulent statements or representations as to any matter within its jurisdiction.

Notary Block

SUBSCRIBED AND SWORN TO before me, this 21st day of July 2015

By: [Signature]
(Signature of Affiant)

Title: [Signature]

My Commission Expires: June 20th 2018

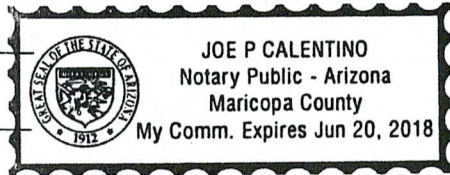

INSTRUCTIONS

1. This is an optional form that may be used to satisfy the requirements for the Bureau of Land Management (BLM) under the provisions of 43 U.S.C. §1744 and 30 U.S.C. §28-28d and the regulations thereunder (43 CFR part 3835). Since local and State laws may vary, you should contact your local and State agencies where the claims are located to ensure all applicable laws and requirements are satisfied.
2. The claimant(s) must fill in the date in paragraph 1 for the applicable assessment year and the county and state where the claims are located.
3. All claim names, BLM serial numbers, legal descriptions, and original county recording information must be listed for the claims pertaining to this assessment notice.
4. The claimant(s) must complete paragraph 2 listing all labor or improvements which was performed on or did benefit the subject mining claims. The value and date of the labor or improvements must also be listed. The total amount of labor or improvements can be listed, but the total expenditure must equal at least \$100 for each claim.
5. The names and current mailing addresses of the person(s) performing the labor shall be listed in paragraph 3.
6. The name and current mailing address of each owner (claimant) of the claims shall be listed in paragraph 4. The mailing address shall be the owner's address and not the address of an agent or anyone representing the claimant. Be sure to note if there has been a change of address.
7. Paragraph 5 shall be completed to show the date it was verified that all monuments required by law were properly erected, all notices were posted, and that corners were appropriately designated for all claims listed.
8. An exact legible reproduction or duplicate (other than microfilm or other electronic media) of this affidavit or another type of affidavit of assessment work that you file or will file in the county where each claim is located, must be filed with the BLM on or before December 30 of the calendar year in which the assessment year ends. For mill or tunnel sites, a separate notice of intent to hold must be filed with the BLM on or before December 30. Requirements for filing a notice of intent to hold can be found at 43 CFR 3835.33.
9. A processing fee of \$10 for each claim listed must be remitted to the BLM along with this or any other affidavit of assessment work.

PHOENIX, ARIZONA
2015 JUL 21 A 11:42

RECEIVED
MARICOPA STATE OFFICE

NOTICES

THE PRIVACY ACT and 43 CFR 2.48(d) require that you be furnished with the following information in connection with the information requested by this form.

AUTHORITY: 30 U.S.C. §28-28d and 43 CFR part 3835 permit collection of the information requested by this form.

PRINCIPAL PURPOSE: The BLM will use the information you provide to document compliance with 43 U.S.C. 1744 and that assessment work has been completed in accordance with 30 U.S.C. § 28-28d and 43 CFR part 3835 in lieu of paying the maintenance fee for the mining claims listed on this form.

ROUTINE USES: The BLM will only disclose this information in accordance with the provisions at 43 CFR 2.56(b) and (c).

EFFECT OF NOT PROVIDING INFORMATION: Disclosure of the requested information is required by 30 U.S.C. § 28-28d and 43 CFR part 3835 for claimants qualified to perform assessment work in lieu of paying the maintenance fee. Failure to submit all the requested information or to complete this form will delay the BLM's processing of the form and may preclude the BLM's acceptance of the assessment work information, which may result in forfeiture of the mining claim(s) by the claimant.

THE PAPERWORK REDUCTION ACT requires us to inform you that:

Use of this form is optional. You must perform assessment if a waiver to pay the maintenance fee has been requested. This form is provided to help you attest that annual assessment work has been completed in lieu of paying the maintenance fee for your claim(s). Submission of the requested information is necessary to obtain or retain a benefit.

You do not have to respond to this or any other Federal agency-sponsored information collection unless it displays a valid OMB control number.

BURDEN HOURS STATEMENT: The estimated public reporting burden for this form is 30 minutes per response, including the time for reviewing instructions, gathering and maintaining data, and completing and reviewing the form. You may submit comments regarding the burden estimate or any other aspect of this form to: U.S. Department of the Interior, Bureau of Land Management (1004-0114), Bureau Information Collection Clearance Officer (WO-630), 1849 C Street, N.W., Room 2134LM, Washington, D.C. 20240.

2. Type of labor and improvements (specify what was done and give the total value for that labor and improvement to show at least \$100 for each claim). If a geological, geochemical, or geophysical survey was performed, as per 30 U.S.C. 28-1, reference the title of the report of survey, give cost and date of the survey and report, and indicate it was filed with the County Recorder:

Description of Work Performed	Value of Work Performed	Date Work Was Performed
ROAD WORK by HAND REPAIR SIGNAGE	100 ⁰⁰	JAN FEB 2011
SOFT & HAUL ORE TO BLAND MINE #22	250 ⁰⁰	MAR-JUN 2011
COMPLETE BAT GATE OVER MINE SHAFT	500 ⁰⁰	JUL-OCT 2011

3. Name and mailing address of each person who performed the labor and improvements:

Name (please print)

FRANKLIN BURNS

Current Mailing Address (please print)

5828 N. SCOTTSDALE RD, SCOTTSDALE AZ 85251

4. Name and mailing address of each person who holds and claims the subject mining claim(s) for the valuable minerals contained therein. Be sure to indicate if there is a change of address:

Name (please print)

FRANKLIN BURNS

Current Mailing Address (please print)

5828 N. SCOTTSDALE RD, SCOTTSDALE AZ 85251

RECEIVED
 LM AZ STATE OFFICE
 2015 JUL 21 A 11:42
 PHOENIX, ARIZONA

5. The undersigned testifies that on the date of July 21ST, 2015, all monuments required by law were erected upon the subject claim(s), and all notices required by law were posted on the subject claim(s) or copies thereof were in place, and at said date, each corner monument bore or contained

markings sufficient to appropriately designate the corner of the claim to which it pertains and the name of the claim(s).

I hereby certify under penalty of perjury under the laws of the State of ARIZONA that the foregoing statements are true and correct:

[Signature]
(Signature of person responsible for above statement)

Date: 7/21/15

Title 18 U.S.C. 1001 and 43 U.S.C. 1212 make it a crime for any person knowingly and willfully to make to any department or agency of the United States any false, fictitious or fraudulent statements or representations as to any matter within its jurisdiction.

Notary Block

SUBSCRIBED AND SWORN TO before me, this 21st day of July 2015

By: [Signature]
(Signature of Affiant)

Title: [Signature]

My Commission Expires: June 20th 2018

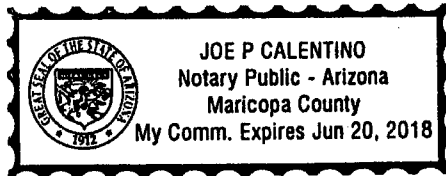

INSTRUCTIONS

1. This is an optional form that may be used to satisfy the requirements for the Bureau of Land Management (BLM) under the provisions of 43 U.S.C. §1744 and 30 U.S.C. §28-28d and the regulations thereunder (43 CFR part 3835). Since local and State laws may vary, you should contact your local and State agencies where the claims are located to ensure all applicable laws and requirements are satisfied.
2. The claimant(s) must fill in the date in paragraph 1 for the applicable assessment year and the county and state where the claims are located.
3. All claim names, BLM serial numbers, legal descriptions, and original county recording information must be listed for the claims pertaining to this assessment notice.
4. The claimant(s) must complete paragraph 2 listing all labor or improvements which was performed on or did benefit the subject mining claims. The value and date of the labor or improvements must also be listed. The total amount of labor or improvements can be listed, but the total expenditure must equal at least \$100 for each claim.
5. The names and current mailing addresses of the person(s) performing the labor shall be listed in paragraph 3.
6. The name and current mailing address of each owner (claimant) of the claims shall be listed in paragraph 4. The mailing address shall be the owner's address and not the address of an agent or anyone representing the claimant. Be sure to note if there has been a change of address.
7. Paragraph 5 shall be completed to show the date it was verified that all monuments required by law were properly erected, all notices were posted, and that corners were appropriately designated for all claims listed.
8. An exact legible reproduction or duplicate (other than microfilm or other electronic media) of this affidavit or another type of affidavit of assessment work that you file or will file in the county where each claim is located, must be filed with the BLM on or before December 30 of the calendar year in which the assessment year ends. For mill or tunnel sites, a separate notice of intent to hold must be filed with the BLM on or before December 30. Requirements for filing a notice of intent to hold can be found at 43 CFR 3835.33.
9. A processing fee of \$10 for each claim listed must be remitted to the BLM along with this or any other affidavit of assessment work.

PHOENIX, ARIZONA

2015 JUL 21 A 11:43

RECEIVED
BLM AZ STATE OFFICE

NOTICES

THE PRIVACY ACT and 43 CFR 2.48(d) require that you be furnished with the following information in connection with the information requested by this form.

AUTHORITY: 30 U.S.C. §28-28d and 43 CFR part 3835 permit collection of the information requested by this form.

PRINCIPAL PURPOSE: The BLM will use the information you provide to document compliance with 43 U.S.C. 1744 and that assessment work has been completed in accordance with 30 U.S.C. § 28-28d and 43 CFR part 3835 in lieu of paying the maintenance fee for the mining claims listed on this form.

ROUTINE USES: The BLM will only disclose this information in accordance with the provisions at 43 CFR 2.56(b) and (c).

EFFECT OF NOT PROVIDING INFORMATION: Disclosure of the requested information is required by 30 U.S.C. § 28-28d and 43 CFR part 3835 for claimants qualified to perform assessment work in lieu of paying the maintenance fee. Failure to submit all the requested information or to complete this form will delay the BLM's processing of the form and may preclude the BLM's acceptance of the assessment work information, which may result in forfeiture of the mining claim(s) by the claimant.

THE PAPERWORK REDUCTION ACT requires us to inform you that:

Use of this form is optional. You must perform assessment if a waiver to pay the maintenance fee has been requested. This form is provided to help you attest that annual assessment work has been completed in lieu of paying the maintenance fee for your claim(s). Submission of the requested information is necessary to obtain or retain a benefit.

You do not have to respond to this or any other Federal agency-sponsored information collection unless it displays a valid OMB control number.

BURDEN HOURS STATEMENT: The estimated public reporting burden for this form is 30 minutes per response, including the time for reviewing instructions, gathering and maintaining data, and completing and reviewing the form. You may submit comments regarding the burden estimate or any other aspect of this form to: U.S. Department of the Interior, Bureau of Land Management (1004-0114), Bureau Information Collection Clearance Officer (WO-630), 1849 C Street, N.W., Room 2134LM, Washington, D.C. 20240.

United States Department of the Interior
Bureau of Land Management
 LANDS/RECREATION & PLANNING
 ONE N CENTRAL AVE
 PHOENIX, AZ 85004 -2203
 Phone: 602-417-9200

Receipt

No: 3347311

Transaction #: 3445114	
Date of Transaction: 07/21/2015	
CUSTOMER:	
FRANK BURNS 5828 N SCOTTSDALE RD SCOTTSDALE, AZ 85253-5916 US	

LINE #	QTY	DESCRIPTION	REMARKS	UNIT PRICE	TOTAL
1	1.00	LOCATABLE MINERALS / MINING CLAIMS- NOT NEW-UNADJUD, ONE AUTH NO. ONLY / MINING CLAIM MONEY RECEIVED CASES: AMC318631/\$20.00	2016 WAIV & 2015 POL (2)	- n/a -	20.00
TOTAL:					\$20.00

PAYMENT INFORMATION			
NOTE: Items will appear on credit card statement as "Bureau of Land Mgmt CO".			
1	AMOUNT:	20.00	POSTMARKED: N/A
	TYPE:	CREDIT CARD	RECEIVED: 07/21/2015
	NAME:	BURNS, FRANK 5828 N SCOTTSDALE RD SCOTTSDALE AZ 85253-5916 US	
	CARD NO:	XXXXXXXXXXXX8901	AUTH CODE: 822948
	NAME ON CARD:	FRANKLIN L BURNS	
	EXPIRES:	10/2017	
	SIGNATURE:		

REMARKS

This receipt was generated by the automated BLM Collections and Billing System and is a paper representation of a portion of the official electronic record contained therein.

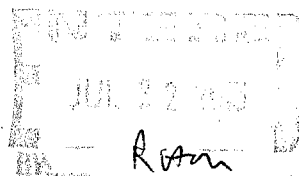

UNITED STATES
DEPARTMENT OF THE INTERIOR
BUREAU OF LAND MANAGEMENT

318630
386581

FORM APPROVED
OMB NO. 1004-0114
Expires: August 31, 2013

MAINTENANCE FEE WAIVER CERTIFICATION

SEE INSTRUCTIONS ON PAGE 2

1087
[Handwritten signature]

- This small miner waiver is filed for the assessment year beginning on September 1, 2014 and ending on September 1, 2015
- The undersigned and all related parties owned ten or fewer mining claims, mill, or tunnel sites located and maintained on Federal lands in the United States of America on September 1, 2014.
- The undersigned have performed the assessment work required by law for each mining claim listed prior to filing this waiver and understand that by filing this form, an affidavit of assessment work must be recorded by the December 30th following the filing of this waiver.
- The undersigned understand that if the assessment work obligation has not yet come due under 30 U.S.C. 28 (for those claims in their first assessment year only), a notice of intent to hold reciting this condition must be recorded by the December 30th following the filing of this waiver.
- The undersigned understand that mill and tunnel sites may also be listed upon this waiver and be waived from payment of the maintenance fee, and that a notice of intent to hold for these sites is required to be recorded by the December 30th immediately following the filing of this waiver.
- The undersigned understand and acknowledge that pursuant to 43 U.S.C. 1212 and 18 U.S.C. 1001, the filing or recording of a false, fictitious, or fraudulent document with the Bureau of Land Management may result in a fine of up to \$250,000, a prison term not to exceed five years, or both.
- The mining claims, mill or tunnel sites for which this waiver from payment of the maintenance fees is requested are:

CLAIM OR SITE NAME	BLM RECORDATION SERIAL NUMBER
1. <u>BLAND MINE # 22</u>	<u>AMC# 318631 ✓</u>
2. <u>DEBORAH SUE MINE</u>	<u>AMC# 386581</u>
3.	
4.	
5.	
6.	
7.	
8.	
9.	
10.	

The owner(s) (claimants) of the above mining claims and sites are:

FRANKLIN BURNS
(Owner's Name - Please Print)

5828 N. Scottsdale Rd
(Street or P.O. Box)

SCOTTSDALE AZ 85253
(City) (State) (Zip Code)

[Handwritten Signature]
(Owner's Signature)

(Owner's Name - Please Print)

(Street or P.O. Box)

(City) (State) (Zip Code)

(Owner's Name - Please Print)

(Street or P.O. Box)

(City) (State) (Zip Code)

(Owner's Signature)

RECEIVED
BLM AZ STATE OFFICE
2014 JUL 22 A 11:21
PHOENIX, ARIZONA

(Owner's Signature)

ENTERED
JUL 9 2014
BY: *[Handwritten Signature]*

STATE OFFICE RECEIVED

NWV
DE 9.15.14

(Owner's Name - Please Print)

(Owner's Signature)

(Street or P.O. Box)

(City)

(State)

(Zip Code)

(Owner's Name - Please Print)

(Owner's Signature)

(Street or P.O. Box)

(City)

(State)

(Zip Code)

(Owner's Name - Please Print)

(Owner's Signature)

(Street or P.O. Box)

(City)

(State)

(Zip Code)

(Owner's Name - Please Print)

(Owner's Signature)

(Street or P.O. Box)

(City)

(State)

(Zip Code)

Title 18 U.S.C. Section 1001 and Title 43 U.S.C. Section 1212 makes it a crime for any person knowingly and willfully to make to any department or agency of the United States any false, fictitious or fraudulent statements or representations as to any matter within its jurisdiction.

INSTRUCTIONS

1. This certification is made under the provisions of §1744 of Title 43 and § 28-28k of Title 30 of the United States Code; and the regulations thereunder (43 CFR Part 3830).
2. The claimant(s) must fill in the dates in paragraph 1 for the beginning and ending of the assessment year for which this waiver is sought.
3. The claimant(s) must fill in the date in paragraph 2 for the beginning of the assessment year for which this waiver is sought.
4. All claim and site names and Bureau of Land Management (BLM) serial numbers must be listed for the mining claims, mill sites, and tunnel sites for which the waiver is sought.
5. All owners of the mining claims, mill sites, and tunnel sites and their addresses must be given.
6. This waiver form must be signed by all the claimants or their designated agent, in original form. If an agent is designated, a notarized designation of agent, signed by all of the claimants with proper address given, must be submitted with this waiver.
7. This form must be filed no later than September 1st for the upcoming assessment year in the BLM State Office where the mining claims or sites are recorded, or the waiver cannot be granted by the BLM. (Example: To obtain a waiver for the assessment year 2012, which begins on September 1, 2011, you must qualify for and file for a waiver no later than September 1, 2011, in the proper BLM State Office.)
8. For all mining claims which require assessment work, you must record an affidavit of labor on or before the December 30th immediately following the filing of this waiver. For all other mining claims or sites waived, you must record a notice of intent to hold on or before the December 30th immediately following the filing of this waiver.
9. Mill and tunnel sites may also be listed upon this waiver and be waived from payment of the maintenance fee. A notice of intent to hold for these sites is required to be filed by the December 30th following the filing of this waiver.

BLM STATE OFFICE RECEIVED

JUL 22 11:51

PHOENIX, ARIZONA

2014 JUL 22 A 11: 21

RECEIVED BLM AZ STATE OFFICE

FOR OFFICIAL USE ONLY

When Recorded Return Document to:

AMC386581

FRANK BURNS
5828 N. SCOTTSDALE RD
SCOTTSDALE, ARIZONA 85253

Check here is this is a change of address.

Telephone: 602 570 8147

E-mail address: _____

AFFIDAVIT OF PERFORMANCE OF ANNUAL WORK

1. State of Arizona, County of YAVAPAI ss:

2. I (Name) FRANKLIN BURNS

3. Reside at (Address) 5828 N. SCOTTSDALE RD

City SCOTTSDALE County MARICOPA

State AZ Zip 85253 being duly sworn, depose and say that I am a citizen of the United States, more than eighteen years of age, and that all of the facts set forth in this affidavit, subject to the provisions and penalties of 18 U.S.C. 1001 pertaining to the filing of false, fictitious, or fraudulent statements with the United States, are true and correct according to the best of my knowledge, information and belief.

4. Owner's name and address (If not shown in Items 1-3 above). _____

5. That I am personally acquainted with the mining claim(s). The work and improvements were made by and at the expense of the owner(s) of said claim(s). Said contiguous group of claims, listed on this document, are situated in the

_____ (optional) Mining District; _____ County, Arizona.

Line No.	AMC NUMBER	CLAIM/SITE NAME	COUNTY RECORDER DATA (If available)	TWP	RNG	SEC
1	386581	DEBORAH SUEMINE		10N	2E	33
2						
3						
4						
5						
6						

RECEIVED
 AZ STATE OFFICE
 JUL 22 A 11:21
 PHOENIX, ARIZONA
 BLM
 Date
 Stamp

ENTERED
JUL 24 2014
BY: RAM

RECEIVED
BLM AZ STATE OFFICE
2014 JUL 22 A 11: 21
PHOENIX, ARIZONA
BLM
Date
Stamp

7					
8					
9					
10					

6. That between the dates starting at 12 o'clock noon on September 1, 20 14 and ending at 12 o'clock noon on September 1, 20 15 at least \$ 100.00 dollars worth of work and improvements were done and performed upon said claim(s) or upon one or more of a contiguous group of claims for the benefit of all, wholly or partly outside of a contiguous group of claims for the benefit of all, not including the location work.

7. That the following persons were employed to perform the work and improvements described herein: _____

Franklin Burns

8. That the work and improvements performed were: ROAD WORK BY HAND
REPAIR SIGNAGE, SORT'S HAUL ONE, COMPLETE STEEL BRT GRATE
OVER MINESHAFT

9. Dated: 7/22/14 Signature: [Signature]

SUBSCRIBED AND SWORN TO before me, a Notary Public, this 22nd day of July 20 14

By: Franklin Burns

Notary Public [Signature]

My Commission Expires 1-16-18

 **Dane Carini**
Notary Public
Maricopa County, Arizona
My Comm. Expires 01-16-18

Bureau of Land Management
Arizona State Office
www.az.blm.gov

No. of Claims: 2 x \$10 = 20
Check No.: CC Init. JMC
Receipt No.: 3082599
For BLM Use Only

Form: MCF108
Revised Jan. 2006
Page 2 of 2

AMC 318630

When Recorded Return Document to:

FRANK BURNS
5828 N. SCOTTSDALE RD
SCOTTSDALE ARIZONA 85253

Check here if this is a change of address.

Telephone: 602 570 8147

E-mail address: _____

AFFIDAVIT OF PERFORMANCE OF ANNUAL WORK

1. State of Arizona, County of YAVAPAI ss:

2. I (Name) FRANKLIN BURNS

3. Reside at (Address) 5828 N. SCOTTSDALE RD

City SCOTTSDALE County MARICOPA

State AZ Zip 85253 being duly sworn, depose and say that I am a citizen of the United States, more than eighteen years of age, and that all of the facts set forth in this affidavit, subject to the provisions and penalties of 18 U.S.C. 1001 pertaining to the filing of false, fictitious, or fraudulent statements with the United States, are true and correct according to the best of my knowledge, information and belief.

4. Owner's name and address (If not shown in Items 1-3 above). _____

RECEIVED
MAZ STATE OFFICE
2014 JUL 22 A 11:21
PHOENIX, ARIZONA
BLM
Date
Stamp

5. That I am personally acquainted with the mining claim(s). The work and improvements were made by and at the expense of the owner(s) of said claim(s). Said contiguous group of claims, listed on this document, are situated in the

(optional) Mining District; _____ County, Arizona.

Line No.	AMC NUMBER	CLAIM/SITE NAME	COUNTY RECORDER DATA (If available)	TWP	RNG	SEC
1	318631	BLAND MINE #22		10N	2E	29
2						
3						
4						
5						
6						

Form: MCF108
Revised Jan. 2006
Page 1 of 2

ENTERED
JUL 24 2014
BY: RAM

RECEIVED
BLM AZ STATE OFFICE

2014 JUL 22 A 11:21
PHOENIX, ARIZONA

BLM
Date
Stamp

7						
8						
9						
10						

6. That between the dates starting at 12 o'clock noon on September 1, 20 14 and ending at 12 o'clock noon on September 1, 20 15 at least \$ 1023 dollars worth of work and improvements were done and performed upon said claim(s) or upon one or more of a contiguous group of claims for the benefit of all, wholly or partly outside of a contiguous group of claims for the benefit of all, not including the location work.

7. That the following persons were employed to perform the work and improvements described herein: _____
FRANKLIN BURNS

8. That the work and improvements performed were: ROADWORK, HAUL ORE, CRUSH ORE, REPAIR FENCING & SIGNAGE, INSTALLING STEEL COVER OVER VERTICAL MINESHAFET

9. Dated: 7/22/14 Signature: [Signature]

SUBSCRIBED AND SWORN TO before me, a Notary Public, this 22 day of July 20 14

By: Franklin Burns

Notary Public [Signature]

My Commission Expires 1-16-18

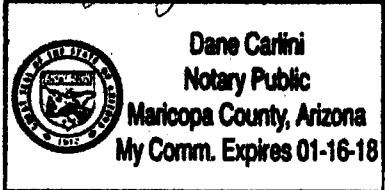

Bureau of Land Management
Arizona State Office
www.az.blm.gov

No. of Claims: _____ x \$10 = _____
 Check No.: _____ Init. _____
 Receipt No.: _____
 For BLM Use Only

United States Department of the Interior
Bureau of Land Management
 LANDS/RECREATION & PLANNING
 ONE N CENTRAL AVE
 PHOENIX, AZ 85004 -2203
 Phone: 602-417-9200

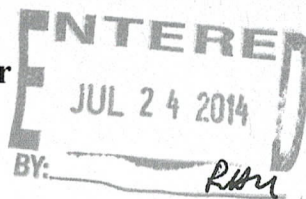

Receipt

No: 3082599

Transaction #: 3173891	
Date of Transaction: 07/22/2014	
CUSTOMER:	
FRANK BURNS 5828 N SCOTTSDALE RD SCOTTSDALE, AZ 85253-5916 US	

LINE #	QTY	DESCRIPTION	REMARKS	UNIT PRICE	TOTAL
1	1.00	LOCATABLE MINERALS / MINING CLAIMS- NOT NEW-UNADJUD, ONE AUTH NO. ONLY / MINING CLAIM MONEY RECEIVED CASES: AMC318631/\$20.00	POL 2014/2 WAV	- n/a -	20.00
TOTAL:					\$20.00

PAYMENT INFORMATION			
NOTE: Items will appear on credit card statement as "Bureau of Land Mgmt CO".			
1	AMOUNT:	20.00	POSTMARKED: N/A
	TYPE:	CREDIT CARD	RECEIVED: 07/22/2014
	NAME:	BURNS, FRANK 5828 N SCOTTSDALE RD SCOTTSDALE AZ 85253-5916 US	
	CARD NO:	XXXXXXXXXXXX8901	AUTH CODE: 011057
	NAME ON CARD:	FRANKLIN L BURNS	
	EXPIRES:	10/2014	
	SIGNATURE:		

REMARKS

This receipt was generated by the automated BLM Collections and Billing System and is a paper representation of a portion of the official electronic record contained therein.

UNITED STATES
DEPARTMENT OF THE INTERIOR
BUREAU OF LAND MANAGEMENT

MAINTENANCE FEE WAIVER CERTIFICATION

2/50

Amc 318630
FORM APPROVED
OMB NO. 1004-0114
Expires: August 31, 2013

244

Amc 386581

SEE INSTRUCTIONS ON PAGE 2

1. This small miner waiver is filed for the assessment year beginning on September 1, 2013 and ending on September 1, 2014.
2. The undersigned and all related parties owned ten or fewer mining claims, mill, or tunnel sites located and maintained on Federal lands in the United States of America on September 1, 2013.
3. The undersigned have performed the assessment work required by law for each mining claim listed prior to filing this waiver and understand that by filing this form, an affidavit of assessment work must be recorded by the December 30th following the filing of this waiver.
4. The undersigned understand that if the assessment work obligation has not yet come due under 30 U.S.C. 28 (for those claims in their first assessment year only), a notice of intent to hold reciting this condition must be recorded by the December 30th following the filing of this waiver.
5. The undersigned understand that mill and tunnel sites may also be listed upon this waiver and be waived from payment of the maintenance fee, and that a notice of intent to hold for these sites is required to be recorded by the December 30th immediately following the filing of this waiver.
6. The undersigned understand and acknowledge that pursuant to 43 U.S.C. 1212 and 18 U.S.C. 1001, the filing or recording of a false, fictitious, or fraudulent document with the Bureau of Land Management may result in a fine of up to \$250,000, a prison term not to exceed five years, or both.
7. The mining claims, mill or tunnel sites for which this waiver from payment of the maintenance fees is requested are:

CLAIM OR SITE NAME	BLM RECORDATION SERIAL NUMBER
1. BLAND MINE # 22	✓ AMC # 318631
2. DEBORAH SUE MINE	AMC # 386581
3.	
4.	
5.	
6.	
7.	
8.	
9.	
10.	

The owner(s) (claimants) of the above mining claims and sites are:

FRANKLIN BURNS ✓

(Owner's Name - Please Print)

5828 N. SCOTTSDALE RD

(Street or P.O. Box)

SCOTTSDALE

(City)

AZ

(State)

85253

(Zip Code)

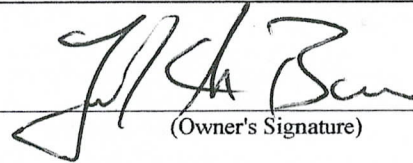

(Owner's Signature)

(Owner's Name - Please Print)

(Owner's Signature)

(Street or P.O. Box)

(City)

(State)

(Zip Code)

(Owner's Name - Please Print)

(Owner's Signature)

(Street or P.O. Box)

(City)

(State)

(Zip Code)

ENTERED INTO COMPUTER
SEP 18 2013 PB

(Owner's Name - Please Print)	(Owner's Signature)		
(Street or P.O. Box)	(City)	(State)	(Zip Code)
(Owner's Name - Please Print)	(Owner's Signature)		
(Street or P.O. Box)	(City)	(State)	(Zip Code)
(Owner's Name - Please Print)	(Owner's Signature)		
(Street or P.O. Box)	(City)	(State)	(Zip Code)
(Owner's Name - Please Print)	(Owner's Signature)		
(Street or P.O. Box)	(City)	(State)	(Zip Code)

Title 18 U.S.C. Section 1001 and Title 43 U.S.C. Section 1212 makes it a crime for any person knowingly and willfully to make to any department or agency of the United States any false, fictitious or fraudulent statements or representations as to any matter within its jurisdiction.

INSTRUCTIONS

1. This certification is made under the provisions of §1744 of Title 43 and § 28-28k of Title 30 of the United States Code; and the regulations thereunder (43 CFR Part 3830).
2. The claimant(s) must fill in the dates in paragraph 1 for the beginning and ending of the assessment year for which this waiver is sought.
3. The claimant(s) must fill in the date in paragraph 2 for the beginning of the assessment year for which this waiver is sought.
4. All claim and site names and Bureau of Land Management (BLM) serial numbers must be listed for the mining claims, mill sites, and tunnel sites for which the waiver is sought.
5. All owners of the mining claims, mill sites, and tunnel sites and their addresses must be given.
6. This waiver form must be signed by all the claimants or their designated agent, in original form. If an agent is designated, a notarized designation of agent, signed by all of the claimants with proper address given, must be submitted with this waiver.
7. This form must be filed no later than September 1st for the upcoming assessment year in the BLM State Office where the mining claims or sites are recorded, or the waiver cannot be granted by the BLM. (Example: To obtain a waiver for the assessment year 2012, which begins on September 1, 2011, you must qualify for and file for a waiver no later than September 1, 2011, in the proper BLM State Office.)
8. For all mining claims which require assessment work, you must record an affidavit of labor on or before the December 30th immediately following the filing of this waiver. For all other mining claims or sites waived, you must record a notice of intent to hold on or before the December 30th immediately following the filing of this waiver.
9. Mill and tunnel sites may also be listed upon this waiver and be waived from payment of the maintenance fee. A notice of intent to hold for these sites is required to be filed by the December 30th following the filing of this waiver.

RECEIVED
 BLM AZ STATE OFFICE
 2013 AUG 12 AM 4:44
 PHOENIX, ARIZONA
 FOR OFFICIAL USE ONLY.

When Recorded Return Document to:

FRANK BURNS
5828 N. SCOTTSDALE RD
SCOTTSDALE ARIZONA 85253

Check here is this is a change of address.

Telephone: _____

E-mail address: _____

AFFIDAVIT OF PERFORMANCE OF ANNUAL WORK

1. State of Arizona, County of YAVAPAI ss:

2. I (Name) FRANKLIN BURNS

3. Reside at (Address) 5828 N. SCOTTSDALE RD

City SCOTTSDALE County MARICOPA

State AZ Zip 85253 being duly sworn, depose and say that I am a citizen of the United States, more than eighteen years of age, and that all of the facts set forth in this affidavit, subject to the provisions and penalties of 18 U.S.C. 1001 pertaining to the filing of false, fictitious, or fraudulent statements with the United States, are true and correct according to the best of my knowledge, information and belief.

4. Owner's name and address (If not shown in Items 1-3 above) _____

5. That I am personally acquainted with the mining claim(s). The work and improvements were made by and at the expense of the owner(s) of said claim(s). Said contiguous group of claims, listed on this document, are situated in the

(optional) Mining District; YAVAPAI County, Arizona.

Line No.	AMC NUMBER	CLAIM/SITE NAME	COUNTY RECORDER DATA (If available)	TWP	RNG	SEC
1	318631	BLAND MINE 22		10N	2E	29
2						
3						
4						
5						
6						

RECEIVED
BLM AZ STATE OFFICE
2013 AUG 12 A 9:43
PHOENIX, ARIZONA

BLM
Date
Stamp

Form: MCF108
Revised: Jan. 2006
Page 1 of 2

ENTERED
SEP 03 2013
BY: AT

RECEIVED
BLM STATE OFFICE
2013 AUG 12 A 9:43
PHOENIX, ARIZONA
BLM
Date
Stamp

7						
8						
9						
10						

6. That between the dates starting at 12 o'clock noon on September 1, 20 13 and ending at 12 o'clock noon on September 1, 20 14 at least \$ 103⁰⁰ dollars worth of work and improvements were done and performed upon said claim(s) or upon one or more of a contiguous group of claims for the benefit of all, wholly or partly outside of a contiguous group of claims for the benefit of all, not including the location work.

7. That the following persons were employed to perform the work and improvements described herein: FRANKLIN BURNS

8. That the work and improvements performed were: ROAD WORK, HAUL ORE, CRUSH ORE, REPAIR FENCING & SIGNAGE, INSTALLING STEEL COVER OVER MINESHAFT

9. Dated: 8/9/13 Signature: Franklin Burns

SUBSCRIBED AND SWORN TO before me, a Notary Public, this 9th day of August 20 13

By: Franklin Lee Burns

Notary Public [Signature]

My Commission Expires 02/08/2016

Bureau of Land Management
Arizona State Office
www.az.blm.gov

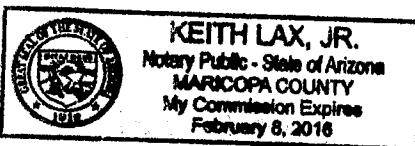

No. of Claims: 1 x \$10 = 10
Check No.: CC Init. SC
Receipt No.: 2852449
For BLM Use Only

Form: MCF108
Revised Jan. 2006
Page 2 of 2

When Recorded Return Document to:

FRANK BURNS
5828 N. SCOTTSDALE RD
SCOTTSDALE, ARIZONA 85253

Check here is this is a change of address.

Telephone: _____

E-mail address: _____

AFFIDAVIT OF PERFORMANCE OF ANNUAL WORK

1. State of Arizona, County of YAVAPAI ss:

2. I (Name) FRANKLIN BURNS

3. Reside at (Address) 5828 N. SCOTTSDALE RD

City SCOTTSDALE County MARICOPA

State AZ Zip 85253 being duly sworn, depose and say that I am a citizen of the United States, more than eighteen years of age, and that all of the facts set forth in this affidavit, subject to the provisions and penalties of 18 U.S.C. 1001 pertaining to the filing of false, fictitious, or fraudulent statements with the United States, are true and correct according to the best of my knowledge, information and belief.

4. Owner's name and address (If not shown in Items 1-3 above). _____

5. That I am personally acquainted with the mining claim(s). The work and improvements were made by and at the expense of the owner(s) of said claim(s). Said contiguous group of claims, listed on this document, are situated in the

(optional) Mining District; _____ County, Arizona.

Line No.	AMC NUMBER	CLAIM/SITE NAME	COUNTY RECORDER DATA (If available)	TWP	RNG	SEC
1	386581	DEBORAH SUE MINE		10N	2E	33
2						
3						
4						
5						
6						

RECEIVED
BLM AZ STATE OFFICE
2013 AUG 12 A 9:44
PHOENIX, ARIZONA

BLM
Date
Stamp

Form: MCF108

Revised Jan. 2006

Page 1 of 2

ENTERED
SEP 03 2013
BY: AT

RECEIVED
BLM AZ STATE OFFICE
PHOENIX, ARIZONA
2013 AUG 12 A 9:44
BLM
Date
Stamp

7					
8					
9					
10					

6. That between the dates starting at 12 o'clock noon on September 1, 20 13 and ending at 12 o'clock noon on September 1, 20 14 at least \$ 100 dollars worth of work and improvements were done and performed upon said claim(s) or upon one or more of a contiguous group of claims for the benefit of all, wholly or partly outside of a contiguous group of claims for the benefit of all, not including the location work.

7. That the following persons were employed to perform the work and improvements described herein: FRANKLIN BURNS

8. That the work and improvements performed were: ROAD WORK BY HAND, REPAIR SIGNAGE, SORT & HALL ORE, INSTALLING STEEL BAT CRATE OVER MINE SHAFT

9. Dated: 8/9/13 Signature: [Signature]

SUBSCRIBED AND SWORN TO before me, a Notary Public, this 9th day of August 20 13

By: Keith Franklin Lee Burns

Notary Public [Signature]

My Commission Expires 02/08/2016

Bureau of Land Management
Arizona State Office
www.az.blm.gov



No. of Claims: 1 x \$10 = 10
Check No.: CC Init. SC
Receipt No.: 2852449
For BLM Use Only

Form: MCF108
Revised Jan. 2006
Page 2 of 2

United States Department of the Interior
Bureau of Land Management
 LANDS/RECREATION & PLANNING
 ONE N CENTRAL AVE
 PHOENIX, AZ 85004 -2203
 Phone: 602-417-9200

Receipt

No: 2852449

Transaction #: 2938204	
Date of Transaction: 08/12/2013	
CUSTOMER:	
FRANK BURNS 5828 N SCOTTSDALE RD SCOTTSDALE, AZ 85253-5916 US	

LINE #	QTY	DESCRIPTION	REMARKS	UNIT PRICE	TOTAL
1	1.00	LOCATABLE MINERALS / MINING CLAIMS- NOT NEW-UNADJUD, ONE AUTH NO. ONLY / MINING CLAIM MONEY RECEIVED CASES: AMC386581/\$20.00	WAV 2014 & POL 2013 (2)	- n/a -	20.00
TOTAL:					\$20.00

PAYMENT INFORMATION			
NOTE: Items will appear on credit card statement as "Bureau of Land Mgmt CO".			
1	AMOUNT:	20.00	POSTMARKED: N/A
	TYPE:	CREDIT CARD	RECEIVED: 08/12/2013
	NAME:	BURNS, FRANK 5828 N SCOTTSDALE RD SCOTTSDALE AZ 85253-5916 US	
	CARD NO:	XXXXXXXXXXXX8901	AUTH CODE: 841553
	NAME ON CARD:	FRANKLIN BURNS	
	EXPIRES:	10/2014	
	SIGNATURE:		

REMARKS	

This receipt was generated by the automated BLM Collections and Billing System and is a paper representation of a portion of the official electronic record contained therein.

AMC 318630 2/50
AMC 386581
FORM APPROVED
OMB NO. 1004-0114 (165)
Expires: August 31, 2013

MAINTENANCE FEE WAIVER CERTIFICATION

SEE INSTRUCTIONS ON PAGE 2

- This small miner waiver is filed for the assessment year beginning on September 1, 2012 and ending on September 1, 2013
- The undersigned and all related parties owned ten or fewer mining claims, mill, or tunnel sites located and maintained on Federal lands in the United States of America on September 1, _____.
- The undersigned have performed the assessment work required by law for each mining claim listed prior to filing this waiver and understand that by filing this form, an affidavit of assessment work must be recorded by the December 30th following the filing of this waiver.
- The undersigned understand that if the assessment work obligation has not yet come due under 30 U.S.C. 28 (for those claims in their first assessment year only), a notice of intent to hold reciting this condition must be recorded by the December 30th following the filing of this waiver.
- The undersigned understand that mill and tunnel sites may also be listed upon this waiver and be waived from payment of the maintenance fee, and that a notice of intent to hold for these sites is required to be recorded by the December 30th immediately following the filing of this waiver.
- The undersigned understand and acknowledge that pursuant to 43 U.S.C. 1212 and 18 U.S.C. 1001, the filing or recording of a false, fictitious, or fraudulent document with the Bureau of Land Management may result in a fine of up to \$250,000, a prison term not to exceed five years, or both.
- The mining claims, mill or tunnel sites for which this waiver from payment of the maintenance fees is requested are:

CLAIM OR SITE NAME	BLM RECORDATION SERIAL NUMBER
1. <u>BLAND MINE # 22</u>	<u>318631</u>
2. <u>DEBORAH SUE MINE</u>	<u>386581</u>
3.	
4.	
5.	
6.	
7.	
8.	
9.	
10.	

The owner(s) (claimants) of the above mining claims and sites are:

FRANKLIN BURNS
(Owner's Name - Please Print) ✓
5828 N. SCOTTSDALE RD
(Street or P.O. Box)
Scottsdale AZ 85253
(City) (State) (Zip Code)

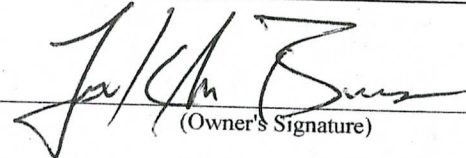
(Owner's Signature)

(Owner's Name - Please Print)

(Street or P.O. Box)

(City) (State) (Zip Code)

(Owner's Signature)

(Owner's Name - Please Print)

(Street or P.O. Box)

(City) (State) (Zip Code)

(Owner's Signature)

8/28/2012 TS
ENTERED INTO COMPUTER

(Owner's Name - Please Print)

(Owner's Signature)

(Street or P.O. Box)

(City)

(State)

(Zip Code)

(Owner's Name - Please Print)

(Owner's Signature)

(Street or P.O. Box)

(City)

(State)

(Zip Code)

(Owner's Name - Please Print)

(Owner's Signature)

(Street or P.O. Box)

(City)

(State)

(Zip Code)

(Owner's Name - Please Print)

(Owner's Signature)

(Street or P.O. Box)

(City)

(State)

(Zip Code)

Title 18 U.S.C. Section 1001 and Title 43 U.S.C. Section 1212 makes it a crime for any person knowingly and willfully to make to any department or agency of the United States any false, fictitious or fraudulent statements or representations as to any matter within its jurisdiction.

INSTRUCTIONS

1. This certification is made under the provisions of §1744 of Title 43 and § 28-28k of Title 30 of the United States Code; and the regulations thereunder (43 CFR Part 3830).
2. The claimant(s) must fill in the dates in paragraph 1 for the beginning and ending of the assessment year for which this waiver is sought.
3. The claimant(s) must fill in the date in paragraph 2 for the beginning of the assessment year for which this waiver is sought.
4. All claim and site names and Bureau of Land Management (BLM) serial numbers must be listed for the mining claims, mill sites, and tunnel sites for which the waiver is sought.
5. All owners of the mining claims, mill sites, and tunnel sites and their addresses must be given.
6. This waiver form must be signed by all the claimants or their designated agent, in original form. If an agent is designated, a notarized designation of agent, signed by all of the claimants with proper address given, must be submitted with this waiver.
7. This form must be filed no later than September 1st for the upcoming assessment year in the BLM State Office where the mining claims or sites are recorded, or the waiver cannot be granted by the BLM. (Example: To obtain a waiver for the assessment year 2012, which begins on September 1, 2011, you must qualify for and file for a waiver no later than September 1, 2011, in the proper BLM State Office.)
8. For all mining claims which require assessment work, you must record an affidavit of labor on or before the December 30th immediately following the filing of this waiver. For all other mining claims or sites waived, you must record a notice of intent to hold on or before the December 30th immediately following the filing of this waiver.
9. Mill and tunnel sites may also be listed upon this waiver and be waived from payment of the maintenance fee. A notice of intent to hold for these sites is required to be filed by the December 30th following the filing of this waiver.

RECEIVED
 BLM AZ STATE OFFICE
 2012 AUG - 8
 11:12
 PHOENIX, ARIZONA
 FOR OFFICIAL USE ONLY

When Recorded Return Document to:

FRANK BURNS
5828 N. Scottsdale Rd
Scottsdale AZ 85253

Check here is this is a change of address.

Telephone: _____

E-mail address: _____

AFFIDAVIT OF PERFORMANCE OF ANNUAL WORK

1. State of Arizona, County of YAVAPAI ss:

2. I (Name) FRANKLIN BURNS

3. Reside at (Address) 5828 N. Scottsdale Rd

City Scottsdale County MARICOPA

State AZ Zip 85253 being duly sworn, depose and say that I am a citizen of the United States, more than eighteen years of age, and that all of the facts set forth in this affidavit, subject to the provisions and penalties of 18 U.S.C. 1001 pertaining to the filing of false, fictitious, or fraudulent statements with the United States, are true and correct according to the best of my knowledge, information and belief.

4. Owner's name and address (if not shown in Items 1-3 above). _____

5. That I am personally acquainted with the mining claim(s). The work and improvements were made by and at the expense of the owner(s) of said claim(s). Said contiguous group of claims, listed on this document, are situated in the

(optional) Mining District; YAVAPAI County, Arizona.

RECEIVED
BLM AZ STATE OFFICE
2012 AUG - 8 A 11: 12
PHOENIX, ARIZONA
BLM
Date
Stamp

Line No.	AMC NUMBER	CLAIM/SITE NAME	COUNTY RECORDER DATA (If available)	TWP	RNG	SEC
1	318631	BLAND MINEZ		10N	2E	29
2						
3						
4						
5						
6						

BLM
Date
Stamp

2012 AUG - 8 A 11:12

PHOENIX, ARIZONA

RECEIVED
BLM AZ STATE OFFICE

7						
8						
9						
10						

6. That between the dates starting at 12 o'clock noon on September 1, 20 12 and ending at 12 o'clock noon on September 1, 20 13 at least \$ 100⁰⁰ dollars worth of work and improvements were done and performed upon said claim(s) or upon one or more of a contiguous group of claims for the benefit of all, wholly or partly outside of a contiguous group of claims for the benefit of all, not including the location work.

7. That the following persons were employed to perform the work and improvements described herein: _____
FRANKLIN BURNS

8. That the work and improvements performed were: ROAD WORK, HAUL ORE,
CRUSH ORE, Repair fencing, signage, install steel cover
over MINE SHAFT

9. Dated: 8/8/12 Signature: [Signature]

SUBSCRIBED AND SWORN TO before me, a Notary Public, this 8th day of August 20 12

By: [Signature]
Notary Public [Signature]
My Commission Expires Sept. 24, 2012

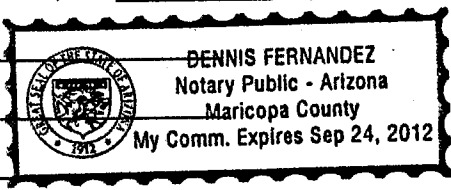

Bureau of Land Management
Arizona State Office
www.az.blm.gov

No. of Claims: 1 x \$10 = 10
Check No.: CC Init. SC
Receipt No.: 2625533
For BLM Use Only

When Recorded Return Document to:

FRANK BURNS
5828 N. Scottsdale Rd
Scottsdale AZ 85253

Check here is this is a change of address.

Telephone: _____

E-mail address: _____

AFFIDAVIT OF PERFORMANCE OF ANNUAL WORK

1. State of Arizona, County of YAVAPAI ss:

2. I (Name) FRANKLIN BURNS

3. Reside at (Address) 5828 N. Scottsdale Rd

City Scottsdale County Maricopa

State AZ zip 85253 being duly sworn, depose and say that I am a citizen of the United States, more than eighteen years of age, and that all of the facts set forth in this affidavit, subject to the provisions and penalties of 18 U.S.C. 1001 pertaining to the filing of false, fictitious, or fraudulent statements with the United States, are true and correct according to the best of my knowledge, information and belief.

4. Owner's name and address (If not shown in Items 1-3 above), _____

5. That I am personally acquainted with the mining claim(s). The work and improvements were made by and at the expense of the owner(s) of said claim(s). Said contiguous group of claims, listed on this document, are situated in the

_____ (optional) Mining District; _____ County, Arizona.

Line No.	AMC NUMBER	CLAIM/SITE NAME	COUNTY RECORDER DATA (If available)	TWP	RNG	SEC
1	386581	DEBORAH SUE MINE		10 N	2E	33
2						
3						
4						
5						
6						

RECEIVED
 BLM AZ STATE OFFICE
 2012 AUG - 8 A 11: 12
 PHOENIX, ARIZONA
 BLM
 Date
 Stamp

BLM
Date
Stamp

2012 AUG - 8 A 11:12
PHOENIX, ARIZONA

RECEIVED
BLM AZ STATE OFFICE

7					
8					
9					
10					

6. That between the dates starting at 12 o'clock noon on September 1, 20 12 and ending at 12 o'clock noon on September 1, 20 13 at least \$ 10.00 dollars worth of work and improvements were done and performed upon said claim(s) or upon one or more of a contiguous group of claims for the benefit of all, wholly or partly outside of a contiguous group of claims for the benefit of all, not including the location work.

7. That the following persons were employed to perform the work and improvements described herein: FRANKLIN BURNS

8. That the work and improvements performed were: ROAD WORK by HAND, Repair Fencing & SIGNAGE, SORT & HAUL ORE by HAND, Remove wooden Door & Replace with BAT GRATE

9. Dated: 8/8/12 Signature: [Signature]

SUBSCRIBED AND SWORN TO before me, a Notary Public, this 8th day of August 20 12

By: [Signature]
Notary Public
My Commission Expires Sept. 24, 2012

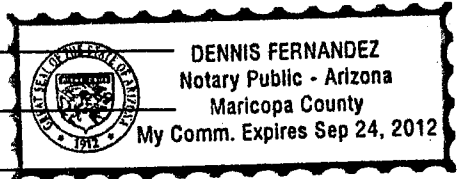

Bureau of Land Management
Arizona State Office
www.az.blm.gov

No. of Claims: 1 x \$10 = 10.00
Check No.: CC Init. SC
Receipt No.: 2625533
For BLM Use Only

United States Department of the Interior
Bureau of Land Management
LANDS/RECREATION & PLANNING
ONE N CENTRAL AVE
PHOENIX, AZ 85004 -2203
Phone: 602-417-9200

Receipt

No: 2625533

Transaction #: 2705940	
Date of Transaction: 08/08/2012	
CUSTOMER:	
FRANK BURNS 5828 N SCOTTSDALE RD SCOTTSDALE, AZ 85253-5916 US	

LINE #	QTY	DESCRIPTION	REMARKS	UNIT PRICE	TOTAL
1	1.00	LOCATABLE MINERALS / MINING CLAIMS-NOT NEW-UNADJUD, ONE AUTH NO. ONLY / MINING CLAIM MONEY RECEIVED CASES: AMC318631/\$20.00	WAVIER & POL (2)	- n/a -	20.00
TOTAL:					\$20.00

PAYMENT INFORMATION			
NOTE: Items will appear on credit card statement as "Bureau of Land Mgmt CO".			
1	AMOUNT:	20.00	POSTMARKED: N/A
	TYPE:	CREDIT CARD	RECEIVED: 08/08/2012
	NAME:	BURNS, FRANK 5828 N SCOTTSDALE RD SCOTTSDALE AZ 85253-5916 US	
	CARD NO:	XXXXXXXXXXXX8901	AUTH CODE: 040394
	NAME ON CARD:	FRANKLIN L BURNS FRANK HOME INS LLC	
	EXPIRES:	10/2014	
	SIGNATURE:		

REMARKS

This receipt was generated by the automated BLM Collections and Billing System and is a paper representation of a portion of the official electronic record contained therein.

UNITED STATES
DEPARTMENT OF THE INTERIOR
BUREAU OF LAND MANAGEMENT

AMC 386581
AM 318630

191

FORM APPROVED
OMB NO. 1004-0114
Expires: February 28, 2010

MAINTENANCE FEE WAIVER CERTIFICATION

SEE INSTRUCTIONS ON PAGE 2

1. This small miner waiver is filed for the assessment year beginning at noon on September 1, 2011 and ending at noon on September 1, 2012
2. The undersigned and all related parties owned ten or fewer mining claims, mill, or tunnel sites located and maintained on Federal lands in the United States of America on September 1, 2011.
3. The undersigned have performed the assessment work required by law for each mining claim listed prior to filing this waiver and understand that by filing this form; an affidavit of assessment work must be recorded by the December 30th following the filing of this waiver.
4. The undersigned understand that if the assessment work obligation has not yet come due under 30 U.S.C. 28 (for those claims in their first assessment year only); a notice of intent to hold reciting this condition must be recorded by the December 30th following the filing of this waiver.
5. The undersigned understand that mill and tunnel sites may also be listed upon this waiver and be waived from payment of the maintenance fee; and that a notice of intent to hold for these sites is required to be recorded by the December 30th immediately following the filing of this waiver.
6. The undersigned understand and acknowledge that pursuant to 43 U.S.C. 1212 and 18 U.S.C. 1001; the filing or recording of a false, fictitious, or fraudulent document with the Bureau of Land Management may result in a fine of up to \$250,000, a prison term not to exceed five years, or both.
7. The mining claims, mill or tunnel sites for which this waiver from payment of the maintenance fees is requested are:

CLAIM OR SITE NAME	BLM RECORDATION SERIAL NUMBER
1. <u>BLAND MINE # 22</u> ✓	<u>AMC # 318630 318631</u>
2. <u>DEBORAH SUE MINE</u>	<u>AMC # 386581</u>
3.	
4.	
5.	
6.	
7.	
8.	
9.	
10.	

The owner(s) (claimants) of the above mining claims and sites are:

FRANKLIN BURNS ✓
(Owner's Name - Please Print)

Franklin Burns
(Owner's Signature)

5828 N. Scottsdale Rd
(Street or P.O. Box)

Scottsdale AZ 85253
(City) (State) (Zip Code)

(Owner's Name - Please Print)

(Owner's Signature)

(Street or P.O. Box)

(City) (State) (Zip Code)

(Owner's Name - Please Print)

(Owner's Signature)

(Street or P.O. Box)

(City) (State) (Zip Code)

8/16/2011

ENTERED INTO COMPUTER

2/50

(Owner's Name - Please Print)

(Owner's Signature)

(Street or P.O. Box)

(City) (State) (Zip Code)

(Owner's Name - Please Print)

(Owner's Signature)

(Street or P.O. Box)

(City) (State) (Zip Code)

(Owner's Name - Please Print)

(Owner's Signature)

(Street or P.O. Box)

(City) (State) (Zip Code)

(Owner's Name - Please Print)

(Owner's Signature)

(Street or P.O. Box)

(City) (State) (Zip Code)

Title 18 U.S.C. Section 1001 and Title 43 U.S.C. Section 1212 makes it a crime for any person knowingly and willfully to make to any department or agency of the United States any false, fictitious or fraudulent statements or representations as to any matter within its jurisdiction.

INSTRUCTIONS

1. This certification is made under the provisions of §1744 of Title 43 and § 28-28k of Title 30 of the United States Code; and the regulations thereunder (43 CFR Part 3830).
2. The claimant(s) must fill in the dates in paragraph 1 for the beginning and ending of the assessment year for which this waiver is sought.
3. The claimant(s) must fill in the date in paragraph 2 for the beginning of the assessment year for which this waiver is sought.
4. All claim and site names and Bureau of Land Management (BLM) serial numbers must be listed for the mining claims, mill sites, and tunnel sites for which the waiver is sought.
5. All owners of the mining claims, mill sites, and tunnel sites and their addresses must be given.
6. This waiver form must be signed by all the claimants or their designated agent, in original form. If an agent is designated, a notarized designation of agent, signed by all of the claimants with proper address given, must be submitted with this waiver.
7. This form must be filed no later than September 1st for the upcoming assessment year in the BLM State Office where the mining claims or sites are recorded, or the waiver cannot be granted by the BLM. (Example: to obtain a waiver for the assessment year 2000, which begins at noon on September 1, 1999, you must qualify for and file for a waiver no later than September 1, 1999, in the proper BLM State Office).
8. For all mining claims which require assessment work, you must record an affidavit of labor on or before the December 30th immediately following the filing of this waiver. For all other mining claims or sites waived, you must record a notice of intent to hold on or before the December 30th immediately following the filing of this waiver.
9. Mill and tunnel sites may also be listed upon this waiver and be waived from payment of the maintenance fee. A notice of intent to hold for these sites is required to be filed by the December 30th following the filing of this waiver.

PHOENIX, ARIZONA

2011 AUG - 9 - 11: 27

RECEIVED
BLM AZ STATE OFFICE

FOR OFFICIAL USE ONLY

When Recorded Return Document to:

FRANK BURNS
5828 N. Scottsdale Rd
Scottsdale AZ 85253

Check here if this is a change of address

Telephone: _____

E-mail address: _____

AFFIDAVIT OF PERFORMANCE OF ANNUAL WORK

1. State of Arizona, County of YAVAPAI ss:

2. I (Name) FRANKLIN BURNS

3. Reside at (Address) 5828 N. Scottsdale Rd

City Scottsdale County MARICOPA

State AZ Zip 85253 being duly sworn, depose and say that I am a citizen of the United States, more than eighteen years of age, and that all of the facts set forth in this affidavit, subject to the provisions and penalties of 18 U.S.C. 1001 pertaining to the filing of false, fictitious, or fraudulent statements with the United States, are true and correct according to the best of my knowledge, information and belief.

4. Owner's name and address (if not shown in Items 1-3 above). _____

5. That I am personally acquainted with the mining claim(s). The work and improvements were made by and at the expense of the owner(s) of said claim(s). Said contiguous group of claims, listed on this document, are situated in the

(optional) Mining District; YAVAPAI County, Arizona.

Line No.	AMC NUMBER	CLAIM/SITE NAME	COUNTY RECORDER DATA (If available)	TWP	RNG	SEC
1	318631	BLAND MINE #22		10 N	2 E	29
2						
3						
4						
5						
6						

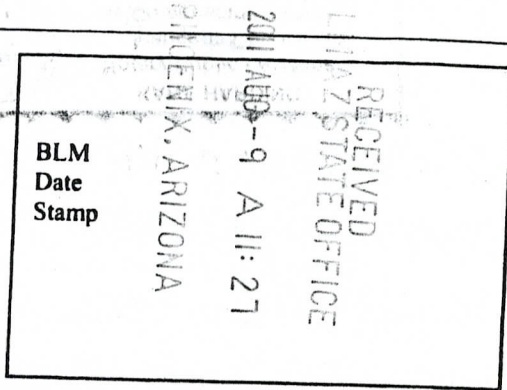

RECEIVED
MARICOPA STATE OFFICE
2011 AUG - 9 A 11: 21
PHOENIX, ARIZONA

BLM
Date
Stamp

7						
8						
9						
10						

6. That between the dates starting at 12 o'clock noon on September 1, 20 11 and ending at 12 o'clock noon on September 1, 20 12 at least \$ 100.00 dollars worth of work and improvements were done and performed upon said claim(s) or upon one or more of a contiguous group of claims for the benefit of all, wholly or partly outside of a contiguous group of claims for the benefit of all, not including the location work.

7. That the following persons were employed to perform the work and improvements described herein: _____

FRANKLIN BURNS

8. That the work and improvements performed were: ROAD WORK, HAUL ORE,

CRUSH ORE, Repair Fences, Repair Safety Cover

9. Dated: 8/9/11 Signature: [Signature]

SUBSCRIBED AND SWORN TO before me, a Notary Public, this 9 day of August 20 11

By: Franklin Burns
Notary Public Kara Harding

My Commission Expires 2/11/14

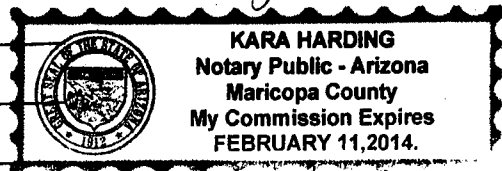

No. of Claims: 1 x \$10 = 10.00
Check No.: CASH Init. SC
Receipt No.: 2400280
For BLM Use Only

Bureau of Land Management
Arizona State Office
www.az.blm.gov

When Recorded Return Document to:

FRANK BURNS
5828 N. Scottsdale Rd
Scottsdale AZ 85253

Check here if this is a change of address.

Telephone: _____

E-mail address: _____

AFFIDAVIT OF PERFORMANCE OF ANNUAL WORK

1. State of Arizona, County of YAVAPAI ss:

2. I (Name) FRANKLIN BURNS

3. Reside at (Address) 5828 N. Scottsdale Rd

City Scottsdale County Maricopa

State AZ Zip 85253 being duly sworn, depose and say that I am a citizen of the United States, more than eighteen years of age, and that all of the facts set forth in this affidavit, subject to the provisions and penalties of 18 U.S.C. 1001 pertaining to the filing of false, fictitious, or fraudulent statements with the United States, are true and correct according to the best of my knowledge, information and belief.

4. Owner's name and address (if not shown in Items 1-3 above). _____

5. That I am personally acquainted with the mining claim(s). The work and improvements were made by and at the expense of the owner(s) of said claim(s). Said contiguous group of claims, listed on this document, are situated in the

(optional) Mining District; YAVAPAI County, Arizona.

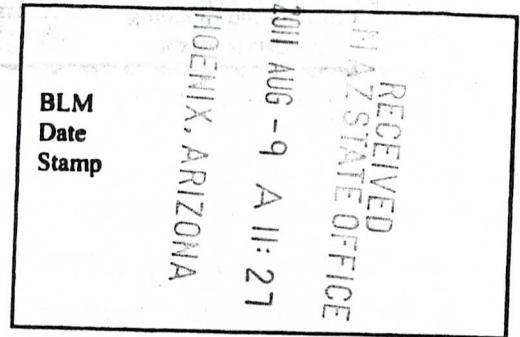

Line No.	AMC NUMBER	CLAIM/SITE NAME	COUNTY RECORDER DATA (If available)	TWP	RNG	SEC
1	386581	DEBORAH SUE MINE		10N	2E	33
2						
3						
4						
5						
6						

RECEIVED
 MARICOPA STATE OFFICE
 2011 AUG - 9 A 11: 27
 PHOENIX, ARIZONA
 BLM
 Date
 Stamp

7						
8						
9						
10						

6. That between the dates starting at 12 o'clock noon on September 1, 20 11 and ending at 12 o'clock noon on September 1, 20 12 at least \$ 100.00 dollars worth of work and improvements were done and performed upon said claim(s) or upon one or more of a contiguous group of claims for the benefit of all, wholly or partly outside of a contiguous group of claims for the benefit of all, not including the location work.

7. That the following persons were employed to perform the work and improvements described herein: FRANKLIN BURNS

8. That the work and improvements performed were: ROAD WORK BY HAND
FENCE REPAIRS, SIGNAGE, SORT ORE SAMPLES HAUL ORE BY HAND

9. Dated: 8/9/11 Signature: [Signature]

SUBSCRIBED AND SWORN TO before me, a Notary Public, this 9 day of August 20 11

By: Franklin Burns
 Notary Public Kara Harding
 My Commission Expires 2-11-14

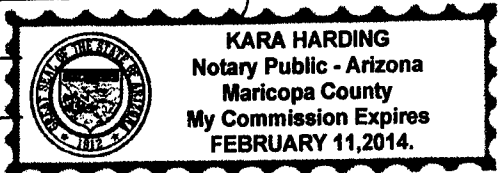

No. of Claims: 1 x \$10 = 10.00
 Check No.: CASH Init. SC
 Receipt No.: 2400280
 For BLM Use Only

Bureau of Land Management
 Arizona State Office
www.az.blm.gov

United States Department of the Interior
Bureau of Land Management
 LANDS/RECREATION & PLANNING
 ONE N CENTRAL AVE
 PHOENIX, AZ 85004 -2203
 Phone: 602-417-9200

Receipt

No: 2400280

Transaction #: 2475461	
Date of Transaction: 08/09/2011	
CUSTOMER:	
FRANK BURNS 5828 N SCOTTSDALE RD SCOTTSDALE, AZ 85253-5916 US	

LINE #	QTY	DESCRIPTION	REMARKS	UNIT PRICE	TOTAL
1	1.00	LOCATABLE MINERALS / MINING CLAIMS-NOT NEW-UNADJUD, ONE AUTH NO. ONLY / MINING CLAIM MONEY RECEIVED CASES: AMC318631/\$20.00	WAIVER & POL (2)	- n/a -	20.00
TOTAL:					\$20.00

PAYMENT INFORMATION					
1	AMOUNT:	20.00	POSTMARKED:	N/A	
	TYPE:	CASH	RECEIVED:	08/09/2011	
	NAME:	BURNS, FRANK 5828 N SCOTTSDALE RD SCOTTSDALE AZ 85253-5916 US			

REMARKS

This receipt was generated by the automated BLM Collections and Billing System and is a paper representation of a portion of the official electronic record contained therein.

AMC 317098
 AMC 318630
 AMC 315945
 AMC 334421
 AMC 386581

NOTICE OF INTENTION TO HOLD MINING CLAIMS/SITES

When Recorded Return Document to:

FRANK BURNS
5828 N. Scottsdale Rd
Scottsdale AZ 85253

RECEIVED
 BLM
 Date
 Stamp
 PHOENIX, ARIZONA
 2009 JUL 22 A 11:42
 LMAZ STATE OFFICE

Check here if this is a change of address.
 Telephone: _____
 E-mail Address _____

I (We) intend to hold the claims(s) and/or site(s) listed below for the calendar year 2009, and I (We) have filed or will file a Notice of Intent to Hold in the county where the claim (s) is located.

Reason for filing a Notice of Intent to Hold instead of an assessment work filing (check one):

- Maintenance fee was paid to maintain claim(s) during this assessment year.
- Mill or ~~summit~~ sites.
- Claim(s) was located during the current assessment year.
- BLM has deferred assessment work (attach copy of decision granting deferment, or pending petition for deferment including date petition was filed.)

Line No.	AMC NUMBER	CLAIM/SITE NAME	COUNTY RECORDER DATA (If available)	TWP	RNG	SEC
1	318631	BLAND Mine #22		10N	2E	29
2						
3						
4						
5						
6						
7						
8						
9						
10						

ENTERED IN...
 7/27/09 DJS
 8/14/09 RS (verified)

NOTICE OF INTENTION TO HOLD MINING CLAIMS/SITES
page 2

BLM Date Stamp	RECEIVED BLM STATE OFFICE PHOENIX, ARIZONA 2009 JUL 22 A M: 4:2
----------------------	--

1. State of Arizona, County of YAVAPAI
2. I (Name) FRANKLIN BURNS
3. Reside at (Address) 5828 N. Scottsdale Rd
City Scottsdale County Maricopa State AZ Zip 85253 being duly sworn, depose and say that I am a citizen of the United States, more than eighteen years of age, that all of the facts set forth in this notice, subject to the provisions and penalties of 18 U.S.C. 1001 pertaining to the filing of false, fictitious, or fraudulent statements with the United States, are true and correct according to the best of my knowledge, information and belief.
4. Owner's name and address (if not shown in Items 1-3 above). _____
5. Dated: 7/22/09 Signature: [Signature]

Bureau of Land Management
Arizona State Office
www.az.blm.gov

No. of Claims: <u>1</u> x \$10 = <u>10.00</u>
Check No: <u>CC</u> Init. <u>EBG</u>
Receipt No.: <u>1962026</u>
For BLM Use Only

When Recorded Return Document to:

FRANK BURNS
5828 N. Scottsdale Rd
Scottsdale AZ 85253

Check here is this is a change of address.

Telephone: _____

E-mail address: _____

AFFIDAVIT OF PERFORMANCE OF ANNUAL WORK

1. State of Arizona, County of YAVAPAI ss:

2. I (Name) FRANKLIN BURNS

3. Reside at (Address) 5828 N. Scottsdale Rd

City Scottsdale County Maricopa

State AZ Zip 85253 being duly sworn, depose and say that I am a citizen of the United States, more than eighteen years of age, and that all of the facts set forth in this affidavit, subject to the provisions and penalties of 18 U.S.C. 1001 pertaining to the filing of false, fictitious, or fraudulent statements with the United States, are true and correct according to the best of my knowledge, information and belief.

4. Owner's name and address (if not shown in Items 1-3 above). _____

RECEIVED
AZ STATE OFFICE
2009 JUL 22 A 11:40
PHOENIX, ARIZONA
BLM
Date
Stamp

5. That I am personally acquainted with the mining claim(s). The work and improvements were made by and at the expense of the owner(s) of said claim(s). Said contiguous group of claims, listed on this document, are situated in the

(optional) Mining District; YAVAPAI County, Arizona.

Line No.	AMC NUMBER	CLAIM/SITE NAME	COUNTY RECORDER DATA (if available)	TWP	RNG	SEC
1	315945	BLOND MINE # 1		10N	2E	29
2	315946	BLOND MINE # 2		10N	2E	29
3	315947	BLOND MINE # 3		10N	2E	29
4	317099	BLOND MINE # 8		10N	2E	29
5						
6						

RECEIVED
 BLM
 Date
 Stamp
 2009 JUL 22 AM 11:40
 PHOENIX, ARIZONA
 U.S. DEPARTMENT OF THE INTERIOR
 BUREAU OF LAND MANAGEMENT

7						
8						
9						
10						

6. That between the dates starting at 12 o'clock noon on September 1, 20 09 and ending at 12 o'clock noon on September 1, 20 10 at least \$ 100 dollars worth of work and improvements were done and performed upon said claim(s) or upon one or more of a contiguous group of claims for the benefit of all, wholly or partly outside of a contiguous group of claims for the benefit of all, not including the location work.

7. That the following persons were employed to perform the work and improvements described herein: Franklin Burns

8. That the work and improvements performed were: Road work by hand
Fence Repairs, Haul ore by hand

9. Dated: 7/22/09 Signature: [Signature]

SUBSCRIBED AND SWORN TO before me, a Notary Public, this 22nd day of July 2009

By: Franklin Burns

Notary Public Angelique Trezza

My Commission Expires October 6, 2012

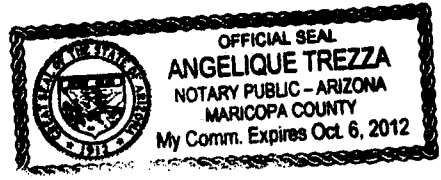

No. of Claims: 4 x \$10 = 40.00
 Check No.: CC Init. ET
 Receipt No.: _____
 For BLM Use Only

Bureau of Land Management
 Arizona State Office
www.az.blm.gov

When Recorded Return Document to:

FRANK BURNS
5828 N. Scottsdale Rd
Scottsdale, AZ 85253

Check here is this is a change of address.

Telephone: _____

E-mail address: _____

AFFIDAVIT OF PERFORMANCE OF ANNUAL WORK

1. State of Arizona, County of YAVAPAI ss:

2. I (Name) FRANKLIN BURNS

3. Reside at (Address) 5828 N. Scottsdale Rd

City Scottsdale County Maricopa

State AZ Zip 85253 being duly sworn, depose and say that I am a citizen of the United States, more than eighteen years of age, and that all of the facts set forth in this affidavit, subject to the provisions and penalties of 18 U.S.C. 1001 pertaining to the filing of false, fictitious, or fraudulent statements with the United States, are true and correct according to the best of my knowledge, information and belief.

4. Owner's name and address (if not shown in Items 1-3 above). _____

5. That I am personally acquainted with the mining claim(s). The work and improvements were made by and at the expense of the owner(s) of said claim(s). Said contiguous group of claims, listed on this document, are situated in the _____ (optional) Mining District; YAVAPAI County, Arizona.

RECEIVED
BLM AZ STATE OFFICE
2009 JUL 22 A 11:40
PHOENIX, ARIZONA
BLM
Date
Stamp

Line No.	AMC NUMBER	CLAIM/SITE NAME	COUNTY RECORDER DATA (If available)	TWP	RNG	SEC
1	334421	BLOND MINE #21		10N	2E	32
2						
3						
4						
5						
6						

BLM
Date
Stamp

2009 JUL 22 A 11:10
PHOENIX, ARIZONA

RECEIVED
MAY STATE OFFICE

7						
8						
9						
10						

6. That between the dates starting at 12 o'clock noon on September 1, 20 09 and ending at 12 o'clock noon on September 1, 20 10 at least \$ 1000 dollars worth of work and improvements were done and performed upon said claim(s) or upon one or more of a contiguous group of claims for the benefit of all, wholly or partly outside of a contiguous group of claims for the benefit of all, not including the location work.

7. That the following persons were employed to perform the work and improvements described herein: FRANKLIN BURNS

8. That the work and improvements performed were: ROAD work by hand, fence repairs, Haul one by hand

9. Dated: 7/22/09 Signature: [Signature]

SUBSCRIBED AND SWORN TO before me, a Notary Public, this 22nd day of July 2009

By: Franklin Burns

Notary Public Angelique Trezza

My Commission Expires October 6, 2012

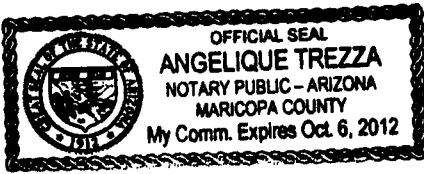

No. of Claims: 1 x \$10 = 10.00
 Check No.: CC Init. ETC
 Receipt No.: _____
 For BLM Use Only

Bureau of Land Management
 Arizona State Office
www.az.blm.gov

When Recorded Return Document to:

Frank Burns
5828 N Scottsdale Rd
Scottsdale, AZ 85253

Check here if this is a change of address.

Telephone: _____

E-mail address: _____

AFFIDAVIT OF PERFORMANCE OF ANNUAL WORK

1. State of Arizona, County of YAVAPAI ss:
2. I (Name) Franklin Burns
3. Reside at (Address) 5828 N Scottsdale Rd

RECEIVED
ALH AZ STATE OFFICE
2009 JUL 22 A 11:40
PHOENIX, ARIZONA
BLM
Date
Stamp

City Scottsdale County Maricopa

State AZ zip 85253 being duly sworn, depose and say that I am a citizen of the United States, more than eighteen years of age, and that all of the facts set forth in this affidavit, subject to the provisions and penalties of 18 U.S.C. 1001 pertaining to the filing of false, fictitious, or fraudulent statements with the United States, are true and correct according to the best of my knowledge, information and belief.

4. Owner's name and address (if not shown in Items 1-3 above), _____

5. That I am personally acquainted with the mining claim(s). The work and improvements were made by and at the expense of the owner(s) of said claim(s). Said contiguous group of claims, listed on this document, are situated in the

(optional) Mining District: YAVAPAI County, Arizona.

Line No.	AMC NUMBER	CLAIM/SITE NAME	COUNTY RECORDER DATA (if available)	TWP	RNG	SEC
1	386581	Deborah Sue Mine		10N	2E	33
2						
3						
4						
5						
6						

BLM
Date
Stamp

2009 JUL 22 A 11:40
PHOENIX, ARIZONA

RECEIVED
BLM AZ STATE OFFICE

7					
8					
9					
10					

6. That between the dates starting at 12 o'clock noon on September 1, 20 09 and ending at 12 o'clock noon on September 1, 20 10 at least \$ 100 dollars worth of work and improvements were done and performed upon said claim(s) or upon one or more of a contiguous group of claims for the benefit of all, wholly or partly outside of a contiguous group of claims for the benefit of all, not including the location work.

7. That the following persons were employed to perform the work and improvements described herein: FRANKLIN BURNS

8. That the work and improvements performed were: ROAD WORK BY HAND, FENCE OPEN SHAFT, HAUL ORE BY HAND

9. Dated: 7/22/09 Signature: [Signature]

SUBSCRIBED AND SWORN TO before me, a Notary Public, this 22nd day of JULY 2009

By: Franklin Burns

Notary Public: Angelique Trezza

My Commission Expires October 6, 2012

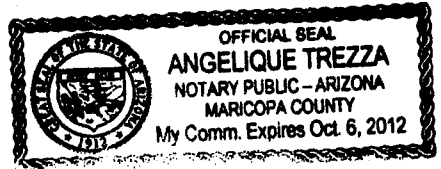

Bureau of Land Management
Arizona State Office
www.az.blm.gov

No. of Claims: 1 x \$10 = 10.00
 Check No.: CC Init. CC
 Receipt No.: _____
 For BLM Use Only

Form: MCF108
Revised Jan. 2006
Page 2 of 2

United States Department of the Interior
Bureau of Land Management
 BUSINESS & SUPPORT SVCS DIV
 ONE N CENTRAL AVE SUITE 800
 PHOENIX, AZ 85004 -4427
 Phone: (602) 417-9200

Receipt

No: 1962026

Transaction #: 2025772	
Date of Transaction: 07/22/2009	
CUSTOMER:	FRANKLIN BURNS 5828 N SCOTTSDALE RD SCOTTSDALE,AZ 85253-5916 US

LINE #	QTY	DESCRIPTION	REMARKS	UNIT PRICE	TOTAL
1	1.00	LOCATABLE MINERALS / MINING CLAIMS- NOT NEW-UNADJUD,ONE AUTH NO. ONLY / MINING CLAIM MONEY RECEIVED CASES: AMC318631/\$70.00	WAIVS & POL & NOI (6+1)	- n/a -	70.00
TOTAL:					\$70.00

PAYMENT INFORMATION				
NOTE: Items will appear on credit card statement as "Bureau of Land Mgmt CO".				
1	AMOUNT:	70.00	POSTMARKED:	N/A
	TYPE:	CREDIT CARD	RECEIVED:	07/22/2009
	NAME:	BURNS, FRANKLIN 5828 N SCOTTSDALE RD SCOTTSDALE AZ 85253-5916 US		
	CARD NO:	XXXXXXXXXXXX8901	AUTH CODE:	400212
	NAME ON CARD:	FRANKLIN L BURNS		
	EXPIRES:	10/2011		
	SIGNATURE:			

REMARKS

This receipt was generated by the automated BLM Collections and Billing System and is a paper representation of a portion of the official electronic record contained therein.

UNITED STATES
DEPARTMENT OF THE INTERIOR
BUREAU OF LAND MANAGEMENT

MAINTENANCE FEE WAIVER CERTIFICATION

SEE INSTRUCTIONS ON REVERSE

A = 318030 AMC 317098
315945
386581
334421

FORM APPROVED
OMB NO. 1004-0114
Expires: December 31, 2002

101

1. This small miner waiver is filed for the assessment year beginning at noon on September 1, 2009 and ending at noon on September 1, 2010
2. The undersigned and all related parties owned ten or fewer mining claims, mill, or tunnel sites located and maintained on Federal lands in the United States of America on September 1, 2009.
3. The undersigned have performed the assessment work required by law for each mining claim listed prior to filing this waiver and understand that by filing this form; an affidavit of assessment work must be recorded by the December 30th following the filing of this waiver.
4. The undersigned understand that if the assessment work obligation has not yet come due under 30 U.S.C. 28 (for those claims in their first assessment year only); a notice of intent to hold reciting this condition must be recorded by the December 30th following the filing of this waiver.
5. The undersigned understand that mill and tunnel sites may also be listed upon this waiver and be waived from payment of the maintenance fee; and that a notice of intent to hold for these sites is required to be recorded by the December 30th immediately following the filing of this waiver.
6. The undersigned understand and acknowledge that pursuant to 43 U.S.C. 1212 and 18 U.S.C. 1001; the filing or recording of a false, fictitious, or fraudulent document with the Bureau of Land Management may result in a fine of up to \$250,000, a prison term not to exceed five years, or both.
7. The mining claims, mill or tunnel sites for which this waiver from payment of the maintenance fees is requested are:

CLAIM OR SITE NAME	BLM RECORDATION SERIAL NUMBER
1. BLAND MINE # 1	AMC 315945
2. BLAND MINE # 2	AMC 315946
3. BLAND MINE # 3	AMC 315947
4. BLAND MINE # 8	AMC 317099
5. BLAND MINE # 21	AMC 334421
6. Deborah SWP MINE	AMC 386581
7.	
8.	
9.	
10.	

The owner(s) (claimants) of the above mining claims and sites are:

FRANKLIN BURNS
(Owner's Name - Please Print)
5828 N. Scottsdale Rd
(Street or P.O. Box)
Scottsdale AZ 85253
(City) (State) (Zip Code)

Franklin Burns
(Owner's Signature)

Paid Maintenance fee for 2010

(Owner's Name - Please Print)
(Street or P.O. Box)
(City) (State) (Zip Code)

(Owner's Signature)

(Owner's Name - Please Print)
(Street or P.O. Box)
(City) (State) (Zip Code)

(Owner's Signature)

PHOENIX, ARIZONA
RECEIVED
BLM AZ STATE OFFICE
2009 JUL 22 A 11:40

ENTERED INTO COMPUTER

7/27/09

(Owner's Name - Please Print)

(Owner's Signature)

(Street or P.O. Box)

(City)

(State)

(Zip Code)

(Owner's Name - Please Print)

(Owner's Signature)

(Street or P.O. Box)

(City)

(State)

(Zip Code)

(Owner's Name - Please Print)

(Owner's Signature)

(Street or P.O. Box)

(City)

(State)

(Zip Code)

(Owner's Name - Please Print)

(Owner's Signature)

(Street or P.O. Box)

(City)

(State)

(Zip Code)

INSTRUCTIONS

1. This certification is made under the provisions of § 1744 of Title 43 and § 28-28k of Title 30 of the United States Code; and the regulations thereunder (43 CFR Part 3830).
2. The claimant(s) **must** fill in the dates in paragraph 1 for the beginning and ending of the assessment year for which this waiver is sought.
3. The claimant(s) **must** fill in the date in paragraph 2 for the beginning of the assessment year for which this waiver is sought.
4. All claim and site names and Bureau of Land Management (BLM) serial numbers **must** be listed for the mining claims, mill sites, and tunnel sites for which the waiver is sought.
5. All owners of the mining claims, mill sites, and tunnel sites and their addresses **must** be given.
6. This waiver form **must** be signed by all the claimants or their designated agent, in original form. If an agent is designated, a notarized designation of agent, signed by all of the claimants with proper address given, **must** be submitted with this waiver.

7. This form **must** be filed no later than September 1st for the upcoming assessment year in the BLM State Office where the mining claims or sites are recorded, or the waiver cannot be granted by the BLM. (Example: to obtain a waiver for the assessment year 2000, which begins at noon on September 1, 1999, you **must** qualify for and file for a waiver no later than September 1, 1999 in the proper BLM State Office).
8. For all mining claims which require assessment work, you **must** record an affidavit of labor on or before the December 30th immediately following the filing of this waiver. For all other mining claims or sites waived, you **must** record a notice of intent to hold on or before the December 30th immediately following the filing of this waiver.
9. Mill and tunnel sites may also be listed upon this waiver and be waived from payment of the maintenance fee. A notice of intent to hold for these sites is required to be filed by the December 30th following the filing of this waiver.

NOTICE/BURDEN HOURS STATEMENT

The Privacy Act of 1974, *as amended*, and the regulation in 43 CFR 2.48(d) provide that you be furnished the following information in connection with the information required by this certification of waiver from rental fees.

AUTHORITY: 30 U.S.C. 28-28k; 43 U.S.C. 1201, 1457, 1740, and 1744; and 43 CFR 3830.

PRINCIPLE PURPOSE: This information is to be used to verify that the owner(s) (claimants) of a mining claim has complied with 30 U.S.C. 28f and is entitled to perform assessment work in lieu of paying the maintenance fee for the mining claims listed on this form.

ROUTINE USE: (1) Adjudication of the claimant(s) certification of waiver from paying the maintenance fee otherwise required by 30 U.S.C. 28f. (2) Disclosure may be made to appropriate Federal agencies when location is made within the agency's geographic area of responsibility. (3) Information from the record and/or the record will be transferred to the appropriate Federal, State, or local agency, or a member of the public in response to a specific request for pertinent information. (4) Information may also be provided to the Department of Justice or in a proceeding before a court or adjudicative body; or to Federal, State, local or foreign agencies when needed for enforcement of civil or criminal codes or applicable regulations concerning title rights upon the public land.

EFFECT OF NOT PROVIDING INFORMATION: Disclosure of this information is required by 30 U.S.C. 28f and 43 CFR Part 3830 for those qualified claimants wishing to take the small miner waiver allowed. Failure to supply the information required in this form to support the claimants certification of waiver from payment of the otherwise required maintenance fees will result in the waiver being disallowed and the mining claims subject to forfeiture by BLM under 30 U.S.C. 28i.

The Paperwork Reduction Act of 1995 requires us to inform you that:

This information is being collected to allow the BLM to determine if you qualify for a waiver from the payment of \$100 per mining claim or site maintenance fee established in 30 U.S.C. 28f and the implementing regulations at 43 CFR 3830. A response to this request is required in accordance with the statute to obtain your benefit.

BLM would like you to know that you do not have to respond to this, or any other, Federal agency-sponsored information collection unless it displays a currently valid OMB control number.

Public reporting burden for this form is estimated to average 8 minutes (0.133 hours) per response, including time to review instructions, gathering and maintaining data, and completing and reviewing the form. Direct comments regarding this burden estimate, or any other aspect of this form, to the U.S. Department of the Interior, Bureau of Land Management, (1004-0114) Bureau Clearance Officer (WO-630), Mail Stop 401 LS, 1849 C St., N.W., Washington, D.C. 20240.

PHOENIX, ARIZONA

2009 JUN 23 10:23 AM

RECEIVED
BLM AZ STATE OFFICE

United States Department of the Interior
Bureau of Land Management
 BUSINESS & SUPPORT SVCS DIV
 ONE N CENTRAL AVE SUITE 800
 PHOENIX, AZ 85004 -4427
 Phone: (602) 417-9200

Receipt

No: 1987055

Transaction #: 2051217	
Date of Transaction: 08/25/2009	
CUSTOMER:	AIMEE FLORES PO BOX 465 CROWN KING, AZ 86343-0465 US

LINE #	QTY	DESCRIPTION	REMARKS	UNIT PRICE	TOTAL
1	1.00	LOCATABLE MINERALS / MINING CLAIMS- NOT NEW-UNADJUD, ONE AUTH NO. ONLY / MINING CLAIM MONEY RECEIVED CASES: AMC317099/\$700.00	POL 2009/5 WAV	- n/a -	700.00
TOTAL:					\$700.00

PAYMENT INFORMATION					
1	AMOUNT:	700.00	POSTMARKED:	08/20/2009	
	TYPE:	CHECK	RECEIVED:	08/24/2009	
	CHECK NO:	4691			
	NAME:	FLORES, AIMEE H PO BOX 465 CROWN KING AZ 86343-0465 US			

REMARKS

This receipt was generated by the automated BLM Collections and Billing System and is a paper representation of a portion of the official electronic record contained therein.

317099
 315945
 315946 } check
 315947 } Tues
 334421 } 11/25
 ← on

08/24/09 same on file
~~refund #650~~
 loan \$700. 11/24/09

CBS Export Results Report

Include Resolved Records

Record Status

Search Criteria

Responsible Area (Errors Only)

Error Records (E/M/I)

Enter export Date (mm/dd/yyyy) ALL

User (U,X)

Accepted Records (A/W)

Serial Number match (optional)

Programmer (P,X)

"On Hold" Records (H)

Receipt Nr (optional) 1987055

All (U,P,X)

All Records (for s/n or receipt nr)

Export Nr (exclusive)

Exported, No Results From CBS

LR2000 User (defaults to login) ALL

New (not yet exported)

[User Guide](#)

Resend?	Export Nr	A/D	Serial Nr	Mult	Code	\$ Amount	Remarks	Receipt Nr	LR2000 User	#Msg	Resolved?	OK	Stat1	Area	CBS Msg 1	Stat2	Area	Msg 2	CBS :
<input type="checkbox"/>	2552118	A	AMC317099		480	10.00	2009	1987055	DJJONES	1	<input type="checkbox"/>		A		ACCPT				13744
<input type="checkbox"/>	2552119	A	AMC315945		480	10.00	2009	1987055	DJJONES	1	<input type="checkbox"/>		A		ACCPT				13744
<input type="checkbox"/>	2552120	A	AMC315946		480	10.00	2009	1987055	DJJONES	1	<input type="checkbox"/>		A		ACCPT				13744
<input type="checkbox"/>	2552121	A	AMC334421		480	10.00	2009	1987055	DJJONES	1	<input type="checkbox"/>		A		ACCPT				13744
<input type="checkbox"/>	2552122	A	AMC315947		480	10.00	2009	1987055	DJJONES	1	<input type="checkbox"/>		A		ACCPT				13744

UNITED STATES DEPARTMENT OF THE INTERIOR
BUREAU OF LAND MANAGEMENT

6/5c

AMC 318630

AMC 386581

FORM APPROVED
OMB NO. 1004-0114
Expires: February 28, 2010

AMC 315945 (435)

MAINTENANCE FEE WAIVER CERTIFICATION

SEE INSTRUCTIONS ON REVERSE

1. This small miner waiver is filed for the assessment year beginning at noon on September 1, ~~2007~~ and ending at noon on September 1, ~~2008~~.
2. The undersigned and all related parties owned ten or fewer mining claims, mill, or tunnel sites located and maintained on Federal lands in the United States of America on September 1, ~~2008~~.
3. The undersigned have performed the assessment work required by law for each mining claim listed prior to filing this waiver and understand that by filing this form; an affidavit of assessment work must be recorded by the December 30th following the filing of this waiver. AMC 317098
4. The undersigned understand that if the assessment work obligation has not yet come due under 30 U.S.C. 28 (for those claims in their first assessment year only); a notice of intent to hold reciting this condition must be recorded by the December 30th following the filing of this waiver. AMC 334421
5. The undersigned understand that mill and tunnel sites may also be listed upon this waiver and be waived from payment of the maintenance fee; and that a notice of intent to hold for these sites is required to be recorded by the December 30th immediately following the filing of this waiver.
6. The undersigned understand and acknowledge that pursuant to 43 U.S.C. 1212 and 18 U.S.C. 1001; the filing or recording of a false, fictitious, or fraudulent document with the Bureau of Land Management may result in a fine of up to \$250,000, a prison term not to exceed five years, or both.
7. The mining claims, mill or tunnel sites for which this waiver from payment of the maintenance fees is requested are:

CLAIM OR SITE NAME	BLM RECORDATION SERIAL NUMBER
1. BLAND MINE # 1	AMC 315945 ✓
2. BLAND MINE # 2	AMC 315946 ✓
3. BLAND MINE # 3	AMC 315947 ✓
4. BLAND MINE # 8	AMC 317099 ✓
5. BLAND MINE # 21	AMC 334421 ✓
6. DEBORAH SUE MINE	AMC 386581 ✓
7.	
8.	
9.	
10.	

The owner(s) (claimants) of the above mining claims and sites are:

FRANKLIN BURNS ✓

(Owner's Name - Please Print)

5828 N. SCOTTSDALE RD

(Street or P.O. Box)

Scottsdale

(City)

AZ

(State)

85253

(Zip Code)



(Owner's Signature)

(Owner's Name - Please Print)

(Street or P.O. Box)

(City)

(State)

(Zip Code)

(Owner's Signature)

(Owner's Name - Please Print)

(Street or P.O. Box)

(City)

(State)

(Zip Code)

(Owner's Signature)

RE 9/22/08
ENTERED IN COMPUTER

(Owner's Name - Please Print)	(Owner's Signature)
(Street or P.O. Box)	(City) (State) (Zip Code)
(Owner's Name - Please Print)	(Owner's Signature)
(Street or P.O. Box)	(City) (State) (Zip Code)
(Owner's Name - Please Print)	(Owner's Signature)
(Street or P.O. Box)	(City) (State) (Zip Code)
(Owner's Name - Please Print)	(Owner's Signature)
(Street or P.O. Box)	(City) (State) (Zip Code)

INSTRUCTIONS

1. This certification is made under the provisions of § 1744 of Title 43 and § 28-28k of Title 30 of the United States Code; and the regulations thereunder (43 CFR Part 3830).
2. The claimant(s) must fill in the dates in paragraph 1 for the beginning and ending of the assessment year for which this waiver is sought.
3. The claimant(s) must fill in the date in paragraph 2 for the beginning of the assessment year for which this waiver is sought.
4. All claim and site names and Bureau of Land Management (BLM) serial numbers must be listed for the mining claims, mill sites, and tunnel sites for which the waiver is sought.
5. All owners of the mining claims, mill sites, and tunnel sites and their addresses must be given.
6. This waiver form must be signed by all the claimants or their designated agent, in original form. If an agent is designated, a notarized designation of agent, signed by all of the claimants with proper address given, must be submitted with this waiver.
7. This form must be filed no later than September 1st for the upcoming assessment year in the BLM State Office where the mining claims or sites are recorded, or the waiver cannot be granted by the BLM. (Example: to obtain a waiver for the assessment year 2000, which begins at noon on September 1, 1999, you must qualify for and file for a waiver no later than September 1, 1999, in the proper BLM State Office).
8. For all mining claims which require assessment work, you must record an affidavit of labor on or before the December 30th immediately following the filing of this waiver. For all other mining claims or sites waived, you must record a notice of intent to hold on or before the December 30th immediately following the filing of this waiver.
9. Mill and tunnel sites may also be listed upon this waiver and be waived from payment of the maintenance fee. A notice of intent to hold for these sites is required to be filed by the December 30th following the filing of this waiver.

NOTICE/BURDEN HOURS STATEMENT

The Privacy Act of 1974, *as amended*, and the regulation in 43 CFR 2.48(d) provide that you be furnished the following information in connection with the information required by this certification of waiver from rental fees.

AUTHORITY: 30 U.S.C. 28-28k; 43 U.S.C. 1201, 1457, 1740, and 1744; and 43 CFR 3830.

PRINCIPLE PURPOSE: This information is to be used to verify that the owner(s) (claimants) of a mining claim has complied with 30 U.S.C. 28f and is entitled to perform assessment work in lieu of paying the maintenance fee for the mining claims listed on this form.

ROUTINE USE: (1) Adjudication of the claimant(s) certification of waiver from paying the maintenance fee otherwise required by 30 U.S.C. 28f. (2) Disclosure may be made to appropriate Federal agencies when location is made within the agency's geographic area of responsibility. (3) Information from the record and/or the record will be transferred to the appropriate Federal, State, or local agency, or a member of the public in response to a specific request for pertinent information. (4) Information may also be provided to the Department of Justice or in a proceeding before a court or adjudicative body; or to Federal, State, local or foreign agencies when needed for enforcement of civil or criminal codes or applicable regulations concerning title rights upon the public land.

EFFECT OF NOT PROVIDING INFORMATION: Disclosure of this information is required by 30 U.S.C. 28f and 43 CFR Part 3830 for those qualified claimants wishing to take the small miner waiver allowed. Failure to supply the information required in this form to support the claimants certification of waiver from payment of the otherwise required maintenance fees will result in the waiver being disallowed and the mining claims subject to forfeiture by BLM under 30 U.S.C. 28i.

The Paperwork Reduction Act of 1995 requires us to inform you that:

This information is being collected to allow the BLM to determine if you qualify for a waiver from the payment of \$100 per mining claim or site maintenance fee established in 30 U.S.C. 28f and the implementing regulations at 43 CFR 3830. A response to this request is required in accordance with the statute to obtain your benefit.

BLM would like you to know that you do not have to respond to this, or any other, Federal agency-sponsored information collection unless it displays a currently valid OMB control number.

Public reporting burden for this form is estimated to average 20 minutes (.33 hours) per response, including time to review instructions, gathering and maintaining data, and completing and reviewing the form. Direct comments regarding this burden estimate, or any other aspect of this form, to the U.S. Department of the Interior, Bureau of Land Management, (1004-0114) Bureau Information Collection Clearance Officer (WO-630), Mail Stop 401 LS, 1849 C St., N.W., Washington, DC 20540.

PHOENIX, ARIZONA
 RECEIVED
 BLM AZ STATE OFFICE
 2008 AUG 28 11:21
 FOR OFFICIAL USE ONLY

1/50

AMC 318630

MAINTENANCE FEE WAIVER CERTIFICATION

FORM APPROVED
OMB NO. 1004-0114
Expires: February 28, 2010

436

SEE INSTRUCTIONS ON REVERSE

1. This small miner waiver is filed for the assessment year beginning at noon on September 1, 08 and ending at noon on September 1, 09.
2. The undersigned and all related parties owned ten or fewer mining claims, mill, or tunnel sites located and maintained on Federal lands in the United States of America on September 1, 08.
3. The undersigned have performed the assessment work required by law for each mining claim listed prior to filing this waiver and understand that by filing this form; an affidavit of assessment work must be recorded by the December 30th following the filing of this waiver.
4. The undersigned understand that if the assessment work obligation has not yet come due under 30 U.S.C. 28 (for those claims in their first assessment year only); a notice of intent to hold reciting this condition must be recorded by the December 30th following the filing of this waiver.
5. The undersigned understand that mill and tunnel sites may also be listed upon this waiver and be waived from payment of the maintenance fee; and that a notice of intent to hold for these sites is required to be recorded by the December 30th immediately following the filing of this waiver.
6. The undersigned understand and acknowledge that pursuant to 43 U.S.C. 1212 and 18 U.S.C. 1001; the filing or recording of a false, fictitious, or fraudulent document with the Bureau of Land Management may result in a fine of up to \$250,000, a prison term not to exceed five years, or both.
7. The mining claims, mill or tunnel sites for which this waiver from payment of the maintenance fees is requested are:

CLAIM OR SITE NAME	BLM RECORDATION SERIAL NUMBER
1. <u>BLAND MINE #22</u>	<u>AMC 318631</u> ✓
2.	
3.	
4.	
5.	
6.	
7.	
8.	
9.	
10.	

The owner(s) (claimants) of the above mining claims and sites are:

FRANKLIN BURNS
(Owner's Name - Please Print)

5828 N. SCOTTSDALE RD
(Street or P.O. Box)

Scottsdale AZ 85253
(City) (State) (Zip Code)

(Owner's Signature)

(Owner's Name - Please Print)

(Street or P.O. Box)

(City) (State) (Zip Code)

(Owner's Signature)

(Owner's Name - Please Print)

(Street or P.O. Box)

(City) (State) (Zip Code)

(Owner's Signature)

(Owner's Name - Please Print)	(Owner's Signature)
(Street or P.O. Box)	(City) (State) (Zip Code)
(Owner's Name - Please Print)	(Owner's Signature)
(Street or P.O. Box)	(City) (State) (Zip Code)
(Owner's Name - Please Print)	(Owner's Signature)
(Street or P.O. Box)	(City) (State) (Zip Code)
(Owner's Name - Please Print)	(Owner's Signature)
(Street or P.O. Box)	(City) (State) (Zip Code)

INSTRUCTIONS

1. This certification is made under the provisions of § 1744 of Title 43 and § 28-28k of Title 30 of the United States Code; and the regulations thereunder (43 CFR Part 3830).
2. The claimant(s) must fill in the dates in paragraph 1 for the beginning and ending of the assessment year for which this waiver is sought.
3. The claimant(s) must fill in the date in paragraph 2 for the beginning of the assessment year for which this waiver is sought.
4. All claim and site names and Bureau of Land Management (BLM) serial numbers must be listed for the mining claims, mill sites, and tunnel sites for which the waiver is sought.
5. All owners of the mining claims, mill sites, and tunnel sites and their addresses must be given.
6. This waiver form must be signed by all the claimants or their designated agent, in original form. If an agent is designated, a notarized designation of agent, signed by all of the claimants with proper address given, must be submitted with this waiver.
7. This form must be filed no later than September 1st for the upcoming assessment year in the BLM State Office where the mining claims or sites are recorded, or the waiver cannot be granted by the BLM. (Example: to obtain a waiver for the assessment year 2000, which begins at noon on September 1, 1999, you must qualify for and file for a waiver no later than September 1, 1999, in the proper BLM State Office).
8. For all mining claims which require assessment work, you must record an affidavit of labor on or before the December 30th immediately following the filing of this waiver. For all other mining claims or sites waived, you must record a notice of intent to hold on or before the December 30th immediately following the filing of this waiver.
9. Mill and tunnel sites may also be listed upon this waiver and be waived from payment of the maintenance fee. A notice of intent to hold for these sites is required to be filed by the December 30th following the filing of this waiver.

NOTICE/BURDEN HOURS STATEMENT

The Privacy Act of 1974, *as amended*, and the regulation in 43 CFR 2.48(d) provide that you be furnished the following information in connection with the information required by this certification of waiver from rental fees.

AUTHORITY: 30 U.S.C. 28-28k; 43 U.S.C. 1201, 1457, 1740, and 1744; and 43 CFR 3830.

PRINCIPLE PURPOSE: This information is to be used to verify that the owner(s) (claimants) of a mining claim has complied with 30 U.S.C. 28f and is entitled to perform assessment work in lieu of paying the maintenance fee for the mining claims listed on this form.

ROUTINE USE: (1) Adjudication of the claimant(s) certification of waiver from paying the maintenance fee otherwise required by 30 U.S.C. 28f. (2) Disclosure may be made to appropriate Federal agencies when location is made within the agency's geographic area of responsibility. (3) Information from the record and/or the record will be transferred to the appropriate Federal, State, or local agency, or a member of the public in response to a specific request for pertinent information. (4) Information may also be provided to the Department of Justice or in a proceeding before a court or adjudicative body; or to Federal, State, local or foreign agencies when needed for enforcement of civil or criminal codes or applicable regulations concerning title rights upon the public land.

EFFECT OF NOT PROVIDING INFORMATION: Disclosure of this information is required by 30 U.S.C. 28f and 43 CFR Part 3830 for those qualified claimants wishing to take the small miner waiver allowed. Failure to supply the information required in this form to support the claimants certification of waiver from payment of the otherwise required maintenance fees will result in the waiver being disallowed and the mining claims subject to forfeiture by BLM under 30 U.S.C. 28i.

The Paperwork Reduction Act of 1995 requires us to inform you that: This information is being collected to allow the BLM to determine if you qualify for a waiver from the payment of \$100 per mining claim or site maintenance fee established in 30 U.S.C. 28f and the implementing regulations at 43 CFR 3830. A response to this request is required in accordance with the statute to obtain your benefit.

BLM would like you to know that you do not have to respond to this, or any other, Federal agency-sponsored information collection unless it displays a currently valid OMB control number.

Public reporting burden for this form is estimated to average 20 minutes (.33 hours) per response, including time to review instructions, gathering and maintaining data, and completing and reviewing the form. Direct comments regarding this burden estimate, or any other aspect of this form, to the U.S. Department of the Interior, Bureau of Land Management, (1004-0114) Bureau Information Collection Clearance Officer (WO-630), Mail Stop 401 LS, 1849 C St., N.W., Washington, D.C. 20240.

PHOENIX, ARIZONA

FOR OFFICIAL USE ONLY

RECEIVED

BLMAZ STATE OFFICE

2008 AUG 28 P 1:21

When Recorded Return Document to:

FRANK BURNS
5828 N. Scottsdale Rd
Scottsdale AZ 85253

Check here if this is a change of address.

Telephone: _____

E-mail address: _____

AFFIDAVIT OF PERFORMANCE OF ANNUAL WORK

1. State of Arizona, County of YAVAPAI ss:

2. I (Name) FRANKLIN BURNS

3. Reside at (Address) 5828 N. Scottsdale Rd

City SCOTTSDALE County MARICOPA

State AZ zip 85253 being duly sworn, depose and say that I am a citizen of the United States, more than eighteen years of age, and that all of the facts set forth in this affidavit, subject to the provisions and penalties of 18 U.S.C. 1001 pertaining to the filing of false, fictitious, or fraudulent statements with the United States, are true and correct according to the best of my knowledge, information and belief.

4. Owner's name and address (if not shown in Items 1-3 above). _____

5. That I am personally acquainted with the mining claim(s). The work and improvements were made by and at the expense of the owner(s) of said claim(s). Said contiguous group of claims, listed on this document, are situated in the

(optional) Mining District: YAVAPAI County, Arizona.

RECEIVED
BLM AZ STATE OFFICE
2008 AUG 28 P 1:20
PHOENIX, ARIZONA
BLM
Date
Stamp

Line No.	AMC NUMBER	CLAIM/SITE NAME	COUNTY RECORDER DATA (if available)	TWP	RNG	SEC
1	386581	DEBORAH SUE MINE		10N	2E	33
2						
3						
4						
5						
6						

RECEIVED
 BLM/STATE OFFICE
 PHOENIX, ARIZONA
 2008 AUG 28 P 1:20
 BLM
 Date
 Stamp

7					
8					
9					
10					

6. That between the dates starting at 12 o'clock noon on September 1, 20 08 and ending at 12 o'clock noon on September 1, 20 09 at least \$ 100.00 dollars worth of work and improvements were done and performed upon said claim(s) or upon one or more of a contiguous group of claims for the benefit of all, wholly or partly outside of a contiguous group of claims for the benefit of all, not including the location work.

7. That the following persons were employed to perform the work and improvements described herein: FRANKLIN BURNS

8. That the work and improvements performed were: ROAD work by hand
Fence Repairs Haul ore by hand

9. Dated: 8/28/08 Signature: [Signature]

SUBSCRIBED AND SWORN TO before me, a Notary Public, this 28 day of Aug 2008

By: Franklin Burns

Notary Public [Signature]

My Commission Expires March 31, 2012



Bureau of Land Management
 Arizona State Office
www.az.blm.gov

No. of Claims: 1 x \$10 = 10.00
 Check No.: CC Init. SC
 Receipt No.: 1774232
 For BLM Use Only

NOTICE OF INTENTION TO HOLD MINING CLAIMS/SITES

When Recorded Return Document to:

FRANK BURNS
5828 N. Scottsdale Rd
Scottsdale, AZ 85253

RECEIVED
 BLM AZ STATE OFFICE
 2008 AUG 28 P 1:20
 PHOENIX, ARIZONA
 BLM
 Date
 Stamp

Check here if this is a change of address.
 Telephone: _____
 E-mail Address _____

I (We) intend to hold the claims(s) and/or site(s) listed below for the calendar year 20____, and I (We) have filed or will file a Notice of Intent to Hold in the county where the claim (s) is located.

Reason for filing a Notice of Intent to Hold instead of an assessment work filing (check one):

- Maintenance fee was paid to maintain claim(s) during this assessment year.
- Mill or tunnel sites.
- Claim(s) was located during the current assessment year.
- BLM has deferred assessment work (attach copy of decision granting deferment, or pending petition for deferment including date petition was filed.)

Line No.	AMC NUMBER	CLAIM/SITE NAME	COUNTY RECORDER DATA (If available)	TWP	RNG	SEC
1	318631	BLAND MINE #22		10N	2E	29
2						
3						
4						
5						
6						
7						
8						
9						
10						

RECEIVED
BLM AZ STATE OFFICE
2008 AUG 28 P 1:21
PHOENIX, ARIZONA
BLM
Date
Stamp

1. State of Arizona, County of YAVAPAI
2. I (Name) FRANKLIN BURNS
3. Reside at (Address) 5828 N. Scottsdale RD

City Scottsdale County NAVAPHO State AZ Zip 85253 being duly sworn, depose and say that I am a citizen of the United States, more than eighteen years of age, that all of the facts set forth in this notice, subject to the provisions and penalties of 18 U.S.C. 1001 pertaining to the filing of false, fictitious, or fraudulent statements with the United States, are true and correct according to the best of my knowledge, information and belief.

4. Owner's name and address (If not shown in Items 1-3 above).

5. Dated: 8/28/08 Signature: [Handwritten Signature]

Bureau of Land Management
Arizona State Office
www.az.blm.gov

No. of Claims: 1 x \$¹⁰ = 10⁰⁰
Check No: RC Init. SC
Receipt No.: 1774232
For BLM Use Only

When Recorded Return Document to:

FRANK BURNS
5828 N. Scottsdale Rd
Scottsdale AZ 85253

Check here is this is a change of address.

Telephone: _____

E-mail address: _____

AFFIDAVIT OF PERFORMANCE OF ANNUAL WORK

- 1. State of Arizona, County of YAVAPAI ss:
- 2. I (Name) FRANKLIN BURNS
- 3. Reside at (Address) 5828 N. Scottsdale Rd

City Scottsdale County Maricopa

State AZ Zip 85253 being duly sworn, depose and say that I am a citizen of the United States, more than eighteen years of age, and that all of the facts set forth in this affidavit, subject to the provisions and penalties of 18 U.S.C. 1001 pertaining to the filing of false, fictitious, or fraudulent statements with the United States, are true and correct according to the best of my knowledge, information and belief.

4. Owner's name and address (if not shown in items 1-3 above) _____

5. That I am personally acquainted with the mining claim(s). The work and improvements were made by and at the expense of the owner(s) of said claim(s). Said contiguous group of claims, listed on this document, are situated in the

(optional) Mining District: YAVAPAI County, Arizona.

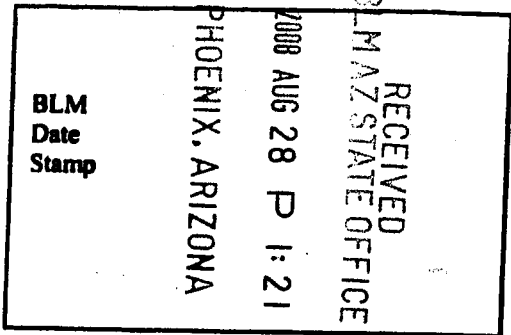

Line No.	AMC NUMBER	CLAIM/SITE NAME	COUNTY RECORDER DATA (if available)	TWP	RNG	SEC
1	334421	BLAND MINE #21		10N	2E	32
2						
3						
4						
5						
6						

RECEIVED
BLM AZ STATE OFFICE
2008 AUG 28 P 1:2
PHOENIX, ARIZONA
BLM
Date
Stamp

7						
8						
9						
10						

6. That between the dates starting at 12 o'clock noon on September 1, 20 08 and ending at 12 o'clock noon on September 1, 20 09 at least \$ 100.00 dollars worth of work and improvements were done and performed upon said claim(s) or upon one or more of a contiguous group of claims for the benefit of all, wholly or partly outside of a contiguous group of claims for the benefit of all, not including the location work.

7. That the following persons were employed to perform the work and improvements described herein: FRANKLIN BURNS

8. That the work and improvements performed were: ROAD WORK, FENCE REPAIRS
HAUL ORE BY HAND

9. Dated: 8/28/08 Signature: [Signature]

SUBSCRIBED AND SWORN TO before me, a Notary Public, this 28 day of Aug 2008

By: Franklin Burns

Notary Public [Signature]

My Commission Expires March 31, 2012

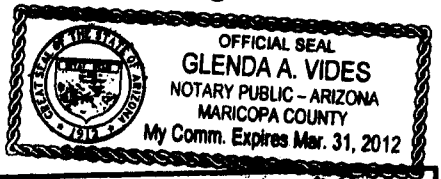

Bureau of Land Management
Arizona State Office
www.az.blm.gov

No. of Claims: 1 x \$10 = 10.00
 Check No.: [Signature] Init. SC
 Receipt No.: 1774232
 For BLM Use Only

When Recorded Return Document to:

FRANK BURNS
5828 N. Scottsdale Rd
Scottsdale AZ 85253

Check here if this is a change of address.

Telephone: _____

E-mail address: _____

AFFIDAVIT OF PERFORMANCE OF ANNUAL WORK

- 1. State of Arizona, County of YAVAPAI ss:
- 2. I (Name) FRANKLIN BURNS
- 3. Reside at (Address) 5828 N. Scottsdale Rd

City Scottsdale County Moricopa

State AZ zip 85253 being duly sworn, depose and say that I am a citizen of the United States, more than eighteen years of age, and that all of the facts set forth in this affidavit, subject to the provisions and penalties of 18 U.S.C. 1001 pertaining to the filing of false, fictitious, or fraudulent statements with the United States, are true and correct according to the best of my knowledge, information and belief.

4. Owner's name and address (if not shown in Items 1-3 above). _____

5. That I am personally acquainted with the mining claim(s). The work and improvements were made by and at the expense of the owner(s) of said claim(s). Said contiguous group of claims, listed on this document, are situated in the

(optional) Mining District; YAVAPAI County, Arizona.

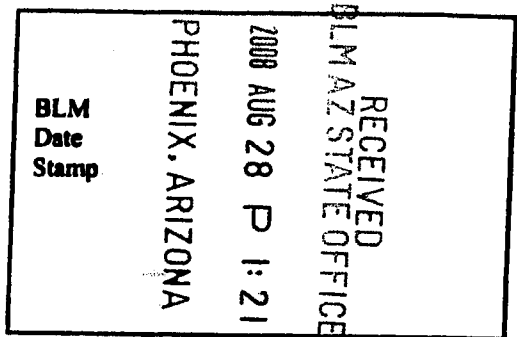

Line No.	AMC NUMBER	CLAIM/SITE NAME	COUNTY RECORDER DATA (if available)	TWP	RNG	SEC
1	315945	BLAND MINE #1		10N	2E	29
2	315946	BLAND MINE #2		10N	2E	29
3	315947	BLAND MINE #3		10N	2E	29
4	317099	BLAND MINE #8		10N	2E	29
5						
6						

RECEIVED
BLM AZ STATE OFFICE
2008 AUG 28 P 1:21
PHOENIX, ARIZONA
BLM
Date
Stamp

7					
8					
9					
10					

6. That between the dates starting at 12 o'clock noon on September 1, 20 08 and ending at 12 o'clock noon on September 1, 20 09 at least \$ 10000 dollars worth of work and improvements were done and performed upon said claim(s) or upon one or more of a contiguous group of claims for the benefit of all, wholly or partly outside of a contiguous group of claims for the benefit of all, not including the location work.

7. That the following persons were employed to perform the work and improvements described herein: FRANKLIN BURNS

8. That the work and improvements performed were: ROAD WORK by hand,
Fence Repairs, Haul ORE by hand

9. Dated: 8/28/08 Signature: [Signature]

SUBSCRIBED AND SWORN TO before me, a Notary Public, this 28 day of Aug 20 08

By: Franklin Burns

Notary Public [Signature]

My Commission Expires March 31, 2012

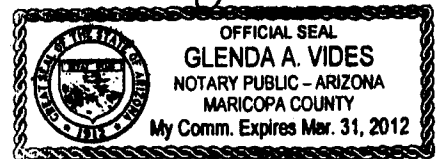

Bureau of Land Management
Arizona State Office
www.az.blm.gov

No. of Claims: 4 x \$10 = 4000
Check No.: [Signature] Init. SC
Receipt No.: 1774232
For BLM Use Only

United States Department of the Interior
Bureau of Land Management
 BUSINESS & SUPPORT SVCS DIV
 ONE N CENTRAL AVE SUITE 800
 PHOENIX, AZ 85004 -4427
 Phone: (602) 417-9200

Receipt

No: 1774232

Transaction #: 1831973	
Date of Transaction: 08/28/2008	
CUSTOMER:	FRANKLIN BURNS 5828 N SCOTTSDALE RDQ SCOTTSDALE, AZ 85253

LINE #	QTY	DESCRIPTION	REMARKS	UNIT PRICE	TOTAL
1	1.00	LOCATABLE MINERALS / MINING CLAIMS-NOT NEW-UNADJUD, ONE AUTH NO. ONLY / MINING CLAIM MONEY RECEIVED (455) CASES: AMC315945/\$70.00	POL WAVIER (7)	- n/a -	70.00
TOTAL:					\$70.00

PAYMENT INFORMATION				
NOTE: Items will appear on credit card statement as "Bureau of Land Mgmt CO".				
1	AMOUNT:	\$70.00	POSTMARKED:	N/A
	TYPE:	CREDIT CARD	RECEIVED:	08/28/2008
	NAME:	BURNS, FRANKLIN 5828 N SCOTTSDALE RDQ SCOTTSDALE AZ 85253		
	CARD NO:	XXXXXXXXXXXX8901	AUTH CODE:	475436
	NAME ON CARD:	FRANKLIN L BURNS FRANK HOME INS LLC		
	EXPIRES:	10/31/2008		
	SIGNATURE:			

REMARKS

This receipt was generated by the automated BLM Collections and Billing System and is a paper representation of a portion of the official electronic record contained therein.

NOTICE!!

These documents have been scanned!

Do not place un-scanned documents beneath this notice!

Do not remove this notice from this file!

GPO Jacket No. 560-102
Print Order 61540
Rise Business Services, LLC
Job=AZ15 5/23/2019



Box Number= AZ15087



Claim Begin-End: AMC386581-AMC386581

5 Miscellaneous



AZ15087-15

AMC385403-AMC386592

Franklin Burns

From: <Kirk_Rentmeister@blm.gov>
To: <desertfever@msn.com>
Sent: Friday, October 19, 2007 1:29 PM
Subject: Claim in T10N, R2E, Section 33

Frank,

Have reviewed what you sent to Matt Plis, Mining Engineer, Lower Sonoran Field Office, Phoenix District. I have also went to our records (Master Title Plats) and this is what I have found. On 11/9/1929 Mr William J. Martin received patent to 320 acres located in T10N, R2E Section 33, under the Stock Raising Homestead Act of 1916, and minerals were reserved. This surface was reconveyed to the Federal Government, there for BLM has the surface and the minerals there is no reason to file a NOI because the BLM has both the surface and the mineral in the area were you want to stake a claim. Now there maybe something that I am not aware of but form the MTP's there is no reason that you can not locate a claim at the location were you have indicated on the map.

Thanks,
Kirk N. Rentmeister
Lead Geologist, CME 0143
BLM, Hassayampa Field Office
Phone: 623-580-5524
Email: Kirk_Rentmeister@blm.gov

AMC 386581

RECEIVED
B.L.M. AZ STATE OFFICE
2007 OCT 23 P 12: 33
PHOENIX, AZ

10/19/2007

NOTICE!!

These documents have been scanned!

Do not place un-scanned documents beneath this notice!

Do not remove this notice from this file!

GPO Jacket No. 560-102
Print Order 61540
Rise Business Services, LLC
Job=AZ15 5/23/2019



Box Number= AZ15087



Claim Begin-End: AMC386581-AMC386581

6 Location Notices-Amendments and Supporting Documents



AZ15087-15

AMC385403-AMC386592

MINING CLAIM STATUS REPORT

DATA ENTRY TR

MTP CHECKED BY TR
GEO CHECKED BY TR

LEAD SERIAL NO. AMC 386581 THROUGH AMC

# <u>1</u> LODE	LOCATION FEE @ \$30 =	\$ <u>30</u>
# <u> </u> PLACER	PROCESSING FEE @ \$15 =	\$ <u>15</u>
# <u> </u> ASSOCIATION PL	MAINTENANCE FEE @ \$125 =	\$ <u>125</u>
# <u> </u> MILL SITE	OVERAGE	\$ <u> </u>
# <u> </u> TUNNEL SITE	SHORTAGE	\$ <u> </u>
	OTHER FEES	\$ <u> </u>
	TOTAL	\$ <u>170</u> ⁰⁰ <i>ok</i>

ENOUGH LOCATORS YES NO

OVER-THE-COUNTER MAIL TIMELY FILED: YES NO

LEGAL DESCRIPTION: T 10N R 02E SEC 33

T R SEC

T R SEC

T R SEC

BLM FOREST SERVICE SUBJ TO PL 359: YES NO

WILDERNESS AREA: NO YES

SPLIT ESTATE: SX PX SRHA OTHER N/A
PROPER NOTICE FILED IF LOCATED ON SRHA LANDS-YES NO N/A

RECONVEYED MINERALS ON BLM LANDS REQUIRE OPENING ORDERS FROM 1944 TO 1993. OPEN TO ENTRY ON: N/A

COMMENTS/STATUS: VOID PARTIALLY VOID PVT MINERALS
WITHDRAWN LANDS OTHER

A22792-B - WD Recon - 12-16-1988

No opening Order, However, minerals have always been Federal.

11-9-1929, patent 1031935 (SRHA)

All min

Claimant acknowledges that portions of the following claim(s) site(s) may be void or voidable.

Signature of claimant
FINAL ADJUDICATION TR DATE 3-18-08

Input Parameters for Geographic Report with Land

System Id = CR

Admin State = AZ

Geo State =

Casetype Begins With

Case Disp Txt = AUTHORIZED, CANCELLED, EXPIRED, PENDING, REJECTED, RELINQUISHED, VOID, WITHDRAWN

Mer Twp Rng =

Section =

Mtrs = 14 0100N 0020E 033

Commodity =

Commodity Txt =

Pending Org =

Pend Org Decode =

Total Rows Returned: 21

RUN TIME: 12:17 PM

UNITED STATES DEPARTMENT OF INTERIOR
BUREAU OF LAND MANAGEMENT
GEOGRAPHIC REPORT WITH LAND
Sorted by Serial Number

RUN DATE: 03/18/2008

Page 1 of 4

Adm State: AZ

Serial Number: AZA 019323

Total Case Acres: 82.000

<u>Casetype</u>	<u>Case Disp</u>			<u>Sect</u>	<u>Sur Typ</u>	<u>Sur Num</u>	<u>Suff</u>	<u>Subdivision</u>	<u>Act Pend</u>
282201	AUTHORIZED	14	0100N	0020E	033	ALIQ MNR	1	NE,SW; NWNWNWSE;	

Serial Number: AZA 022792BP

Total Case Acres: 7,891.200

<u>Casetype</u>	<u>Case Disp</u>			<u>Sect</u>	<u>Sur Typ</u>	<u>Sur Num</u>	<u>Suff</u>	<u>Subdivision</u>	<u>Act Pend</u>
220100	AUTHORIZED	14	0100N	0020E	033	FF	1	E2,E2W2,EXCEPT M&B;	

Serial Number: AZA 02370023

Total Case Acres: 36,822.550

<u>Casetype</u>	<u>Case Disp</u>			<u>Sect</u>	<u>Sur Typ</u>	<u>Sur Num</u>	<u>Suff</u>	<u>Subdivision</u>	<u>Act Pend</u>
221005	AUTHORIZED	14	0100N	0020E	033	ALIQ		SWSW;	

Serial Number: AZA 027224

Total Case Acres: 0.370

<u>Casetype</u>	<u>Case Disp</u>			<u>Sect</u>	<u>Sur Typ</u>	<u>Sur Num</u>	<u>Suff</u>	<u>Subdivision</u>	<u>Act Pend</u>
286211	AUTHORIZED	14	0100N	0020E	033	ALIQ		SWSW;	

Serial Number: AZA 028093

Total Case Acres: 1.000

<u>Casetype</u>	<u>Case Disp</u>			<u>Sect</u>	<u>Sur Typ</u>	<u>Sur Num</u>	<u>Suff</u>	<u>Subdivision</u>	<u>Act Pend</u>
380913	EXPIRED	14	0100N	0020E	033	FF	1	PORTION OF;	

UNITED STATES DEPARTMENT OF INTERIOR
 BUREAU OF LAND MANAGEMENT
 GEOGRAPHIC REPORT WITH LAND
 Sorted by Serial Number

Adm State: AZ

Serial Number: AZA 028098
 Total Case Acres: 0.600

<u>Casetype</u>	<u>Case Disp</u>			<u>Sect</u>	<u>Sur Typ</u>	<u>Sur Num</u>	<u>Suff</u>	<u>Subdivision</u>	<u>Act Pend</u>
285003	AUTHORIZED	14	0100N	0020E	033	ALIQ		S2SW;	

Serial Number: AZA 031558
 Total Case Acres: 1.000

<u>Casetype</u>	<u>Case Disp</u>			<u>Sect</u>	<u>Sur Typ</u>	<u>Sur Num</u>	<u>Suff</u>	<u>Subdivision</u>	<u>Act Pend</u>
837000	PENDING	14	0100N	0020E	033	FF		PORTIONS OF;	

Serial Number: AZA 031730
 Total Case Acres: 1.000

<u>Casetype</u>	<u>Case Disp</u>			<u>Sect</u>	<u>Sur Typ</u>	<u>Sur Num</u>	<u>Suff</u>	<u>Subdivision</u>	<u>Act Pend</u>
837000	EXPIRED	14	0100N	0020E	033	FF		PORTION OF;	

Serial Number: AZA 031851
 Total Case Acres: 1.000

<u>Casetype</u>	<u>Case Disp</u>			<u>Sect</u>	<u>Sur Typ</u>	<u>Sur Num</u>	<u>Suff</u>	<u>Subdivision</u>	<u>Act Pend</u>
837000	PENDING	14	0100N	0020E	033	FF		PORTION OF;	

Serial Number: AZA 033350
 Total Case Acres: 640.050

<u>Casetype</u>	<u>Case Disp</u>			<u>Sect</u>	<u>Sur Typ</u>	<u>Sur Num</u>	<u>Suff</u>	<u>Subdivision</u>	<u>Act Pend</u>
288100	AUTHORIZED	14	0100N	0020E	033	FF		NE,(EXCLUDE PAT 1031935); UPATENTED LAND IN SE;	

UNITED STATES DEPARTMENT OF INTERIOR
 BUREAU OF LAND MANAGEMENT
 GEOGRAPHIC REPORT WITH LAND
 Sorted by Serial Number

Adm State: AZ

Serial Number: AZA 03335001

Total Case Acres: 2.450

<u>Casetype</u>	<u>Case Disp</u>				<u>Sect</u>	<u>Sur Typ</u>	<u>Sur Num</u>	<u>Suff</u>	<u>Subdivision</u>	<u>Act Pend</u>
280004	AUTHORIZED	14	0100N	0020E	033	ALIQ			NESE;	

Serial Number: AZA 03335004

Total Case Acres: 928.320

<u>Casetype</u>	<u>Case Disp</u>				<u>Sect</u>	<u>Sur Typ</u>	<u>Sur Num</u>	<u>Suff</u>	<u>Subdivision</u>	<u>Act Pend</u>
280004	AUTHORIZED	14	0100N	0020E	033	FF			NE,(EXCLUDE PAT 1031935); UPATENTED LAND IN SE;	

Serial Number: AZA 03335005

Total Case Acres: 305.460

<u>Casetype</u>	<u>Case Disp</u>				<u>Sect</u>	<u>Sur Typ</u>	<u>Sur Num</u>	<u>Suff</u>	<u>Subdivision</u>	<u>Act Pend</u>
280004	AUTHORIZED	14	0100N	0020E	033	ALIQ			NENE;	

Serial Number: AZA 033433

Total Case Acres: 1.000

<u>Casetype</u>	<u>Case Disp</u>				<u>Sect</u>	<u>Sur Typ</u>	<u>Sur Num</u>	<u>Suff</u>	<u>Subdivision</u>	<u>Act Pend</u>
837000	EXPIRED	14	0100N	0020E	033	FF			PORTION OF;	

Serial Number: AZA 033482

Total Case Acres: 1.000

<u>Casetype</u>	<u>Case Disp</u>				<u>Sect</u>	<u>Sur Typ</u>	<u>Sur Num</u>	<u>Suff</u>	<u>Subdivision</u>	<u>Act Pend</u>
837000	EXPIRED	14	0100N	0020E	033	FF			PORTION OF;	

RUN TIME: 12:17 PM

UNITED STATES DEPARTMENT OF INTERIOR
BUREAU OF LAND MANAGEMENT
GEOGRAPHIC REPORT WITH LAND
Sorted by Serial Number

RUN DATE: 03/18/2008

Page 4 of 4

Adm State: AZ

Serial Number: AZA 033672

Total Case Acres: 1.000

<u>Casetype</u>	<u>Case Disp</u>				<u>Sect</u>	<u>Sur Typ</u>	<u>Sur Num</u>	<u>Suff</u>	<u>Subdivision</u>	<u>Act Pend</u>
837000	AUTHORIZED	14	0100N	0020E	033	FF			PORTION OF;	

Serial Number: AZA 033821

Total Case Acres: 1.000

<u>Casetype</u>	<u>Case Disp</u>				<u>Sect</u>	<u>Sur Typ</u>	<u>Sur Num</u>	<u>Suff</u>	<u>Subdivision</u>	<u>Act Pend</u>
837000	AUTHORIZED	14	0100N	0020E	033	FF			PORTION OF;	

Serial Number: AZAR 0011384

Total Case Acres: 1.295

<u>Casetype</u>	<u>Case Disp</u>				<u>Sect</u>	<u>Sur Typ</u>	<u>Sur Num</u>	<u>Suff</u>	<u>Subdivision</u>	<u>Act Pend</u>
286202	AUTHORIZED	14	0100N	0020E	033	ALIQ			SWNW;	

LOCATION NOTICE FOR LODE MINING CLAIM

NOTICE IS HEREBY GIVEN that the DEBORAH SOE Mine
_____ lode mining claim has been located
by Franklin Burns whose current mailing
address is 5828 N. Scottsdale Rd
Scottsdale, AZ 85253

BLM
Date
Stamp
2001 OCT 23 P 12:30 PM
PHOENIX, AZ
RECEIVED
B.L.M. AZ STATE OFFICE

The general course of this claim is North west to South East and it is situated in Twp 10 N
County, Arizona. This claim is 1500 feet in length and 600 feet in width. This claim runs
from the location monument on which this location notice is posted approximately 900 feet in a
North west direction to the North end line and 600 feet in a South East direction to the
South end line. This claim is marked by six monuments, one at each corner and one at the center of each
end line of the claim.

The location monument on which this notice is posted is situated within Section 33, Township 10
N, Range 2 E, Gila Salt River Base and Meridian, Arizona and this claim encompasses portions
of the following quarter section (s), section (s), Township (s) and Range (s) _____
NW, NE, SEC 33, 10 N, 2 E

Gila Salt River Base and Meridian, Arizona.

The locality of this claim with reference to some natural object or permanent monument and additional information
(if any) concerning its locality are as follows: West Corner Post is 2700 feet
South East of USGS Quarter Corner Marker
Sect(s) 28, 29, 32, 33

DATED AND POSTED on the ground this 3 day of October, 2007

LOCATOR (s) Franklin Burns

Form MCF100
Revised July 2005

AMC 386581

USGS Quarter
Corner Marker
Sections 28, 29, 32, 33

MINING CLAIM MAP

Lode () Placer ()

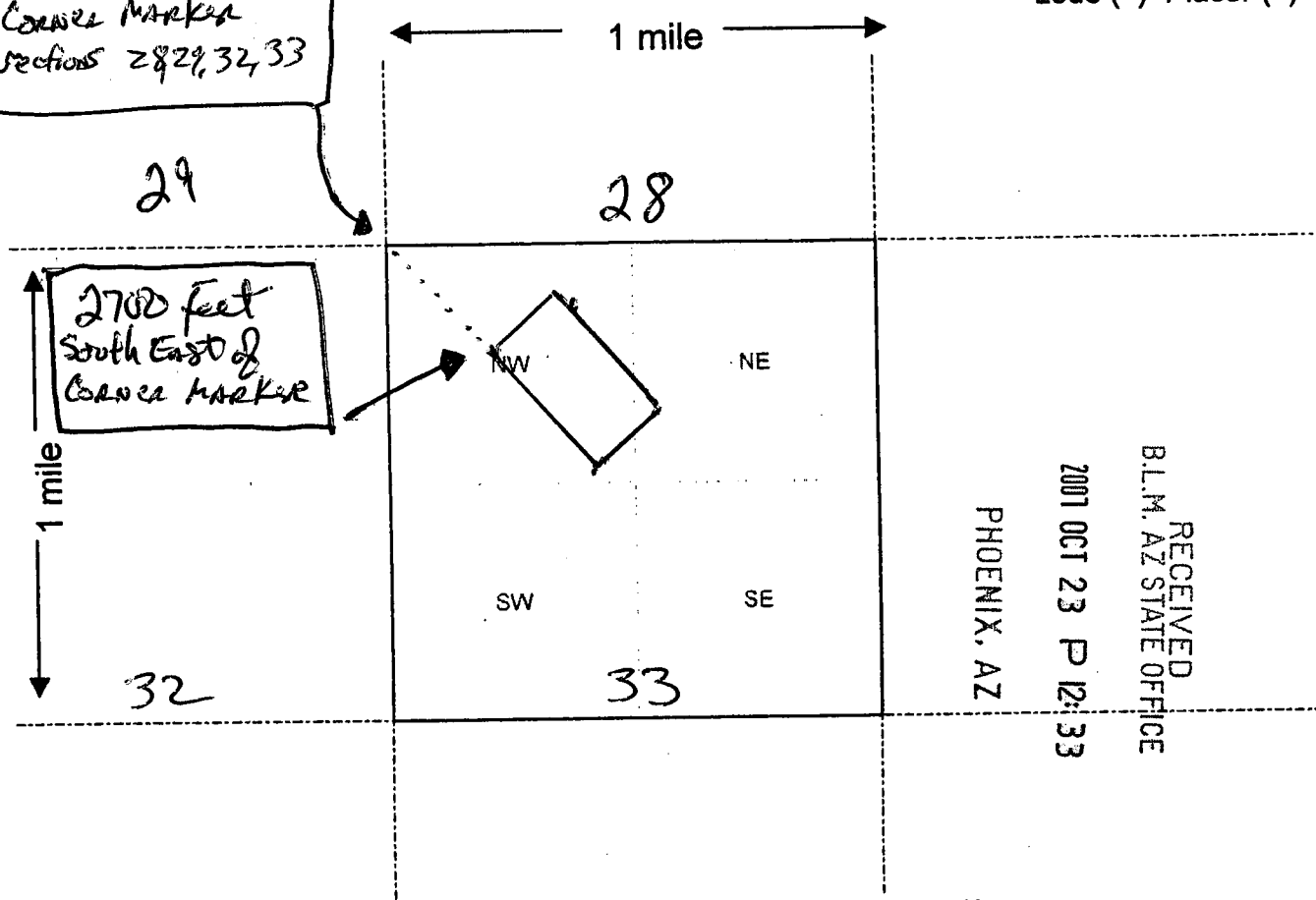

Scale: 1" = 2000 feet

1. The above map depicts the DEBORAH SUE MINE mining claim, which is located in Section (s) 33, Township 10 N, Range 2 E, Gila and Salt River Base and Meridian, YAVAPAI County, Arizona.

2. The type of corner and location monuments used are as follows: wood & stone

3. The bearings and distances in degrees and feet between claim corners are as depicted on the map.

Form MCF100a
Revised July 2005

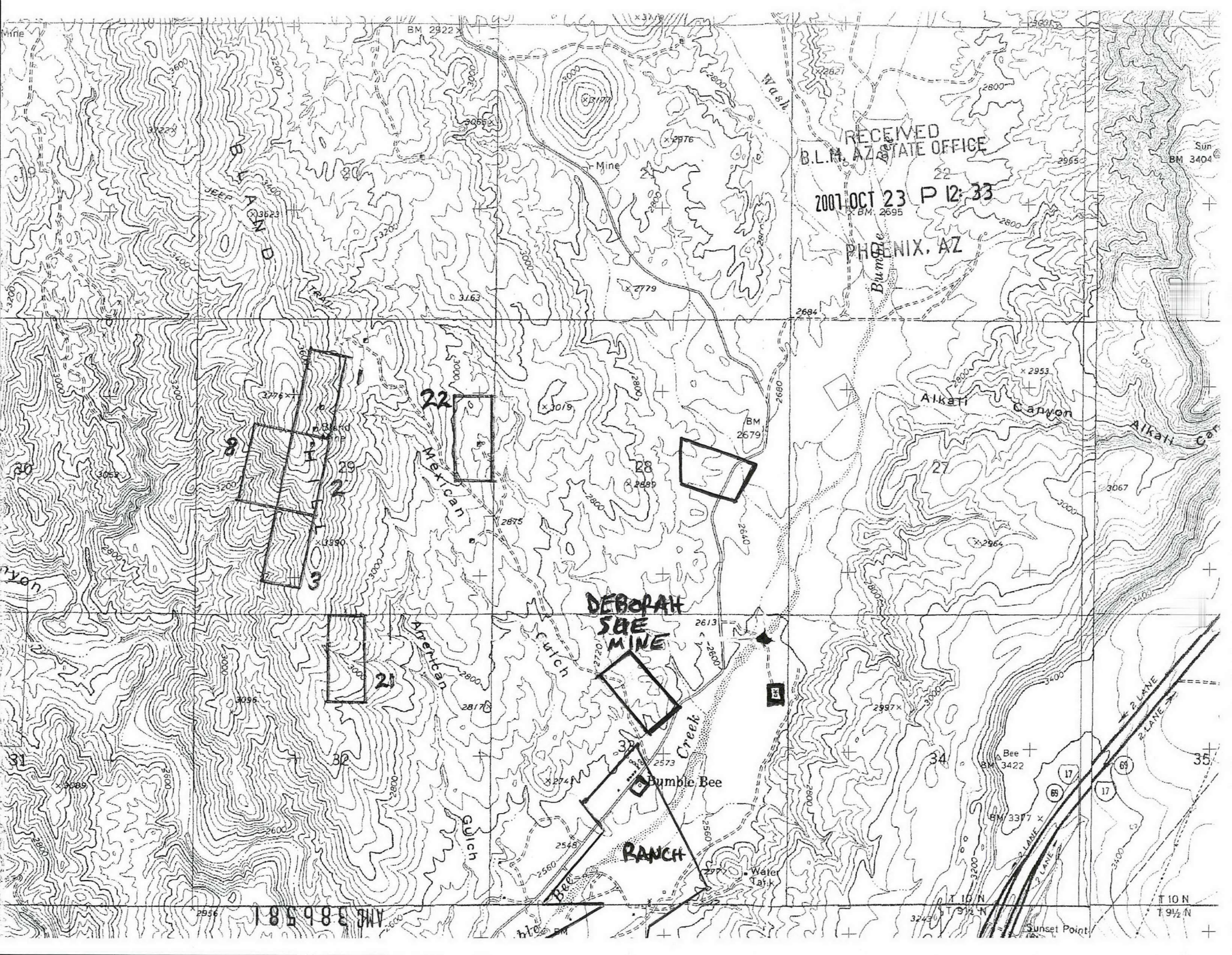

RECEIVED
B.L.M. AZ STATE OFFICE

2001 OCT 23 P 12:33

PHOENIX, AZ

JEFF
LAND

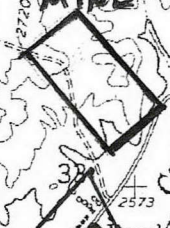
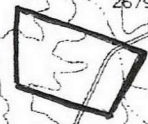
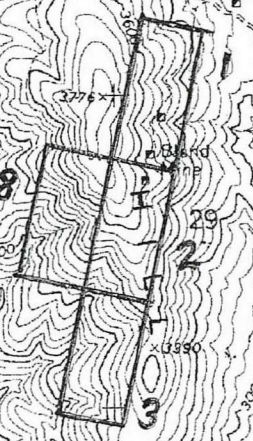

DEBORAH
SBE
MINE

Bumble Bee
RANCH

BM

Bee
BM 3422

BM 3377

Sun
BM 3404

T 10 N
T 9 1/2 N

AMC 386981

Sunset Point

17

68

68

35

34

32

31

29

28

27

22

8

7

6

5

4

3

2

1

0

1

2

3

4

5

6

7

8

9

10

11

12

13

14

15

16

17

18

19

20

21

22

23

24

25

26

27

28

29

30

31

32

33

34

35

36

37

38

39

40

41

42

43

44

45

46

47

48

49

50

51

52

53

54

55

56

57

58

59

60

61

62

63

64

65

66

67

68

69

70

71

72

73

74

75

76

77

78

79

80

81

82

83

84

85

86

87

88

89

90

91

92

93

94

95

96

97

98

99

100

101

102

103

104

105

106

107

108

109

110

111

112

113

114

115

116

117

118

119

120

121

122

123

124

125

126

127

128

129

130

131

132

133

134

135

136

137

138

139

140

141

142

143

144

145

146

147

148

149

150

151

152

153

154

155

156

157

158

159

160

161

162

163

164

165

166

167

168

169

170

171

172

173

174

175

176

177

178

179

180

181

182

183

184

185

186

187

188

189

190

191

192

193

194

195

196

197

198

199

200

201

202

203

204

205

206

207

208

209

210

211

212

213

214

215

216

217

218

219

220

221

222

223

224

225

226

227

228

229

230

231

232

233

234

235

236

237

238

239

240

241

242

243

244

245

246

247

248

249

250

251

252

253

254

255

256

257

258

259

260

261

262

263

264

265

266

267

268

269

270

271

272

273

274

275

276

277

278

279

280

281

282

283

284

285

286

287

288

289

290

291

292

293

TOWNSHIP 10 NORTH RANGE 02 EAST OF THE GILA & SALT RIVER MERIDIAN, ARIZONA

SECS	SUBDIVISION																Acres	Kind of Entry or Purpose	Serial Number or Order Number	Action Date	Remarks		
	NE 1/4				NW 1/4				SW 1/4				SE 1/4									Lots	Other Description
	NE	NW	SW	SE	NE	NW	SW	SE	NE	NW	SW	SE	NE	NW	SW	SE							
For orders affecting disposal or use of unidentified lands withdrawn for classification, minerals, water, and/or other public purposes, and Indian treaties, refer to Index to Miscellaneous Documents																							
6																	PART 4, 5, 7	PART W2SEW;		R/W PUBLIC ROADWAY	AZA-23341	5/31/1988	STATE ISSUED 10/22/1987; PERPETUAL; REL AND CASE CLOSED 8/3/2004;
8					X	X	X	X	X	X	X	X											
14											X							W2SESW;					
16										X	X												
21	X	X	X	X																			
22																		ALL;					
23						X	X			X	X							W2E2W2;					
26					X	X	X	X	X	X	X												
27																		ALL EXCEPT M&B;					
28																		E2, E2W2 EXCEPT M&B;					
33																		E2, E2W2 EXCEPT M&B;					
34																		ALL EXCEPT M&B;	WD RECON TO US	A-22792-B	12/16/1988	LD TP: 9N 1E;	
5						X				X				X			2						
17			X		X			X					X	X	X	X							
20	X																	LD TP: 12N 1E;	R/W TELEPHONE AND TELEGRAPH LINE AMENDED	AZA-22632	1/6/1989	TO TERM 7/15/2017;	
1				X		X	X	X	X	X	X	X	X	X			1-7						
2			X	X		X	X	X	X	X	X	X	X	X	X	X	1-4						
3			X	X		X	X	X	X	X	X	X	X	X	X	X	1-4						
4			X	X		X	X	X	X	X	X	X	X	X	X	X	1-4						
9																		ALL;					
10																		ALL;					
11																		ALL;					
14	X	X	X	X	X	X	X	X	X	X								E2SESW;					
15	X	X	X	X	X	X	X	X															
16	X	X	X	X	X	X	X	X															
17	X	X	X	X									X	X	X	X							
23	X	X	X	X									X	X	X	X		E2E2W2;					
26	X	X	X	X									X	X	X	X							
33						X	X			X													
35					X	X	X	X	X	X	X	X						LD TP: 1N 151/2E;	NORA	AZA-20346-U	3/22/1989	SEGREGATES THE LANDS FROM APPROPRIATION UNDER THE PUBLIC LAND LAWS AND THE MINING LAWS, BUT NOT THE MINERAL LEASING LAWS OR GEOTHERMAL STEAM ACT; SEG TO TERM 3/21/1991;	

